



U Value

Insulation & Drywall

Suppliers of Insulation & Associated Building Materials

PRICE GUIDE

U Value Insulation Ltd.

Unit 505B Northwest Business Park, Mitchelstown Road, Ballycoolin, Dublin 15.

Tel: (01) 861 2000 Fax: (01) 861 222 E-mail sales@uvalue.ie

www.uvalue.ie

INDEX

| PAGE | PRODUCTS |
|----------------------|--|
| 4,5,6,7 | Thermal laminates: (Insulated plasterboards) U Value Insulation Warmline Insulated Plasterboards: Polyiso (PIR) Foam - Phenolic Foam - EPS Foam |
| 8 | Extruded Polystyrene XPS (High density roof,wall & floor insulation) Fibran Extruded Polystyrene: 300L High Density Insulation - Inverted Roofs - Basements and Floors |
| 9,10,11 | Isover Insulation (Glasswool/fibreglass insulation) G3 Loft Roll 44 - Metac Roll 34 - Acoustic Roll - Calibel Boards - Optima Wall Lining System |
| 12,13,14,15,16 | Knauf Insulation (Glasswool/fibreglass insulation) Earthwool Loft Roll 44 - OmniFit Slabs - OmniFit Stud Roll 34 - RS Stonewool Building slabs |
| 17 | Superglass Insulation (Glasswool/fibreglass insulation) High Performance (HP) Timber roll 34 - Acoustic Roll - Cladding Roll 40 |
| 18,19,20,21,22,23,24 | ROCKWOOL Insulation (Rockwool insulation) Flexi Slabs - High Density Slabs - Fire Barriers - Roof Boards - Rainscreen Insulation - Rockwool Rolls |
| 25,26 | Actis Insulation (Reflective insulation) Actis Reflective Insulation: Hybris Insulation - HControl - Boost R - Trilso Super 10 - Tri Iso Sols |
| 27 | Reflective Insulation (Reflective insulation) SuperQuilt - Comfort Roll - AluThermo - Single Bubble Foil - Double Bubble Foil |
| 28 | Breathable Roof and Wall Membranes (Vapour open membranes) Proctor Roof Shield - DuPont Tyvek Supro - Blizzard Plus |
| 29,30,31,32 | Airtight Membranes - Tapes & Sealants (Vapour control membranes) DAFA - INTELLO - VARIO - AMPACK |
| 33,34,35,36 | Quinnterm Insulation (Rigid PIR insulation boards) Polyisocyanurate Foam (PIR) Insulation: Pitch Roof - Flat Roof - Cavity Wall - Ground Floor |

For Trade Discounts Please Call ROI 01-8612000 NI 00353-1-8612000

INDEX

| PAGE | PRODUCTS |
|-------------------|--|
| 37,38 | Kingspan (Rigid PIR foam insulation boards) Polyisocyanurate Foam (PIR) Insulation - Pitch Roof, Floor and Flat Roof Insulation |
| 39,40,41,42,43 | Kingspan (Rigid Phenolic foam insulation boards) Kingspan Kooltherm Phenolic Foam Insulation: K3 - K5 - K7 - K8 - K10 - K12 - K15 - K16 - K17 - K18 |
| 44,45 | Resistant Building Products (Multy purpose building boards) Resistant Building Products: FireSafe Building Boards - Render Boards - Tile Backer Boards |
| 46,47,48,49 | Plasterboards Plain - Foil - Sound - Fire - Moisture Aquapanel - Tile Backer Glassroc H - Fermacell Boards |
| 50,51,52,53,54 | Metal Stud & Track Metal Stud and Track - MF Ceiling Systems - Wall Linings and Fixings |
| 55,56,57,58,59,60 | Drywall Accessories Skim Coat - Scrim Tape - Corner Bead - Edge Beads - Coving - Joint Filler - Bonding Compound |
| 61,62,63 | Associated Building Materials and Insulation Accessories Therma Walk - Aerogel - Pipe Lagging - Insulation Hoods |
| 64 | Timber Sheeting Timber Sheeting and Timber Battens |
| 65 | Foams & Sealants Foams and Sealants |
| 66,67 | EWI External Wall Insulation Airpacks Expanded Polystyrene Floor and Wall Insulation |
| 68,69 | Knauf Brio Dry Fix Flooring Systems |

For Trade Discounts Please Call ROI 01-8612000 NI 00353-1-8612000

Our Industry Partners



System Solutions

For Trade Discounts Please Call ROI 01-8612000 NI 00353-1-8612000

For Thermal, Acoustic and Fire Safe Insulation Advice - Talk To The Insulation Experts

U Value Insulation & Drywall - WARMLINE PIR Insulated plasterboards

Dot and Dab + 3 metal fixings

Product

Polyisocyanurate foam PIR Insulation bonded to 12.5mm Plasterboard

| Thickness mm | Length mtr | Width mtr | Board Edge | m2 Per sheet |
|-----------------|---------------|--------------|---------------|-----------------|
| 32.5 | 2.438 | 1.200 | Tapered | 2.92 |
| 37.5 | 2.438 | 1.200 | Tapered | 2.92 |
| 50.5 | 2.438 | 1.200 | Tapered | 2.92 |
| 62.5 | 2.438 | 1.200 | Tapered | 2.92 |
| 72.5 | 2.438 | 1.200 | Tapered | 2.92 |
| 82.5 | 2.438 | 1.200 | Tapered | 2.92 |
| 92.5 | 2.438 | 1.200 | Tapered | 2.92 |

| List price m2 € | List price per sheet € |
|--------------------|---------------------------|
| 10.27 | 30.00 |
| 10.04 | 29.33 |
| 11.23 | 32.79 |
| 12.48 | 36.45 |
| 14.38 | 42.00 |
| 16.21 | 47.33 |
| 17.88 | 52.20 |

Product

Polyisocyanurate foam PIR Insulation bonded to 9.5mm Plasterboard

| Thickness mm | Length mtr | Width mtr | Board Edge | m2 Per sheet |
|-----------------|---------------|--------------|---------------|-----------------|
| 29.5 | 2.438 | 1.200 | Tapered | 2.92 |

| List price m2 € | List price per sheet € |
|--------------------|---------------------------|
| 10.21 | 29.80 |

Other sizes available to order

Accessories

| |
|-------------------------------|
| Timber Battens |
| Nylon Mushroom Fixings |
| Metal mushroom fixings & Caps |
| Drywall Screws |
| Scrim Tape |
| Paper Tape |
| Corner beads |
| Joint Filler |
| Skim Coat Plaster |
| Bonding compound |

Accessories

| |
|--------------------------|
| Foam filler (Tin) |
| Fix All foam (Tin) |
| Airtight plaster |
| Airtight Membranes |
| Vapour barrier |
| Airtight Tapes |
| Airtight Sealants |
| Plain Plasterboards |
| Moisture Plasterboards |
| Fire Check Plasterboards |



For Trade Discounts Please Call ROI 01-8612000 NI 00353-1-8612000

For Thermal, Acoustic and Fire Safe Insulation Advice - Talk To The Insulation Experts

U Value Insulation & Drywall - WARMLINE PIR Insulated Plasterboards *(Mechanically fixed - Foil faced boards)*

15/16 Fixings per board

Product

Polyisocyanurate foam PIR Insulation bonded to 12.5mm Plasterboard

| Thickness mm | Length mtr | Width mtr | Board Edge | m2 Per sheet |
|-----------------|---------------|--------------|---------------|-----------------|
| 37.5 | 2.400 | 1.200 | Tapered | 2.88 |
| 42.5 | 2.400 | 1.200 | Tapered | 2.88 |
| 50.5 | 2.400 | 1.200 | Tapered | 2.88 |
| 62.5 | 2.400 | 1.200 | Tapered | 2.88 |
| 72.5 | 2.400 | 1.200 | Tapered | 2.88 |
| 82.5 | 2.400 | 1.200 | Tapered | 2.88 |
| 92.5 | 2.400 | 1.200 | Tapered | 2.88 |
| 102.5 | 2.400 | 1.200 | Tapered | 2.88 |
| 112.5 | 2.400 | 1.200 | Tapered | 2.88 |

| List price m2 € | List price per sheet € |
|--------------------|---------------------------|
| 11.15 | 32.10 |
| 11.49 | 33.10 |
| 12.29 | 35.40 |
| 12.99 | 37.40 |
| 15.21 | 43.80 |
| 17.01 | 49.00 |
| 19.44 | 56.00 |
| 20.49 | 59.00 |
| 21.18 | 61.00 |

Product

Polyisocyanurate foam PIR Insulation bonded to 9.5mm Plasterboard

| Thickness mm | Length mtr | Width mtr | Board Edge | m2 Per sheet |
|-----------------|---------------|--------------|---------------|-----------------|
| 22.5 | 2.400 | 1.200 | Tapered | 2.88 |

| List price m2 € | List price per sheet € |
|--------------------|---------------------------|
| 10.35 | 29.80 |

Other sizes available to order

| Accessories |
|-------------------------------|
| Timber Battens |
| Nylon Mushroom Fixings |
| Metal mushroom fixings & Caps |
| Drywall Screws |
| Scrim Tape |
| Paper Tape |
| Corner beads |
| Joint Filler |
| Skim Coat Plaster |
| Bonding compound |

| Accessories |
|--------------------------|
| Foam filler (Tin) |
| Fix All foam (Tin) |
| Airtight plaster |
| Airtight Membranes |
| Vapour barrier |
| Airtight Tapes |
| Airtight Sealants |
| Plain Plasterboards |
| Moisture Plasterboards |
| Fire Check Plasterboards |



For Trade Discounts Please Call ROI 01-8612000 NI 00353-1-8612000

For Thermal, Acoustic and Fire Safe Insulation Advice - Talk To The Insulation Experts

U Value Insulation & Drywall - *WARMLINE* EPS Expanded Polystyrene Insulated plasterboards

Product

Polystyrene foam (white) insulation bonded to 9.5mm Plasterboard

| Thickness mm | Length mtr | Width mtr | Board Edge | m2 Per sheet |
|-----------------|---------------|--------------|---------------|-----------------|
| 22.5 | 2.438 | 1.200 | Tapered | 2.93 |

Other sizes available to order

| List price m2 € |
|--------------------|
| 6.07 |

| List price per sheet € |
|---------------------------|
| 17.75 |

6.07

17.75

REVEAL BOARDS

White expanded polystyrene bonded to plasterboard

| Accessories |
|------------------------|
| Timber Battens |
| Nylon Mushroom Fixings |
| Metal mushroom fixings |
| Drywall Screws |
| Scrim Tape |
| Paper Tape |
| Corner beads |
| Joint Filler |
| Skim Coat Plaster |
| Bonding compound |

| Accessories |
|--------------------------|
| Foam filler (Tin) |
| Fix All foam (Tin) |
| Airtight plaster |
| Airtight Membranes |
| Vapour barrier |
| Airtight Tapes |
| Airtight Sealants |
| Plain Plasterboards |
| Moisture Plasterboards |
| Fire Check Plasterboards |



For Trade Discounts Please Call ROI 01-8612000 NI 00353-1-8612000

For Thermal, Acoustic and Fire Safe Insulation Advice - Talk To The Insulation Experts

U Value Insulation & Drywall - *WARMLINE* Expanded Polystyrene (*Grey*) Insulated plasterboards

Product **Polystyrene foam (*Grey*) insulation bonded to 12.5mm Plasterboard**

| Thickness mm | Length mtr | Width mtr | Board Edge | m2 Per sheet |
|-----------------|---------------|--------------|---------------|-----------------|
| 29.5 | 2.438 | 1.200 | Tapered | 2.92 |
| 37.5 | 2.438 | 1.200 | Tapered | 2.92 |
| 52.5 | 2.438 | 1.200 | Tapered | 2.92 |
| 62.5 | 2.438 | 1.200 | Tapered | 2.92 |
| 72.5 | 2.438 | 1.200 | Tapered | 2.92 |
| 82.5 | 2.438 | 1.200 | Tapered | 2.92 |
| 92.5 | 2.438 | 1.200 | Tapered | 2.92 |
| 102.5 | 2.438 | 1.200 | Tapered | 2.92 |
| 112.5 | 2.438 | 1.200 | Tapered | 2.92 |

| List price m2 € | List price per sheet € |
|--------------------|---------------------------|
| 6.44 | 18.80 |
| 7.45 | 21.75 |
| 9.39 | 27.42 |
| 10.64 | 31.07 |
| 11.93 | 34.84 |
| 13.32 | 38.89 |
| 14.52 | 42.40 |
| 16.42 | 47.95 |
| 17.11 | 49.96 |

Other sizes available to order

Grey expanded polystyrene bonded to plasterboard

| Accessories |
|------------------------|
| Timber Battens |
| Nylon Mushroom Fixings |
| Metal mushroom fixings |
| Drywall Screws |
| Scrim Tape |
| Paper Tape |
| Corner beads |
| Joint Filler |
| Skim Coat Plaster |
| Bonding compound |

| Accessories |
|--------------------------|
| Foam filler (Tin) |
| Fix All foam (Tin) |
| Airtight plaster |
| Airtight Membranes |
| Vapour barrier |
| Airtight Tapes |
| Airtight Sealants |
| Plain Plasterboards |
| Moisture Plasterboards |
| Fire Check Plasterboards |



For Trade Discounts Please Call ROI 01-8612000 NI 00353-1-8612000

For Thermal, Acoustic and Fire Safe Insulation Advice - Talk To The Insulation Experts

FIBRAN - High Density Extruded Polystyrene XPS

Product **300 KPA High Density FLOOR, WALL, BASEMENT WALL and INVERTED ROOF Insulation**

| Thickness mm | Length mtr | Width mtr | Board Edge | Pieces Per pack | m2 Per pack |
|-----------------|---------------|--------------|---------------|--------------------|----------------|
| 30 | 1.250 | 0.600 | Shiplap | 14 | 10.50 |
| 40 | 1.250 | 0.600 | Shiplap | 10 | 7.50 |
| 50 | 1.250 | 0.600 | Shiplap | 8 | 6.00 |
| 60 | 1.250 | 0.600 | Shiplap | 7 | 5.25 |
| 70 | 1.250 | 0.600 | Shiplap | 6 | 4.50 |
| 80 | 1.250 | 0.600 | Shiplap | 5 | 3.75 |
| 90 | 1.250 | 0.600 | Shiplap | 5 | 3.75 |
| 100 | 1.250 | 0.600 | Shiplap | 4 | 3.00 |
| 120 | 1.250 | 0.600 | Shiplap | 3 | 2.25 |

| List price m2 € | List price pack € |
|--------------------|----------------------|
| 7.50 | 78.75 |
| 10.00 | 75.00 |
| 12.50 | 75.00 |
| 15.00 | 78.75 |
| 17.50 | 78.75 |
| 20.00 | 75.00 |
| 22.50 | 84.38 |
| 25.00 | 75.00 |
| 30.00 | 67.50 |

Also available in 400L, 500L and 700L

| List price m2 € | List price pack € |
|--------------------|----------------------|
| POA | POA |

Styroline Fleeceline Geotextile

| Thickness mm | Length mtr | Width mtr | m2 Per roll |
|-----------------|---------------|--------------|----------------|
| 0.5 | 50 | 1.500 | 75 |

Separation layer applied between the watertight layer and the insulation layer

| List price per roll € |
|--------------------------|
| 210.00 |

Styroline Aqualine:

| Thickness mm | Length mtr | Width mtr | m2 Per roll |
|-----------------|---------------|--------------|----------------|
| 0.5 | 50 | 1.500 | 75 |

Anticooling membrane applied over the insulation layer below the paving slabs or stone ballast

| List price per roll € |
|--------------------------|
| 210.00 |

For Trade Discounts Please Call ROI 01-8612000 NI 00353-1-8612000

ISOVER G3 - Glasswool Insulation

Product Isover G3 Spacesaver Loft Roll 44

Suitable for attic insulation

| | Thickness mm | Lambda value w/mK | Thermal Resistance | Width mtr | Length mtr | m2 Per roll |
|------------|-----------------|----------------------|-----------------------|--------------|---------------|----------------|
| Solid roll | 50 | 0.044 | 1.136 | 1.200 | 18.00 | 21.60 |
| Solid roll | 70 | 0.044 | 1.590 | 1.200 | 15.50 | 18.60 |
| Combi-Cut | 100 | 0.044 | 2.250 | 1.160 | 9.170 | 10.64 |
| Combi-Cut | 150 | 0.044 | 3.409 | 1.160 | 6.038 | 7.00 |
| Combi-Cut | 200 | 0.044 | 4.500 | 1.160 | 3.880 | 4.50 |

| List price m2 € |
|--------------------|
|--------------------|

| List price per roll € |
|--------------------------|
|--------------------------|

| |
|------|
| 1.85 |
|------|

| |
|-------|
| 39.96 |
|-------|

| |
|------|
| 2.62 |
|------|

| |
|-------|
| 48.73 |
|-------|

| |
|------|
| 2.13 |
|------|

| |
|-------|
| 22.66 |
|-------|

| |
|------|
| 3.06 |
|------|

| |
|-------|
| 21.43 |
|-------|

| |
|------|
| 4.15 |
|------|

| |
|-------|
| 18.68 |
|-------|

Product Isover G3 Metac Roll 34

Suitable for roof rafters, timberframe walls, dwarf walls, stud partitions, ceilings and floor joist.

| | Thickness mm | Lambda value w/mK | Thermal Resistance | Width mtr | Length mtr | m2 Per roll |
|------------|-----------------|----------------------|-----------------------|--------------|---------------|----------------|
| Solid roll | 50 | 0.034 | 1.47 | 1.200 | 12.00 | 14.40 |
| Solid roll | 100 | 0.034 | 2.94 | 1.200 | 6.500 | 8.40 |
| Solid roll | 150 | 0.034 | 5.25 | 1.200 | 4.800 | 5.76 |
| Solid roll | 180 | 0.034 | 4.41 | 1.200 | 4.000 | 4.80 |
| | 220 | 0.034 | 6.47 | 1.200 | 3.300 | 3.96 |

| List price m2 € |
|--------------------|
|--------------------|

| List price per roll € |
|--------------------------|
|--------------------------|

| |
|------|
| 7.40 |
|------|

| |
|--------|
| 106.56 |
|--------|

| |
|------|
| 9.29 |
|------|

| |
|-------|
| 78.04 |
|-------|

| |
|-------|
| 13.81 |
|-------|

| |
|-------|
| 79.55 |
|-------|

| |
|-------|
| 16.67 |
|-------|

| |
|-------|
| 80.02 |
|-------|

| |
|-------|
| 20.00 |
|-------|

| |
|-------|
| 79.20 |
|-------|

Product Isover G3 Metac Roll 34 Factory Cut 3 x 400mm

Suitable for roof rafters, timberframe walls, dwarf walls, stud partitions, ceilings and floor joist.

| | Thickness mm | Lambda value w/mK | Thermal Resistance | Width mtr | Length mtr | m2 Per roll |
|----------|-----------------|----------------------|-----------------------|--------------|---------------|----------------|
| Cut roll | 150 | 0.034 | 5.25 | 3 x 0.400 | 4.800 | 5.76 |
| Cut roll | 180 | 0.034 | 4.41 | 3 x 0.400 | 4.000 | 4.80 |

| List price m2 € |
|--------------------|
|--------------------|

| List price per roll € |
|--------------------------|
|--------------------------|

| |
|-------|
| 13.81 |
|-------|

| |
|-------|
| 79.55 |
|-------|

| |
|-------|
| 16.67 |
|-------|

| |
|-------|
| 80.02 |
|-------|

Pre cut rolls to suit 400mm centres



Glasswool - Mineral wool A1 Non combustable insulation materials

For Trade Discounts Please Call ROI 01-8612000 NI 00353-1-8612000

For Thermal, Acoustic and Fire Safe Insulation Advice - Talk To The Insulation Experts

ISOVER G3 - Glasswool Insulation

Product **Isover 18kg Density Acoustic Roll**

Suitable for timberframe and metal frame stud partitions, ceilings and floor joist.

| | Thickness mm | Lambda value w/mK | Thermal Resistance | Width mtr | Length mtr | m2 Per roll |
|------------|-----------------|----------------------|-----------------------|--------------|---------------|----------------|
| Solid roll | 25 | 0.036 | 0.69 | 1.200 | 20.00 | 24.00 |
| Solid roll | 50 | 0.036 | 1.38 | 1.200 | 12.00 | 14.40 |
| Solid roll | 70 | 0.036 | 1.94 | 1.200 | 9.000 | 10.80 |
| Combi roll | 100 | 0.036 | 2.77 | 1.160 | 6.500 | 7.54 |
| Combi roll | 150 | 0.036 | 4.16 | 1.160 | 4.500 | 5.22 |
| Combi roll | 200 | 0.036 | 5.55 | 1.160 | 2.700 | 3.13 |

| List price m2 € | List price per roll € |
|--------------------|--------------------------|
| 2.79 | 67.00 |
| 4.28 | 61.66 |
| 6.33 | 68.41 |
| 6.17 | 46.52 |
| 8.46 | 44.16 |
| 17.78 | 55.65 |

Product **Isover Calibel Acoustic Board**

Suitable for masonry party walls

| | Thickness mm | Lambda value w/mK | Thermal Resistance | Width mtr | Length mtr | m2 Per sheet |
|--|-----------------|----------------------|-----------------------|--------------|---------------|-----------------|
| | 42.5 | 0.035 | 0.92 | 1.200 | 2.500 | 3.00 |
| | 62.5 | 0.035 | 1.49 | 1.200 | 2.500 | 3.00 |

| List price m2 € | List price per sheet € |
|--------------------|---------------------------|
| 24.90 | 74.69 |
| 29.72 | 89.15 |

Calibel is an insulation board made up of a thick base of glass mineral wool assuring excellent, thermal and acoustic insulation finished with a plasterboard lining.

| |
|---|
| Airbourne sound |
| When sound travels within air movement |
| Impact sound reduction |
| Isolating impact from foot traffic |
| Flanking sound |
| When sound travels over, under and around stud partitions and through floors at perimeter edges |

| Accessories |
|---------------------------------|
| Isolation batten strips |
| Acoustic mastic |
| Airtight sealants |
| Electrical sockets - Putty pads |
| Stick pins |
| Resilliant bar |



Glasswool - Mineral wool A1 Non combustable insulation materials

For Trade Discounts Please Call ROI 01-8612000 NI 00353-1-8612000

For Thermal, Acoustic and Fire Safe Insulation Advice - Talk To The Insulation Experts

ISOVER Insulation - Optima System

Product **Optima U CHANNEL**

| Length (mtr) | Pieces per box | List price per box € |
|--------------|----------------|----------------------|
| 2.350 | 20 | 87.38 |

Product **Optima C CHANNEL**

| Length mtr | Pieces per box | List price per box € |
|------------|----------------|----------------------|
| 2.400 | 10 | 63.93 |

Product **Optima Extensions**

| Length mtr | Pieces per box | List price per box € |
|------------|----------------|----------------------|
| 0.500 | 10 | 31.43 |
| 0.300 | 10 | 25.42 |

Product **Optima Supports**

| Length mm | Pieces per box | List price per box € |
|-----------|----------------|----------------------|
| 75 | 50 | 139.00 |
| 100 | 50 | 146.00 |
| 120 | 50 | 167.00 |
| 140 | 50 | 178.00 |
| 160 | 40 | 160.00 |

Product **Optima Connector**

| Pieces per box | List price per box € |
|----------------|----------------------|
| 25 | 70.00 |



Wall lining system



For Trade Discounts Please Call ROI 01-8612000 NI 00353-1-8612000

For Thermal, Acoustic and Fire Safe Insulation Advice - Talk To The Insulation Experts

Knauf Glasswool Insulation

Product **Knauf Earthwool Loft Roll 44** **Glasswool - Mineral wool** **A1 Non combustable insulation materials**

Suitable for attic Insulation

| | Thickness | Lambda value | Thermal | Width | Length | m2 | List price m2 | List price per roll |
|-----------|-----------|--------------|------------|-------|--------|----------|---------------|---------------------|
| | mm | w/mK | Resistance | mtr | mtr | Per roll | | |
| Combi-Cut | 100 | 0.044 | 2.25 | 1.140 | 12.18 | 13.89 | 2.13 | 29.59 |
| Combi-Cut | 150 | 0.044 | 3.40 | 1.140 | 8.050 | 9.180 | 3.06 | 28.09 |
| Combi-Cut | 200 | 0.044 | 4.50 | 1.140 | 5.200 | 5.930 | 4.15 | 24.61 |

Combi-Cut Rolls To Suit 400mm and 600mm centres

Product **Knauf Earthwool OmniFit Stud Roll 34**

Suitable for roof rafters, timberframe walls, dwarf walls, stud partitions, ceilings and floor joist.

| | Thickness | Lambda value | Thermal | Width | Length | m2 | List price m2 | List price per roll |
|------------|-----------|--------------|------------|-------|--------|----------|---------------|---------------------|
| | mm | w/mK | Resistance | mtr | mtr | Per roll | | |
| Solid roll | 90 | 0.034 | 2.60 | 1.200 | 5.800 | 6.960 | 7.61 | 53.00 |
| Solid roll | 100 | 0.034 | 2.90 | 1.200 | 5.200 | 6.240 | 8.17 | 51.00 |
| Solid roll | 140 | 0.034 | 4.10 | 1.200 | 4.200 | 5.040 | 11.51 | 58.00 |
| Solid roll | 150 | 0.034 | 4.40 | 1.200 | 3.500 | 4.200 | 11.90 | 50.00 |
| Solid roll | 180 | 0.034 | 5.25 | 1.200 | 3.000 | 3.600 | 13.33 | 48.00 |
| Solid roll | 220 | 0.034 | 6.45 | 1.200 | 2.500 | 3.000 | 16.00 | 48.00 |

Product **Knauf Earthwool OmniFit Roll 40**

Suitable for roof rafters, timberframe walls, dwarf walls, stud partitions, ceilings and floor joist.

| | Thickness | Lambda value | Thermal | Width | Length | m2 | List price m2 | List price per roll |
|-----------|-----------|--------------|------------|-------|--------|----------|---------------|---------------------|
| | mm | w/mK | Resistance | mtr | mtr | Per roll | | |
| Combi-Cut | 100 | 0.040 | 2.50 | 1.200 | 6.800 | 8.160 | 4.10 | 33.46 |
| Combi-Cut | 150 | 0.040 | 3.75 | 1.200 | 4.550 | 5.460 | 6.10 | 33.31 |
| Combi-Cut | 200 | 0.040 | 5.00 | 1.200 | 3.400 | 4.080 | 8.10 | 33.05 |



Insulation Tips

The insulation layer must always fit tightly (snug fit) between timber structures to maintain long term energy efficiency
Rain noise levels may be reduced depending on your choice of insulation materials

For Trade Discounts Please Call ROI 01-8612000 NI 00353-1-8612000

For Thermal, Acoustic and Fire Safe Insulation Advice - Talk To The Insulation Experts

Knauf Insulation - Glasswool Slab and Acoustic Roll

Product Knauf Earthwool OmniFit Slab 35

Thermal, Acoustic, Breathable and Fire Safe Insulation: Suitable for roof rafters, timberframe walls, dwarf walls, stud partitions, ceilings and floor joist.

| Thickness mm | Lambda value w/mK | Thermal Resistance | Width mtr | Length mtr | Pieces Per pack | m2 Per pack | List price m2 € | List price per pack € |
|-----------------|----------------------|-----------------------|--------------|---------------|--------------------|----------------|--------------------|--------------------------|
| 50 | 0.035 | 1.40 | 0.400 | 1.200 | 12 | 5.760 | 6.01 | 34.64 |
| 100 | 0.035 | 2.85 | 0.400 | 1.200 | 6 | 2.880 | 12.03 | 34.64 |
| 140 | 0.035 | 4.00 | 0.400 | 1.200 | 4 | 1.920 | 19.38 | 37.22 |

Product Knauf Earthwool OmniFit Slab 35

Thermal, Acoustic, Breathable and Fire Safe Insulation: Suitable for roof rafters, timberframe walls, dwarf walls, stud partitions, ceilings and floor joist.

| Thickness mm | Lambda value w/mK | Thermal Resistance | Width mtr | Length mtr | Pieces Per pack | m2 Per pack | List price m2 € | List price per pack € |
|-----------------|----------------------|-----------------------|--------------|---------------|--------------------|----------------|--------------------|--------------------------|
| 50 | 0.035 | 1.40 | 0.600 | 1.200 | 12 | 8.640 | 6.01 | 51.93 |
| 60 | 0.035 | 1.70 | 0.600 | 1.200 | 12 | 8.640 | 7.25 | 62.64 |
| 70 | 0.035 | 2.00 | 0.600 | 1.200 | 8 | 5.760 | 8.64 | 49.77 |
| 90 | 0.035 | 2.55 | 0.600 | 1.200 | 6 | 4.320 | 10.87 | 46.96 |
| 100 | 0.035 | 2.85 | 0.600 | 1.200 | 6 | 4.320 | 12.03 | 51.97 |
| 140 | 0.035 | 4.00 | 0.600 | 1.200 | 4 | 2.880 | 19.38 | 55.81 |

Product Knauf Earthwool Acoustic Roll (10kg Density)

Thermal, Acoustic, Breathable and Fire Safe Insulation: Suitable for stud partitions, ceilings and floor joist.

| Thickness mm | Width mtr | Length mtr | Pieces Per roll | m2 Per roll | List price m2 € | List price per roll € |
|-----------------|--------------|---------------|--------------------|----------------|--------------------|--------------------------|
| 25 | 4 x 0.600 | 10.00 | 4 | 24.00 | 2.13 | 51.12 |
| 50 | 2 x 0.600 | 13.00 | 2 | 15.60 | 3.85 | 60.06 |
| 75 | 2 x 0.600 | 12.50 | 2 | 15.00 | 4.53 | 67.95 |
| 100 | 3 x 0.400 | 9.170 | 2 | 11.00 | 5.55 | 61.05 |
| 100 | 2 x 0.600 | 9.170 | 3 | 11.00 | 5.55 | 61.05 |

Density per m3



Acoustic Insulation Tips

Acoustic isolation batten strips reduce impact sound. (Ceiling Joists)
Acoustic sealant reduces flanking sound.

For Trade Discounts Please Call ROI 01-8612000 NI 00353-1-8612000

For Thermal, Acoustic and Fire Safe Insulation Advice - Talk To The Insulation Experts

Knauf Insulation - Flexible Stonewool Slab

Product **Knauf Earthwool Flexible Slab 37**

Thermal, Acoustic, Breathable and Fire Safe Insulation: Suitable for roof rafters, timberframe walls, dwarf walls, stud partitions, ceilings and floor joist.

| Thickness mm | Lambda value w/mK | Thermal Resistance | Width mtr | Length mtr | Pieces Per pack | m2 Per pack | List price m2 € | List price per pack € |
|-----------------|----------------------|-----------------------|--------------|---------------|--------------------|----------------|--------------------|--------------------------|
| 50 | 0.037 | 1.35 | 0.600 | 1.200 | 12 | 8.640 | 5.31 | 45.88 |
| 60 | 0.037 | 1.60 | 0.600 | 1.200 | 10 | 7.200 | 6.51 | 46.87 |
| 70 | 0.037 | 1.85 | 0.600 | 1.200 | 8 | 5.760 | 7.38 | 42.51 |
| 90 | 0.037 | 2.40 | 0.600 | 1.200 | 6 | 4.320 | 9.27 | 40.05 |
| 100 | 0.037 | 2.70 | 0.600 | 1.200 | 6 | 4.320 | 10.54 | 45.53 |

Product **Knauf Earthwool Flexible Slab 37**

Thermal, Acoustic, Breathable and Fire Safe Insulation: Suitable for roof rafters, timberframe walls, dwarf walls, stud partitions, ceilings and floor joist.

| Thickness mm | Lambda value w/mK | Thermal Resistance | Width mtr | Length mtr | Pieces Per pack | m2 Per pack | List price m2 € | List price per pack € |
|-----------------|----------------------|-----------------------|--------------|---------------|--------------------|----------------|--------------------|--------------------------|
| 50 | 0.037 | 1.35 | 0.400 | 1.200 | 12 | 5.760 | 5.31 | 30.59 |
| 60 | 0.037 | 1.60 | 0.400 | 1.200 | 10 | 4.800 | 6.51 | 31.25 |
| 100 | 0.037 | 2.70 | 0.400 | 1.200 | 6 | 2.880 | 10.54 | 30.36 |
| 140 | 0.037 | 3.75 | 0.400 | 1.200 | 4 | 1.920 | 14.80 | 28.42 |

Product **Knauf Earthwool Flexible Slab 35**

Thermal, Acoustic, Breathable and Fire Safe Insulation: Suitable for roof rafters, timberframe walls, dwarf walls, stud partitions, ceilings and floor joist.

| Thickness mm | Lambda value w/mK | Thermal Resistance | Width mtr | Length mtr | Pieces Per pack | m2 Per pack | List price m2 € | List price per pack € |
|-----------------|----------------------|-----------------------|--------------|---------------|--------------------|----------------|--------------------|--------------------------|
| 140 | 0.035 | 4.00 | 0.600 | 1.200 | 3 | 2.160 | 14.80 | 31.97 |

Density per m3



Acoustic building solution tips

The plasterboard layer is the first line of defence
 Two layers of plasterboard is better than one (increased density)
 Sound intrusion is best tackled from source
 Gaps between the insulation layer and the construction layers will reduce acoustic performance

Accessories

Acoustic sealant
 Airtight tapes
 Isolation strips
 Resilliant bar

For Trade Discounts Please Call ROI 01-8612000 NI 00353-1-8612000

For Thermal, Acoustic and Fire Safe Insulation Advice - Talk To The Insulation Experts

Knauf Insulation - Building Slabs

Product **Knauf Earthwool Building Slab** **33kg Density Mineral Fibre Slabs** **(Stone Wool Insulation)**

Thermal, Acoustic, Breathable and Fire Safe Insulation: Suitable for roof rafters, timberframe walls, dwarf walls, stud partitions, ceilings and floor joist.

| | Thickness mm | Lambda value w/mK | Thermal Resistance | Width mtr | Length mtr | Pieces Per pack | m2 Per pack | List price m2 € | List price per pack € |
|-------|-----------------|----------------------|-----------------------|--------------|---------------|--------------------|----------------|--------------------|--------------------------|
| RS 33 | 40 | 0.037 | 1.05 | 0.600 | 1.200 | 14 | 10.08 | 6.37 | 64.21 |
| RS 33 | 50 | 0.037 | 1.35 | 0.600 | 1.200 | 12 | 8.64 | 7.89 | 68.17 |
| RS 33 | 60 | 0.037 | 1.60 | 0.600 | 1.200 | 10 | 7.20 | 9.37 | 67.46 |
| RS 33 | 70 | 0.037 | 1.85 | 0.600 | 1.200 | 8 | 5.76 | 11.55 | 66.53 |

Product **Knauf Earthwool Building Slab** **45kg Density Mineral Fibre Slabs** **(Stone Wool Insulation)**

Thermal, Acoustic, Breathable and Fire Safe Insulation: Suitable for roof rafters, timberframe walls, dwarf walls, stud partitions, ceilings and floor joist.

| | Thickness mm | Lambda value w/mK | Thermal Resistance | Width mtr | Length mtr | Pieces Per pack | m2 Per pack | List price m2 € | List price per pack € |
|-------|-----------------|----------------------|-----------------------|--------------|---------------|--------------------|----------------|--------------------|--------------------------|
| RS 45 | 25 | 0.035 | 0.70 | 0.600 | 1.200 | 20 | 14.40 | 4.44 | 63.94 |
| RS 45 | 30 | 0.035 | 0.85 | 0.600 | 1.200 | 16 | 11.52 | 5.30 | 61.06 |
| RS 45 | 40 | 0.035 | 1.10 | 0.600 | 1.200 | 12 | 8.64 | 6.98 | 60.31 |
| RS 45 | 50 | 0.035 | 1.40 | 0.600 | 1.200 | 10 | 7.20 | 8.64 | 62.21 |
| RS 45 | 60 | 0.035 | 1.70 | 0.600 | 1.200 | 8 | 5.76 | 10.28 | 59.21 |
| RS 45 | 75 | 0.035 | 2.10 | 0.600 | 1.200 | 6 | 4.32 | 12.67 | 54.73 |
| RS 45 | 100 | 0.035 | 2.85 | 0.600 | 1.200 | 5 | 3.60 | 16.48 | 59.33 |

Product **Knauf Earthwool Building Slab** **60kg Density Mineral Fibre Slabs** **(Stone Wool Insulation)**

Thermal, Acoustic, Breathable and Fire Safe Insulation: Suitable for roof rafters, timberframe walls, dwarf walls, stud partitions, ceilings and floor joist.

| | Thickness mm | Lambda value w/mK | Thermal Resistance | Width mtr | Length mtr | Pieces Per pack | m2 Per pack | List price m2 € | List price per pack € |
|-------|-----------------|----------------------|-----------------------|--------------|---------------|--------------------|----------------|--------------------|--------------------------|
| RS 60 | 25 | 0.035 | 0.70 | 0.600 | 1.200 | 18 | 12.96 | 5.31 | 68.82 |
| RS 60 | 40 | 0.035 | 1.10 | 0.600 | 1.200 | 12 | 8.64 | 8.39 | 72.49 |
| RS 60 | 50 | 0.035 | 1.40 | 0.600 | 1.200 | 9 | 6.48 | 10.37 | 67.20 |
| RS 60 | 60 | 0.035 | 1.70 | 0.600 | 1.200 | 7 | 5.04 | 12.33 | 62.14 |
| RS 60 | 75 | 0.035 | 2.10 | 0.600 | 1.200 | 6 | 4.32 | 15.19 | 65.62 |
| RS 60 | 100 | 0.035 | 2.85 | 0.600 | 1.200 | 4 | 2.88 | 19.76 | 56.91 |

Density per m3

For Trade Discounts Please Call ROI 01-8612000 NI 00353-1-8612000

For Thermal, Acoustic and Fire Safe Insulation Advice - Talk To The Insulation Experts

Knauf Insulation - Building Slabs

Product **Knauf Earthwool Building Slab** **100kg Density Mineral Fibre Slabs** **(Stone Wool Insulation)**

Thermal, Acoustic, Breathable and Fire Safe Insulation: Suitable for roof rafters, timberframe walls, dwarf walls, stud partitions, ceilings and floor joist.

| | Thickness | Lambda value | Thermal | Width | Length | Pieces | m2 | List price m2 | List price per pack |
|--------|-----------|--------------|------------|-------|--------|----------|----------|---------------|---------------------|
| | mm | w/mK | Resistance | mtr | mtr | Per pack | Per pack | € | € |
| RS 100 | 25 | 0.035 | 0.70 | 0.600 | 1.200 | 12 | 8.64 | 7.99 | 69.03 |
| RS 100 | 30 | 0.035 | 0.85 | 0.600 | 1.200 | 10 | 7.20 | 9.55 | 68.76 |
| RS 100 | 40 | 0.035 | 1.10 | 0.600 | 1.200 | 7 | 5.04 | 12.59 | 63.45 |
| RS 100 | 50 | 0.035 | 1.40 | 0.600 | 1.200 | 6 | 4.32 | 15.57 | 67.26 |
| RS 100 | 75 | 0.035 | 2.10 | 0.600 | 1.200 | 4 | 2.88 | 22.79 | 65.64 |
| RS 100 | 100 | 0.035 | 2.85 | 0.600 | 1.200 | 3 | 2.16 | 29.63 | 64.00 |

Density per m3

Think - Thermal, Acoustic, Breathable and Fire Safe Insulation Solutions

Stonewool - Mineral wool A1 Non combustable insulation materials

Tissue facing available to order - Allow 7 to 10 working days

Add €4.80 per m2

Acoustic building solution tips

The plasterboard layer is the first line of defence
 Two layers of plasterboard is better than one (increased density)
 Sound intrusion is best tackled from source
 Gaps between the insulation layer and the construction layers will reduce acoustic performance
 Resilliant bars will improve the overall acoustic performance of the wall or ceiling
 Putty pads can reduce the risk of flanking sound through electrical sockets and switches
 Acoustic mastic can reduce the risk of flanking sound above, below and around the partition

Accessories

Acoustic sealant
 Airtight tapes
 Isolation strips
 Resilliant bar



For Trade Discounts Please Call ROI 01-8612000 NI 00353-1-8612000

For Thermal, Acoustic and Fire Safe Insulation Advice - Talk To The Insulation Experts

SUPERGLASS Insulation

Product Superglass HP (HIGH PERFORMANCE) Timber roll 34

Thermal, Acoustic, Breathable and Fire Safe Insulation: Suitable for roof rafters, timberframe walls, dwarf walls, stud partitions, ceilings and floor joist.

| Thickness mm | Lambda value w/mK | Thermal Resistance | Width mtr | Length mtr | m2 Per roll | List price m2 € | List price per roll € | |
|-----------------|----------------------|-----------------------|--------------|---------------|----------------|--------------------|--------------------------|-------|
| Combi Roll | 100 | 0.034 | 2.94 | 1.140 | 4.500 | 5.130 | 9.29 | 47.66 |
| Combi Roll | 150 | 0.034 | 5.25 | 1.140 | 3.750 | 4.270 | 13.81 | 58.97 |
| Combi Roll | 180 | 0.034 | 4.41 | 1.140 | 3.100 | 3.530 | 16.67 | 58.85 |

Product Superglass 18kg Density Acoustic Roll

Thermal, Acoustic, Breathable and Fire Safe Insulation: Suitable for stud partitions, ceilings and floor joist.

| Thickness mm | Width mtr | Length mtr | m2 Per roll | List price m2 € | List price per roll € | |
|-----------------|--------------|---------------|----------------|--------------------|--------------------------|-------|
| Solid roll | 25 | 1.200 | 22.50 | 27.00 | 2.79 | 75.33 |
| Solid roll | 50 | 1.200 | 13.00 | 15.60 | 4.28 | 66.77 |
| Solid roll | 70 | 1.200 | 9.000 | 10.80 | 6.33 | 68.36 |
| Solid roll | 100 | 1.200 | 6.500 | 7.800 | 6.17 | 48.13 |
| Combi Roll | 150 | 1.160 | 4.500 | 5.220 | 8.46 | 44.16 |

Product Superglass Cladding Roll 40

Suitable for twin skin metal frame roof and walls.

| Thickness mm | Lambda value w/mK | Thermal Resistance | Width mtr | Length mtr | m2 Per roll | List price m2 € | List price per roll € | |
|-----------------|----------------------|-----------------------|--------------|---------------|----------------|--------------------|--------------------------|-------|
| Solid roll | 100 | 0.040 | 2.500 | 1.200 | 9.950 | 11.94 | 3.94 | 47.00 |
| Solid roll | 120 | 0.040 | 3.000 | 1.200 | 8.050 | 9.660 | 4.66 | 45.00 |
| Solid roll | 140 | 0.040 | 3.500 | 1.200 | 7.000 | 8.400 | 5.36 | 45.00 |
| Solid roll | 160 | 0.040 | 4.000 | 1.200 | 6.050 | 7.260 | 5.92 | 43.00 |
| Solid roll | 180 | 0.040 | 4.500 | 1.200 | 5.450 | 6.540 | 6.57 | 43.00 |
| Solid roll | 200 | 0.040 | 5.000 | 1.200 | 4.600 | 5.520 | 6.88 | 38.00 |
| Solid roll | 240 | 0.040 | 6.000 | 1.200 | 3.600 | 3.600 | 7.78 | 28.00 |



Glasswool - Mineralwool A1 Non combustable insulation materials

For Trade Discounts Please Call ROI 01-8612000 NI 00353-1-8612000

For Thermal, Acoustic and Fire Safe Insulation Advice - Talk To The Insulation Experts

ROCKWOOL Insulation

Product **ROCKWOOL Roll Batt** 23kg Density Thermal and Acoustic Insulation Roll

| Thickness mm | Lambda value w/mK | Density kg | Width mtr | Length mtr | Pieces Per roll | m2 Per roll | List price m2 € | List price per roll € |
|-----------------|----------------------|---------------|--------------|---------------|--------------------|----------------|--------------------|--------------------------|
| 100 | 0.044 | 23 | 0.400 | 4.800 | 3 | 5.76 | 5.55 | 31.97 |
| 150 | 0.044 | 23 | 0.400 | 3.650 | 3 | 4.38 | 8.46 | 37.05 |
| 100 | 0.044 | 23 | 0.600 | 4.800 | 2 | 5.76 | 5.55 | 31.97 |
| 150 | 0.044 | 23 | 0.600 | 3.650 | 2 | 4.38 | 8.46 | 37.05 |

Product **ROCKWOOL Flexi Slabs to suit 400mm centres** 38kg Density Thermal and Acoustic Insulation Slabs

| Thickness mm | Lambda value w/mK | Density kg | Width mtr | Length mtr | Pieces Per pack | m2 Per pack | List price m2 € | List price per pack € |
|-----------------|----------------------|---------------|--------------|---------------|--------------------|----------------|--------------------|--------------------------|
| 50 | 0.038 | 38 | 0.400 | 1.200 | 12 | 5.76 | 5.31 | 30.59 |
| 100 | 0.038 | 38 | 0.400 | 1.200 | 6 | 2.88 | 10.54 | 30.36 |
| 140 | 0.035 | 38 | 0.400 | 1.200 | 4 | 1.92 | 14.80 | 28.42 |

ROCKWOOL Acoustic mastic reduces flanking sound

Isolation joist strips reduce impact sound

Product **ROCKWOOL Flexi Slabs to suit 600mm centres** 38kg Density Thermal and Acoustic Insulation Slabs

| Thickness mm | Lambda value w/mK | Density kg | Width mtr | Length mtr | Pieces Per pack | m2 Per pack | List price m2 € | List price per pack € |
|-----------------|----------------------|---------------|--------------|---------------|--------------------|----------------|--------------------|--------------------------|
| 50 | 0.038 | 38 | 0.600 | 1.200 | 12 | 8.64 | 5.31 | 45.88 |
| 60 | 0.038 | 38 | 0.600 | 1.200 | 12 | 8.64 | 6.51 | 56.25 |
| 70 | 0.038 | 38 | 0.600 | 1.200 | 8 | 5.76 | 7.38 | 42.51 |
| 90 | 0.038 | 38 | 0.600 | 1.200 | 6 | 4.32 | 9.27 | 40.05 |
| 100 | 0.038 | 38 | 0.600 | 1.200 | 6 | 4.32 | 10.54 | 45.53 |
| 120 | 0.035 | 38 | 0.600 | 1.200 | 6 | 4.32 | 12.64 | 54.60 |
| 140 | 0.035 | 38 | 0.600 | 1.200 | 4 | 2.88 | 14.80 | 42.62 |
| 180 | 0.035 | 38 | 0.600 | 1.200 | 3 | 2.16 | 19.02 | 41.08 |
| 200 | 0.035 | 38 | 0.600 | 1.200 | 3 | 2.16 | 21.14 | 45.66 |



Rockwool - Mineral wool A1 Non combustable insulation materials
Density per m3

For Trade Discounts Please Call ROI 01-8612000 NI 00353-1-8612000

For Thermal, Acoustic and Fire Safe Insulation Advice - Talk To The Insulation Experts

ROCKWOOL Insulation

Product **ROCKWOOL RWA45** 45kg Density Thermal and Acoustic Insulation Slabs

| Thickness mm | Density kg | Width mtr | Length mtr | Pieces Per pack | m2 Per pack |
|-----------------|---------------|--------------|---------------|--------------------|----------------|
| 25 | 45 | 0.600 | 1.200 | 16 | 11.52 |
| 30 | 45 | 0.600 | 1.200 | 12 | 8.64 |
| 40 | 45 | 0.600 | 1.200 | 12 | 8.64 |
| 50 | 45 | 0.600 | 1.200 | 9 | 6.48 |
| 60 | 45 | 0.600 | 1.200 | 8 | 5.76 |
| 75 | 45 | 0.600 | 1.200 | 6 | 4.32 |
| 100 | 45 | 0.600 | 1.200 | 4 | 2.88 |

| List price m2 € |
|--------------------|
| 2.89 |
| 3.50 |
| 4.69 |
| 5.83 |
| 7.04 |
| 8.78 |
| 11.60 |

| List price per pack € |
|--------------------------|
| 33.29 |
| 30.24 |
| 40.52 |
| 37.78 |
| 40.55 |
| 37.93 |
| 33.41 |

Product **ROCKWOOL RW3** 60kg Density Thermal and Acoustic Insulation Slabs

| Thickness mm | Density kg | Width mtr | Length mtr | Pieces Per pack | m2 Per pack |
|-----------------|---------------|--------------|---------------|--------------------|----------------|
| 25 | 60 | 0.600 | 1.200 | 16 | 11.52 |
| 30 | 60 | 0.600 | 1.200 | 15 | 10.8 |
| 40 | 60 | 0.600 | 1.200 | 10 | 7.2 |
| 50 | 60 | 0.600 | 1.200 | 8 | 5.76 |
| 60 | 60 | 0.600 | 1.200 | 6 | 4.32 |
| 75 | 60 | 0.600 | 1.200 | 6 | 4.32 |
| 100 | 60 | 0.600 | 1.200 | 4 | 2.88 |

| List price m2 € |
|--------------------|
| 3.72 |
| 4.48 |
| 5.96 |
| 7.42 |
| 8.91 |
| 11.13 |
| 14.95 |

| List price per pack € |
|--------------------------|
| 42.85 |
| 48.38 |
| 42.91 |
| 42.74 |
| 38.49 |
| 48.08 |
| 43.06 |

Tissue faced slabs available - 30mm and 50mm

Product **ROCKWOOL RW4** 80kg Density Thermal and Acoustic Insulation Slabs

| Thickness mm | Density kg | Width mtr | Length mtr | Pieces Per pack | m2 Per pack |
|-----------------|---------------|--------------|---------------|--------------------|----------------|
| 50 | 80 | 0.600 | 1.200 | 6 | 4.32 |
| 75 | 80 | 0.600 | 1.200 | 4 | 2.88 |
| 100 | 80 | 0.600 | 1.200 | 3 | 2.16 |

| List price m2 € |
|--------------------|
| 8.38 |
| 12.51 |
| 16.73 |

| List price per pack € |
|--------------------------|
| 36.20 |
| 36.03 |
| 36.14 |

ROCKWOOL Acoustic mastic reduces flanking sound



Rockwool - Mineral wool A1 Non combustable insulation materials
Density per m3

For Trade Discounts Please Call ROI 01-8612000 NI 00353-1-8612000

For Thermal, Acoustic and Fire Safe Insulation Advice - Talk To The Insulation Experts

ROCKWOOL Insulation

Product **ROCKWOOL RW5** 100kg Density Thermal and Acoustic Insulation Slabs

| Thickness mm | Density kg | Width mtr | Length mtr | Pieces Per pack | m2 Per pack |
|-----------------|---------------|--------------|---------------|--------------------|----------------|
| 25 | 100 | 0.600 | 1.200 | 8 | 5.76 |
| 30 | 100 | 0.600 | 1.200 | 8 | 5.76 |
| 40 | 100 | 0.600 | 1.200 | 6 | 4.32 |
| 50 | 100 | 0.600 | 1.200 | 4 | 2.88 |
| 60 | 100 | 0.600 | 1.200 | 4 | 2.88 |
| 75 | 100 | 0.600 | 1.200 | 3 | 2.16 |
| 100 | 100 | 0.600 | 1.200 | 2 | 1.44 |

ROCKWOOL Acoustic mastic reduces flanking sound

Isolation joist strips reduce impact sound

| List price m2 € | List price per pack € |
|--------------------|--------------------------|
| 5.41 | 31.16 |
| 6.51 | 37.50 |
| 8.72 | 37.67 |
| 10.94 | 31.51 |
| 13.09 | 37.70 |
| 16.33 | 35.27 |
| 21.69 | 31.23 |

Tissue faced slabs available - 30mm and 50mm

Product **ROCKWOOL Cladding Roll** Suitable for Twin Skin Roof & Wall

| Thickness mm | Lambda value w/mK | Width mtr | Length mtr | Pieces Per roll | m2 Per roll |
|-----------------|----------------------|--------------|---------------|--------------------|----------------|
| 60 | 0.040 | 1.200 | 3.200 | 2 | 7.680 |
| 80 | 0.040 | 1.200 | 5.000 | 1 | 6.000 |
| 100 | 0.040 | 1.200 | 4.800 | 1 | 5.760 |
| 120 | 0.040 | 1.200 | 4.000 | 1 | 4.800 |
| 150 | 0.040 | 1.200 | 3.200 | 1 | 3.840 |
| 160 | 0.040 | 1.200 | 3.000 | 1 | 3.600 |
| 180 | 0.040 | 1.200 | 2.700 | 1 | 3.240 |
| 200 | 0.040 | 1.200 | 2.400 | 1 | 2.880 |
| 220 | 0.040 | 1.200 | 2.200 | 1 | 2.640 |

| List price m2 € | List price per roll € |
|--------------------|--------------------------|
| 4.16 | 31.95 |
| 5.54 | 33.24 |
| 6.92 | 39.86 |
| 8.34 | 40.03 |
| 10.75 | 41.28 |
| 11.11 | 40.00 |
| 12.45 | 40.34 |
| 13.85 | 39.89 |
| 15.21 | 40.15 |

Product **ROCKWOOL Rainscreen Duo Slab 1000mm x 600mm**

Ventilated and Unventilated Rainscreen Walls

| Thickness mm | Lambda value w/mK | Density kg | Width mtr | Length mtr | Pieces Per pack | m2 Per pack |
|-----------------|----------------------|---------------|--------------|---------------|--------------------|----------------|
| 100 | 0.035 | Dual | 0.600 | 1.000 | 6 | 3.600 |
| 125 | 0.035 | Dual | 0.600 | 1.000 | 5 | 3.000 |
| 150 | 0.035 | Dual | 0.600 | 1.000 | 4 | 2.400 |
| 180 | 0.035 | Dual | 0.600 | 1.000 | 3 | 1.800 |

| List price m2 € | List price per pack € |
|--------------------|--------------------------|
| 35.77 | 128.77 |
| 37.57 | 112.71 |
| 53.64 | 128.74 |
| 64.39 | 115.90 |

For Trade Discounts Please Call ROI 01-8612000 NI 00353-1-8612000

For Thermal, Acoustic and Fire Safe Insulation Advice - Talk To The Insulation Experts

ROCKWOOL Fire - Fire Pro

Product **ROCKWOOL Fire Barrier Plain** Wire reinforced fire protection blanket Also available with foil facing POA

| Thickness mm | Width mtr | Length mtr | Pieces Per pack | m2 Per roll |
|-----------------|--------------|---------------|--------------------|----------------|
| 50 | 1.000 | 4.000 | 1 | 4.000 |
| 60 | 1.000 | 3.500 | 1 | 3.500 |

| List price m2 € | List price per roll € |
|--------------------|--------------------------|
| 13.72 | 54.88 |
| 16.52 | 57.82 |

Product **ROCKWOOL EASYFIT FIRE BARRIER SYSTEM**

| Thickness mm | Width mm | Length mtr | Pieces Per pack |
|-----------------|-------------|---------------|--------------------|
| Angle Support | 1.2 | 75 | 3.000 |
| Clamping Plate | 1.2 | 40 | 3.000 |

| List price per len € |
|-------------------------|
| 31.94 |
| 17.77 |

Product **Tying Wire**
Used to stitch blanket overlaps

| Thickness mm | Length mtr | Pieces Per pack |
|-----------------|---------------|--------------------|
| 0.5 | 50 | 1 |

| List price per roll € |
|--------------------------|
| 12 |

Product **ROCKWOOL SP Fire Stop Slab** Unventilated Rainscreen Walls

| Thickness mm | Fire Rating UP-TO | Width mtr | Length mtr | Pieces Per pack | m2 Per pack |
|-----------------|----------------------|--------------|---------------|--------------------|----------------|
| 75 | 60 Minutes | 0.650 | 1.000 | 4 | 2.600 |
| 90 | 120 Minutes | 0.650 | 1.000 | 4 | 2.600 |

| List price m2 € | List price per pack € |
|--------------------|--------------------------|
| 74.63 | 194.04 |
| 79.48 | 206.65 |

Product **ROCKWOOL SP Fixing brackets/Z clips** Fixing brackets are required with every SP Fire Stop slab sale

| Cavity Width mm | Fire Rating UP-TO | Fixing Brackets | Pieces Per pack |
|--------------------|----------------------|--------------------|--------------------|
| 50 to 100 | N/A | Small | 50 |
| 101 to 400 | N/A | Large | 50 |

| List price per pack € |
|--------------------------|
| 107.41 |
| 125.36 |

Choosing the correct Fire Rating

| | Integrity | Insulation | |
|--------------|------------|------------|---------------|
| Test results | 60 Minutes | 30 Minutes | GOOD |
| Test results | 60 Minutes | 60 Minutes | BETTER |



For Trade Discounts Please Call ROI 01-8612000 NI 00353-1-8612000

For Thermal, Acoustic and Fire Safe Insulation Advice - Talk To The Insulation Experts

ROCKWOOL Fire - Fire Pro

Product

ROCKWOOL Masonry Wall Cavity Barriers

Also Suitable for Timberframe construction

| To suit Cavity width mm | Fire Rating UP-TO | Thickness mm | Width mm | Length mtr | Pieces Per pack | Lm per pack | List price 1m € | List price per pack € |
|----------------------------|----------------------|-----------------|-------------|---------------|--------------------|----------------|--------------------|--------------------------|
| 45-55 | 60 Minutes | 65 | 65 | 1.200 | 45 | 54.00 | 2.19 | 118.26 |
| 70-80 | 60 Minutes | 90 | 90 | 1.200 | 25 | 30.00 | 4.29 | 128.70 |
| 90-100 | 60 Minutes | 110 | 110 | 1.200 | 18 | 21.60 | 5.47 | 118.15 |
| 101-110 | 60 Minutes | 120 | 120 | 1.200 | 15 | 18.00 | 6.32 | 113.76 |
| 111-120 | 60 Minutes | 130 | 130 | 1.200 | 12 | 14.40 | 7.19 | 103.54 |
| 121-130 | 60 Minutes | 140 | 140 | 1.200 | 9 | 10.80 | 7.85 | 84.78 |
| 131-140 | 60 Minutes | 150 | 150 | 1.200 | 8 | 9.60 | 9.48 | 91.01 |
| 141-150 | 60 Minutes | 160 | 160 | 1.200 | 7 | 8.40 | 10.37 | 87.11 |

Product

ROCKWOOL Ablative Coated Batt

White intumescent coated fire batts

| Thickness (mm) | Width (mtr) | Length (mtr) | Pieces Per pack | m2 Per sheet | List price per sheet € |
|-------------------|----------------|-----------------|--------------------|-----------------|---------------------------|
| 50 | 0.600 | 1.200 | 1 | 0.72 | 19.47 |
| 60 | 0.600 | 1.200 | 1 | 0.72 | 20.46 |

Product

ROCKWOOL Ablative Coating

Ablative coating is required with every coated batt sale

| Tub Size | List price per tub € |
|-------------|-------------------------|
| 5kg | 33.70 |

Intumescent coating always applied to the edge of cut ablative coated batts

Product

ROCKWOOL Acoustic and Intumescent Sealant

| Tube Size | List price per tube € |
|--------------|--------------------------|
| 310ml | 4.00 |

ROCKWOOL®

"Fire Safe and Fire Stop are not the same"

For Trade Discounts Please Call ROI 01-8612000 NI 00353-1-8612000

For Thermal, Acoustic and Fire Safe Insulation Advice - Talk To The Insulation Experts

ROCKWOOL Fire - Fire Pro

Product **ROCKWOOL Fire Stop Compound** Floor openings

| Bag Size | Width (mm) | Length (mm) | Pieces |
|----------|------------|-------------|--------|
| 22kg | N/A | N/A | 1 |

| List price per bag |
|--------------------|
| € |
| 27.42 |

Product **ROCKWOOL Intumescent Putty Pads** Light switches and sockets

| Type | Single/double | Pieces Per box |
|----------|---------------|----------------|
| Internal | Single | 20 |
| Internal | Double | 20 |
| External | Single | 20 |
| External | Double | 20 |

| List price each |
|-----------------|
| € |
| 6.80 |
| 8.28 |
| 6.80 |
| 8.28 |

Product **ROCKWOOL Pipe Collars** 2 Hour Intumescent Pipe Collar

| Fire Rating | Nominal O/D mm | Pieces |
|-------------|----------------|--------|
| 2 Hours | 55 | 1 |
| 2 Hours | 63 | 1 |
| 2 Hours | 82 | 1 |
| 2 Hours | 110 | 1 |
| 2 Hours | 125 | 1 |
| 2 Hours | 160 | 1 |

| List price each |
|-----------------|
| € |
| 10.00 |
| 10.00 |
| 10.00 |
| 14.00 |
| 20.00 |
| 23.00 |

4 Hour Intumescent Pipe Collar

| Fire Rating | Nominal O/D mm | Pieces |
|-------------|----------------|--------|
| 4 Hours | 55 | 1 |
| 4 Hours | 63 | 1 |
| 4 Hours | 82 | 1 |
| 4 Hours | 110 | 1 |
| 4 Hours | 125 | 1 |
| 4 Hours | 160 | 1 |

| List price each |
|-----------------|
| € |
| 13.50 |
| 13.50 |
| 13.50 |
| 18.00 |
| 25.00 |
| 30.00 |



For Trade Discounts Please Call ROI 01-8612000 NI 00353-1-8612000

ROCKWOOL INSULATION Fire Stopping - Fire Pro

Product

ROCKWOOL Pipe Wraps

| Fire Rating | Nominal O/D mm | Pieces |
|-------------|----------------|--------|
| 2 Hours | 55 | 1 |
| 2 Hours | 63 | 1 |
| 2 Hours | 82 | 1 |
| 2 Hours | 110 | 1 |
| 2 Hours | 125 | 1 |
| 2 Hours | 160 | 1 |

2 Hour Intumescent Pipe Wrap

List price each

€

5.00

6.00

7.00

8.00

10.00

18.00

Product

ROCKWOOL Pipe Wraps

| Fire Rating | Nominal O/D mm | Pieces |
|-------------|----------------|--------|
| 4 Hours | 55 | 1 |
| 4 Hours | 63 | 1 |
| 4 Hours | 82 | 1 |
| 4 Hours | 110 | 1 |
| 4 Hours | 125 | 1 |
| 4 Hours | 160 | 1 |

4 Hour Intumescent Pipe Wrap

List price each

€

8.00

9.00

10.00

12.00

14.00

26.00

Fire Safe and Fire Stop are not the same

Fire Safe typically relates to a Non Combustable material that will not add to the fire load of a burning structure

Fire Barrier and Fire Stop are not the same

Not all Non Combustable mineral wool insulation materials will provide a Fire Barrier or Fire Stop

A Fire Stop is designed, tested and certifiable for use as a Fire stop

A Smoke and Fire Stop is designed, tested and certifiable for use as a Smoke and Fire Stop



Smoke Kills Before Fire

For Trade Discounts Please Call ROI 01-8612000 NI 00353-1-8612000

For Thermal, Acoustic and Fire Safe Insulation Advice - Talk To The Insulation Experts

Actis Hybris - Reflective Thermal Insulation - Roof and Wall

Product **Actis Hybris Reflective Insulation**

| Thickness mm | Lambda value w/mK | Width mtr | Length mtr | m2 Per roll |
|-----------------|----------------------|--------------|---------------|----------------|
| 45 | 0.033 | 1.200 | 5.750 | 6.90 |
| 60 | 0.033 | 1.200 | 4.780 | 5.74 |
| 75 | 0.033 | 1.200 | 4.010 | 4.81 |
| 90 | 0.033 | 1.200 | 3.570 | 4.28 |
| 105 | 0.033 | 1.200 | 3.130 | 3.76 |
| 120 | 0.033 | 1.200 | 2.730 | 3.28 |
| 135 | 0.033 | 1.200 | 2.510 | 3.01 |

| List price m2 € | List price per roll € |
|--------------------|--------------------------|
| 5.03 | 34.71 |
| 6.70 | 38.46 |
| 8.38 | 40.31 |
| 10.05 | 43.01 |
| 11.73 | 44.10 |
| 13.40 | 43.95 |
| 15.08 | 45.39 |

Actis Hybris - Reflective Thermal Breathable Layer - Roof and Wall

Product **Actis Boost R**

| Thickness mm | Thermal Resistance | Width mtr | Length mtr | m2 Per roll |
|-----------------|-----------------------|--------------|---------------|----------------|
| 35 | 1.35 | 1.500 | 6.700 | 10.05 |

| List price m2 € | List price per roll € |
|--------------------|--------------------------|
| 10.41 | 104.62 |

Actis HControl - Reflective Thermal Vapour Control - Roof and Wall

Product **Actis HControl**

| Thickness mm | Thermal Resistance | Width mtr | Length mtr | m2 Per roll |
|-----------------|-----------------------|--------------|---------------|----------------|
| 45 | 1.9 | 1600 | 6.250 | 10.00 |

| List price m2 € | List price per roll € |
|--------------------|--------------------------|
| 11.58 | 115.80 |

The energy in our homes and offices is lost through **Conduction, Convection** and **Radiant** heat loss.

Actis Hybrid range provides protection against all three.

Reflective insulation protects against heat loss in winter and excessive heat gain in summer.

A three in one solution providing optimum thermal protection.



For Trade Discounts Please Call ROI 01-8612000 NI 00353-1-8612000

For Thermal, Acoustic and Fire Safe Insulation Advice - Talk To The Insulation Experts

Actis Reflective Thermal Insulation

| Product | Actis Tri-Iso Super 10 Reflective roof and wall insulation (Multi-Foil) | | | | | | List price m2 € | List price per roll € |
|---------|--|-----------------------|---------------|--------------|---------------|----------------|--------------------|--------------------------|
| | Thickness mm | Thermal Resistance | Density kg | Width mtr | Length mtr | m2 Per roll | | |
| | 30 | 4.77 | N/A | 1.600 | 10.00 | 16.00 | 16.50 | 264.00 |

| Product | Actis SuperTherm 7 Reflective roof and wall insulation (Multi-Foil) | | | | | | List price m2 € | List price per roll € |
|---------|--|-----------------------|---------------|--------------|---------------|----------------|--------------------|--------------------------|
| | Thickness mm | Thermal Resistance | Density kg | Width mtr | Length mtr | m2 Per roll | | |
| | 30 | 0.81 | N/A | 1.600 | 10.000 | 16.00 | 12.00 | 192.00 |

| Product | Actis Tri-Iso Sols Reflective floor insulation Underfloor heating where insulation space is limited | | | | | | List price m2 € | List price per roll € |
|---------|--|-----------------------|---------------|--------------|---------------|----------------|--------------------|--------------------------|
| | Thickness mm | Thermal Resistance | Density kg | Width mtr | Length mtr | m2 Per roll | | |
| | 7 | 1.29 | N/A | 1.600 | 12.50 | 20.00 | 12.00 | 274.00 |



For Trade Discounts Please Call ROI 01-8612000 NI 00353-1-8612000

For Thermal, Acoustic and Fire Safe Insulation Advice - Talk To The Insulation Experts

Reflective Thermal Insulation

| | | | | | | |
|---------|--|--------------|--------------------------|----------------|--------------------------|--|
| Product | SuperQuilt Multi foil reflective Insulation | | | | | |
| | Thickness mm | Width mtr | Length mtr | m2 Per roll | List price per roll € | |
| | 45 | 1.500 | 10.00 | 15 | 196.80 | |
| Product | Foil Bubble Foil Reflective Insulation | | | | | |
| | Thickness mm | Width mtr | Length mtr | m2 Per roll | List price per roll € | |
| | 4 | 1.200 | 25.00 | 30 | 114.32 | |
| Product | Double Bubble Foil Reflective Insulation | | | | | |
| | Thickness mm | Width mtr | Length mtr | m2 Per roll | List price per roll € | |
| | 4 | 1.200 | 25.00 | 30 | 147.68 | |
| Product | Aluminum Foil Tape | | Reflective Tape | | | |
| | Width mm | Length lm | | | | |
| | 50 | 45 | List price per roll € | | | |
| | 75 | 45 | | | | |
| | 100 | 45 | | | | |
| | | | | 6.00 | | |
| | | | | 7.50 | | |
| | | | | 10.00 | | |
| Product | Comfort Roll Multi foil reflective Insulation | | | | | |
| | Thickness mm | Width mtr | Length mtr | m2 Per roll | List price per roll € | |
| | 45 | 1.500 | 10.00 | 15 | 159.00 | |
| Product | Aluthermo Quattro Reflective Insulation | | | | | |
| | Thickness mm | Width mtr | Length mtr | m2 Per roll | List price per roll € | |
| | 10 | 1.200 | 25.00 | 30 | 650.00 | |

For Trade Discounts Please Call ROI 01-8612000 NI 00353-1-8612000

Breathable / Vapour Open - ROOF & WALL Membranes

| | | | | | | |
|---------|---|-----------------|--------------|---------------|----------------|--------------------------|
| Product | Proctor Roofshield Vapour permeable roofing membrane | | | | | |
| | Membrane Type | Application | Width mtr | Length mtr | m2 Per roll | List price per roll € |
| | Breather | Roof | 1.000 | 5 | 50 | 230.00 |
| Product | Proctor Reflectashield TF 0.81 Reflective breathable timberframe wall membrane | | | | | |
| | Membrane Type | Application | Width mtr | Length mtr | m2 Per roll | List price per roll € |
| | Reflective Breather | Wall | 2.700 | 100 | 270 | 840.00 |
| Product | Breath-X Vapour permeable roofing membrane | | | | | |
| | Membrane Type | Thickness mm | Width mtr | Length mtr | m2 Per roll | List price per roll € |
| | Breather | 0.5 | 1.500 | 50 | 75 | 80.00 |
| Product | Tyvek Supro Vapour permeable roofing membrane | | | | | |
| | Membrane Type | Thickness mm | Width mtr | Length mtr | m2 Per roll | List price per roll € |
| | Breather | 0.5 | 1.500 | 50 | 75 | 207.00 |
| Product | Protect TF 200 Vapour permeable wall membrane | | | | | |
| | Membrane Type | Thickness mm | Width mtr | Length mtr | m2 Per roll | List price per roll € |
| | Breathable (wall) | 0.5 | 1.350 | 100 | 135 | 135.00 |
| | Breathable (wall) | 0.5 | 2.700 | 100 | 270 | 270.00 |
| | Breathable (wall) | 0.5 | 3.000 | 100 | 300 | 300.00 |

NOTE:

A good quality breathable (**vapour open**) roof and wall membrane will reduce the risk of moisture buildup and condensation in the home.

A reflective breathable (**Vapour open**) wall and roof membrane will increase the overall thermal performance of the roof or wall.

A good quality vapour control / airtight membrane will help reduce heating bills. Reducing heat loss through convection.

The insulation layer, vapour control membrane, tapes and sealants, ventilation and the breathability of the structure, are all equally important. A good insulation and associated building materials specification is key to achieving an energy efficient home.

For Trade Discounts Please Call ROI 01-8612000 NI 00353-1-8612000

DAFA Airtight and Vapour Control Membranes - Tapes & Sealants

Product **FAKRO Airtight Membrane & Vapour Barrier**

| Type Membrane | Type | Width mtr | Length mtr | m2 Per roll |
|------------------|-------------|--------------|---------------|----------------|
| FAKRO Eurotop | Active V110 | 1.500 | 50 | 75 |

| |
|--------------------------|
| List price per roll € |
| 170.00 |

Product **DAFA Airtight Tapes**

| Type Tapes | Type | Width (mm) | Length lm | Pieces/ Box |
|-----------------|------------------|---------------|--------------|----------------|
| DAFA Blue | Straight | 50 | 25 | 12 |
| DAFA Green | Flex | 50 | 25 | 12 |
| DAFA Green | Split 12mm /48mm | 60 | 25 | 10 |
| DAFA Green | Flex | 100 | 25 | 6 |
| DAFA Blue | Double sided | 30 | 25 | 12 |
| DAFA Black | Straight | 60 | 25 | 10 |
| DAFA Masonry | Straight | | 10 | 5 |
| Dafa Multi seal | Straight | 50 | 5 | 8 |
| DAFA Grey | Split | 60 | 25 | 10 |
| DAFA Window | Straight | 150 | 15 | 2 |

| |
|--------------------------|
| List price per roll € |
| 24.00 |
| 24.00 |
| 28.67 |
| 42.58 |
| 21.33 |
| 32.00 |
| 49.00 |
| 30.00 |
| 35.00 |
| 70.00 |

Product **DAFA Airtight Sealants / Adhesives**

| Type Sealant | Type | Tube ml | Pieces/ Box |
|-----------------|---------------|------------|----------------|
| P270 310 | Foil adhesive | 310 | 20 |

| |
|--------------------------|
| List price per tube € |
| 10.70 |

For Trade Discounts Please Call ROI 01-8612000 NI 00353-1-8612000

INTELLO Airtight and Vapour Control Membranes - Tapes & Sealants

| Product Intello Airtight membrane & Vapour control layer | | | | | |
|---|----------------|--------------|---------------|----------------|--------------------------|
| Type Membrane | Type | Width mtr | Length mtr | m2 Per roll | List price per roll € |
| Intello Plus | Vapour Barrier | 1.500 | 50 | 75 | 264.33 |

| Product Intello Tapes | | | | | |
|------------------------------|-------------|--------------|----------------|-----------------|--------------------------|
| Type Tapes | Width mm | Length lm | Pieces/ Box | | List price per roll € |
| Tescon Vana | 60 | 30 | 20 | | 32.78 |
| Tescon Vana | 150 | 30 | 2 | | 80.82 |
| Tescon No.1 | 60 | 30 | 20 | | 32.78 |
| Tescon Vana Profil | 60 | 30 | 20 | (Split 48/12mm) | 41.07 |
| Tescon Invis | 60 | 30 | 20 | | 35.10 |

| Product Intello Airtight Sealants / Adhesives | | | | | |
|--|------------|----------------|----------------|------|--------------------------|
| Type Sealant | Tube ml | lm Per roll | Pieces/ Box | | List price per roll € |
| Orcon F | 310 | | 20 | | 9.94 |
| Orcon F | 600 | | 12 | | 14.57 |
| Orcon Line | 10mm | 15 | 20 | Roll | 31.14 |
| Eco Coll | 310 | | 20 | | 11.39 |

| Product Intello Patches | | | | | |
|--------------------------------|-----------------|------------|----------------|------|-------------------------|
| Type Patch | Application | Size mm | Pieces/ Box | | List price per box € |
| Tescon Vana | Patch | 180 x 180 | 25 per roll | Roll | 25.83 |
| Tescon Incav | Internal Corner | 60 x 60 | 4 | | 13.58 |
| Tescon Incav | Internal Corner | 60 x 60 | 20 | | 53.00 |
| Tescon Invex | External Corner | 60 x 60 | 4 | | 15.89 |
| Tescon Invex | External Corner | 60 x 60 | 20 | | 63.60 |
| Contega FC | | 85 X 15M | 1 | Roll | 31.14 |

For Trade Discounts Please Call ROI 01-8612000 NI 00353-1-8612000

Isover - Airtight and Vapour Control Membranes - Tapes & Sealants

Product **Vario Airtight membrane & Vapour control layer**

| Type | Width mtr | Length mtr | m2 Per roll |
|--------|--------------|---------------|----------------|
| Duplex | 1.500 | 40 | 60 |

| List price per roll € |
|--------------------------|
| 174.00 |

Product **Vario Tapes**

| Type Tapes | Width mm | Length lm | Pieces/ Box |
|-------------------|-------------|--------------|----------------|
| VARIO TAPE 60 KB1 | 60 | 40 | 10 |
| VARIO MULTITAPE | 60 | 25 | 10 |
| VARIO PROTAPE | 25 | 10 | 5 |

| List price per roll € |
|--------------------------|
| 40.80 |
| 48.00 |
| 32.73 |

Product **Vario Airtight Sealant**

| Type Sealant | Tube ml | Pieces/ Box |
|-----------------|------------|----------------|
| VARIO MASTIC DS | 310 | 12 |

| List price per tube € |
|--------------------------|
| 11.28 |



For Trade Discounts Please Call ROI 01-8612000 NI 00353-1-8612000

For Thermal, Acoustic and Fire Safe Insulation Advice - Talk To The Insulation Experts

Ampack Breathable Membranes - Airtight and Vapour Control

Product **Ampack** Vapour Permeable Roof & Wall Membrane

| Membrane Type | Width | Length | m2 |
|------------------|-------|--------|----------|
| Vapour Permeable | mtr | mtr | Per roll |
| Ampatop Aero | 1.500 | 50 | 75 |
| Ampatop Protecta | 1.500 | 50 | 75 |



| List price per roll |
|---------------------|
| € |
| 180.00 |
| 262.71 |

Ampack Airtight membrane & Vapour control layer

| Membrane Type | Width | Length | m2 |
|-----------------|-------|--------|----------|
| Airtight / VCL | (mtr) | mtr | Per roll |
| Ampatex DB 90 | 1.500 | 50 | 75 |
| Ampatex Variano | 1.500 | 50 | 75 |

| List price per roll |
|---------------------|
| € |
| 183.32 |
| 290.67 |

Product **Ampack** Tapes & Sealants

| Type | Width | Length | Thickness | Pieces/ | ml |
|-----------------------|-------|--------|-----------|---------|---------------|
| Tapes | mm | lm | mm | Box | Per cartridge |
| Ampacoll XT 60 | 60 | 25 | N/A | 10 | |
| Ampacoll XT 60 | 60 | 25 | N/A | 10 | |
| Ampacoll XT 100 | 100 | 25 | N/A | 4 | |
| Ampacoll XT 150 | 150 | 25 | N/A | 4 | |
| Ampacoll XT 200 | 200 | 25 | N/A | 2 | |
| Ampacoll UV | 60 | 25 | N/A | 10 | |
| Ampacoll INT | 60 | 40 | N/A | 10 | |
| Ampacoll DT | 20 | 50 | N/A | 12 | |
| Ampacoll BFK 80 | 80 | 25 | 1 | 2 | |
| Ampacoll FE | 60 | 25 | N/A | 10 | |
| Ampacoll BFK 535 S | 50 | 5 | 2 | 12 | |
| Ampacoll BFK 535 | 50 | 25 | 2 | 4 | |
| Ampacoll RA Tube | | | | 12 | 310 |
| Ampacoll RA Cartridge | | | | 10 | 600 |
| Ampacoll Superfix | | | | 12 | 310 |
| Ampacoll Superfix | | | | 10 | 600 |
| Ampacoll Connecto | | | | 6 | 1000 |

| List price per roll |
|---------------------|
| € |
| 28.25 |
| 39.03 |
| 55.89 |
| 79.75 |
| 106.57 |
| 40.10 |
| 32.19 |
| 28.89 |
| 91.21 |
| 53.66 |
| 24.83 |
| 117.12 |
| 12.44 |
| 21.19 |
| 17.46 |
| 28.60 |
| 28.89 |

For Trade Discounts Please Call ROI 01-8612000 NI 00353-1-8612000

For Thermal, Acoustic and Fire Safe Insulation Advice - Talk To The Insulation Experts

Quinnterm Polyisocyanurate PIR Foam - Floor Insulation

Product **Quinnterm FLOOR Insulation** Foil faced rigid insulation board

| Thickness mm | Lambda value w/mK | Thermal Resistance | Width mtr | Length mtr | m2 Per sheet |
|-----------------|----------------------|-----------------------|--------------|---------------|-----------------|
| 25 | 0.022 | 1.136 | 1.200 | 2.400 | 2.88 |
| 30 | 0.022 | 1.364 | 1.200 | 2.400 | 2.88 |
| 40 | 0.022 | 1.818 | 1.200 | 2.400 | 2.88 |
| 50 | 0.022 | 2.273 | 1.200 | 2.400 | 2.88 |
| 60 | 0.022 | 2.727 | 1.200 | 2.400 | 2.88 |
| 70 | 0.022 | 3.182 | 1.200 | 2.400 | 2.88 |
| 75 | 0.022 | 3.409 | 1.200 | 2.400 | 2.88 |
| 80 | 0.022 | 3.636 | 1.200 | 2.400 | 2.88 |
| 90 | 0.022 | 4.090 | 1.200 | 2.400 | 2.88 |
| 100 | 0.022 | 4.545 | 1.200 | 2.400 | 2.88 |
| 110 | 0.022 | 5.000 | 1.200 | 2.400 | 2.88 |
| 120 | 0.022 | 5.455 | 1.200 | 2.400 | 2.88 |
| 125 | 0.022 | 5.682 | 1.200 | 2.400 | 2.88 |
| 130 | 0.022 | 5.909 | 1.200 | 2.400 | 2.88 |
| 140 | 0.022 | 6.364 | 1.200 | 2.400 | 2.88 |
| 150 | 0.022 | 6.818 | 1.200 | 2.400 | 2.88 |

| List price m2 € |
|--------------------|
| 6.99 |
| 7.35 |
| 8.10 |
| 8.65 |
| 10.18 |
| 12.03 |
| 13.51 |
| 13.55 |
| 13.98 |
| 14.35 |
| 18.40 |
| 19.21 |
| 21.55 |
| 22.43 |
| 24.18 |
| 24.53 |

| List price per sheet € |
|---------------------------|
| 20.12 |
| 21.18 |
| 23.32 |
| 24.90 |
| 29.33 |
| 34.66 |
| 38.90 |
| 39.02 |
| 40.27 |
| 41.33 |
| 52.98 |
| 55.33 |
| 62.06 |
| 64.60 |
| 69.64 |
| 70.66 |

Product **Quinnterm Perimeter Strips** Thermal bridge insulation

| Thickness mm | Lambda value w/mK | Thermal Resistance | Width mtr | Length mtr | Pieces Per bag |
|-----------------|----------------------|-----------------------|--------------|---------------|-------------------|
| 25 | 1.200 | 0.022 | 0.150 | 1.200 | 48 |

| List price per bag € |
|-------------------------|
| 102.00 |



For Trade Discounts Please Call ROI 01-8612000 NI 00353-1-8612000

For Thermal, Acoustic and Fire Safe Insulation Advice - Talk To The Insulation Experts

Quinntherm Polyisocyanurate PIR Foam - Roof Rafter Insulation

Product

Quinntherm Pitch Roof (RAFTER) Insulation

Foil faced rigid insulation board

| Thickness mm | Lambda value w/mK | Thermal Resistance | Width mtr | Length mtr | m2 Per sheet | List price m2 € | List price per sheet € |
|-----------------|----------------------|-----------------------|--------------|---------------|-----------------|--------------------|---------------------------|
| 25 | 0.022 | 1.136 | 1.200 | 2.400 | 2.88 | 6.99 | 20.12 |
| 30 | 0.022 | 1.364 | 1.200 | 2.400 | 2.88 | 7.35 | 21.18 |
| 40 | 0.022 | 1.818 | 1.200 | 2.400 | 2.88 | 8.10 | 23.32 |
| 50 | 0.022 | 2.273 | 1.200 | 2.400 | 2.88 | 8.65 | 24.90 |
| 60 | 0.022 | 2.727 | 1.200 | 2.400 | 2.88 | 10.18 | 29.33 |
| 70 | 0.022 | 3.182 | 1.200 | 2.400 | 2.88 | 12.03 | 34.66 |
| 75 | 0.022 | 3.409 | 1.200 | 2.400 | 2.88 | 13.51 | 38.90 |
| 80 | 0.022 | 3.636 | 1.200 | 2.400 | 2.88 | 13.55 | 39.02 |
| 90 | 0.022 | 4.090 | 1.200 | 2.400 | 2.88 | 13.98 | 40.27 |
| 100 | 0.022 | 4.545 | 1.200 | 2.400 | 2.88 | 14.35 | 41.33 |
| 110 | 0.022 | 5.000 | 1.200 | 2.400 | 2.88 | 18.40 | 52.98 |
| 120 | 0.022 | 5.455 | 1.200 | 2.400 | 2.88 | 19.21 | 55.33 |
| 125 | 0.022 | 5.682 | 1.200 | 2.400 | 2.88 | 21.55 | 62.06 |
| 130 | 0.022 | 5.909 | 1.200 | 2.400 | 2.88 | 22.43 | 64.60 |
| 140 | 0.022 | 6.364 | 1.200 | 2.400 | 2.88 | 24.18 | 69.64 |
| 150 | 0.022 | 6.818 | 1.200 | 2.400 | 2.88 | 24.53 | 70.66 |

Product

Quinntherm Cavity Wall Insulation

| Thickness mm | Lambda value w/mK | Thermal Resistance | Width mtr | Length mtr | m2 Per sheet | m2 Per pack | List price m2 € | List price per pack € |
|-----------------|----------------------|-----------------------|--------------|---------------|-----------------|----------------|--------------------|--------------------------|
| 60 | 0.022 | 2.727 | 1.200 | 0.450 | 0.54 | 3.78 | 10.68 | 40.36 |
| 80 | 0.022 | 3.636 | 1.200 | 0.450 | 0.54 | 2.70 | 14.36 | 38.76 |
| 100 | 0.022 | 4.545 | 1.200 | 0.450 | 0.54 | 2.16 | 17.78 | 38.40 |

Wire Wall Ties

| Length | Pcs per pack | List price per bag |
|--------|--------------|--------------------|
| 250 | 30 | 9.00 |
| 300 | 30 | 10.80 |

For Trade Discounts Please Call ROI 01-8612000 NI 00353-1-8612000

For Thermal, Acoustic and Fire Safe Insulation Advice - Talk To The Insulation Experts

Quinntherm Flat Roof Insulation

Quinntherm Foil: Mechanically Fixed Foil Faced Boards LCPB QRFR-FFR

| Thickness mm | Width mtr | Length mtr | Pieces Per pack | m2 Per Pack |
|-----------------|--------------|---------------|--------------------|----------------|
| 25 | 1.200 | 2.400 | 12 | 34.56 |
| 50 | 1.200 | 2.400 | 6 | 17.28 |
| 90 | 1.200 | 2.400 | 3 | 8.64 |
| 100 | 1.200 | 2.400 | 3 | 8.64 |
| 110 | 1.200 | 2.400 | 3 | 8.64 |
| 120 | 1.200 | 2.400 | 2 | 5.76 |
| 125 | 1.200 | 2.400 | 2 | 5.76 |

| List price m2 € |
|--------------------|
| 9.54 |
| 11.92 |
| 20.87 |
| 21.44 |
| 26.23 |
| 28.60 |
| 29.81 |

| List price per pack € |
|--------------------------|
| 329.70 |
| 205.98 |
| 180.32 |
| 185.24 |
| 226.63 |
| 164.74 |
| 171.71 |

Quinntherm Glass Tissue Faced Fully Adhered LPCB QRFR-GFR

| Thickness mm | Width mtr | Length mtr | Pieces Per pack | m2 Per Pack |
|-----------------|--------------|---------------|--------------------|----------------|
| 25 | 0.600 | 1.200 | 18 | 12.96 |
| 50 | 0.600 | 1.200 | 9 | 6.48 |
| 80 | 0.600 | 1.200 | 5 | 3.60 |
| 90 | 0.600 | 1.200 | 4 | 2.88 |
| 100 | 0.600 | 1.200 | 4 | 2.88 |
| 120 | 0.600 | 1.200 | 3 | 2.16 |
| 150 | 0.600 | 1.200 | 3 | 2.16 |

| List price m2 € |
|--------------------|
| 10.98 |
| 13.71 |
| 21.94 |
| 23.98 |
| 24.67 |
| 32.88 |
| 41.13 |

| List price per pack € |
|--------------------------|
| 142.30 |
| 88.84 |
| 78.98 |
| 69.06 |
| 71.05 |
| 71.02 |
| 88.84 |



For Trade Discounts Please Call ROI 01-8612000 NI 00353-1-8612000

For Thermal, Acoustic and Fire Safe Insulation Advice - Talk To The Insulation Experts

Quinntherm Flat Roof Insulation

Quinntherm Bitumen Fleece Faced Torch On QRFR-DFR

| Thickness mm | Width mtr | Length mtr | Pieces Per pack | m2 Per Pack |
|-----------------|--------------|---------------|--------------------|----------------|
| 25 | 0.600 | 1.200 | 18 | 12.96 |
| 50 | 0.600 | 1.200 | 9 | 6.48 |
| 90 | 0.600 | 1.200 | 4 | 2.88 |
| 100 | 0.600 | 1.200 | 4 | 2.88 |
| 120 | 0.600 | 1.200 | 3 | 2.16 |
| 140 | 0.600 | 1.200 | 3 | 2.16 |

| List price m2 € | List price per pack € |
|--------------------|--------------------------|
| 13.58 | 176.00 |
| 15.63 | 101.28 |
| 25.90 | 74.59 |
| 26.60 | 76.61 |
| 34.81 | 75.19 |
| 40.31 | 87.07 |

Quinntherm Plydeck - PIR - Bonded to 6mm WBP Plywood QFR-PLY

| Thickness mm | Width mtr | Length mtr | m2 Per sheet |
|-----------------|--------------|---------------|-----------------|
| 56 | 1.200 | 2.400 | 2.88 |
| 76 | 1.200 | 2.400 | 2.88 |
| 96 | 1.200 | 2.400 | 2.88 |
| 116 | 1.200 | 2.400 | 2.88 |
| 131 | 1.200 | 2.400 | 2.88 |

| List price m2 € | List price per sheet € |
|--------------------|---------------------------|
| 28.09 | 80.90 |
| 31.86 | 91.75 |
| 38.28 | 110.26 |
| 42.62 | 122.74 |
| 46.17 | 132.97 |

Overall thickness includes 6mm WBP Plywood



For Trade Discounts Please Call ROI 01-8612000 NI 00353-1-8612000

For Thermal, Acoustic and Fire Safe Insulation Advice - Talk To The Insulation Experts

Kingspan Polyisocyanurate Foam PIR - Roof Rafter, Wall and Floor Insulation

Product

Kingspan TP10 - TF70 - TW55

Foil faced rigid insulation board

| Thickness mm | Lambda value w/mK | Thermal Resistance | Width mtr | Length mtr | m2 Per sheet |
|-----------------|----------------------|-----------------------|--------------|---------------|-----------------|
| 25 | 0.022 | 1.136 | 1.200 | 2.400 | 2.88 |
| 30 | 0.022 | 1.364 | 1.200 | 2.400 | 2.88 |
| 35 | 0.022 | 1.591 | 1.200 | 2.400 | 2.88 |
| 40 | 0.022 | 1.818 | 1.200 | 2.400 | 2.88 |
| 50 | 0.022 | 2.273 | 1.200 | 2.400 | 2.88 |
| 60 | 0.022 | 2.727 | 1.200 | 2.400 | 2.88 |
| 65 | 0.022 | 2.955 | 1.200 | 2.400 | 2.88 |
| 70 | 0.022 | 3.182 | 1.200 | 2.400 | 2.88 |
| 75 | 0.022 | 3.409 | 1.200 | 2.400 | 2.88 |
| 80 | 0.022 | 3.636 | 1.200 | 2.400 | 2.88 |
| 90 | 0.022 | 4.090 | 1.200 | 2.400 | 2.88 |
| 100 | 0.022 | 4.545 | 1.200 | 2.400 | 2.88 |
| 125 | 0.022 | 5.682 | 1.200 | 2.400 | 2.88 |
| 150 | 0.022 | 6.818 | 1.200 | 2.400 | 2.88 |

| List price m2 € | List price per sheet € |
|--------------------|---------------------------|
| 8.00 | 23.04 |
| 8.22 | 23.67 |
| 8.59 | 24.74 |
| 8.04 | 23.16 |
| 8.96 | 25.80 |
| 11.68 | 33.64 |
| 12.66 | 36.46 |
| 13.53 | 38.97 |
| 14.46 | 41.64 |
| 15.34 | 44.18 |
| 16.08 | 46.31 |
| 16.82 | 48.44 |
| 23.14 | 66.64 |
| 27.65 | 79.63 |



For Trade Discounts Please Call ROI 01-8612000 NI 00353-1-8612000

For Thermal, Acoustic and Fire Safe Insulation Advice - Talk To The Insulation Experts

Kingspan Polyisocyanurate Foam PIR - Flat Roof Insulation

Product **Kingspan TR27 FM Glass Tissue Faced Roof Board** (40mm/90mm thickness available to order)

| Thickness (mm) | Width (mtr) | Length (mtr) | m2 Per sheet |
|-------------------|----------------|-----------------|-----------------|
| 60 | 1.200 | 1.200 | 1.44 |
| 70 | 1.200 | 1.200 | 1.44 |
| 80 | 1.200 | 1.200 | 1.44 |
| 100 | 1.200 | 1.200 | 1.44 |
| 110 | 1.200 | 1.200 | 1.44 |
| 120 | 1.200 | 1.200 | 1.44 |

| List price m2 € | List price per sheet € |
|--------------------|---------------------------|
| 16.82 | 24.22 |
| 18.49 | 26.62 |
| 21.12 | 30.41 |
| 26.40 | 38.01 |
| 29.05 | 41.83 |
| 31.68 | 45.62 |

Product **Kingspan TR26 FM Foil Faced Roof Board** (25, 30, 40 and 50mm also available)

| Thickness (mm) | Width (mtr) | Length (mtr) | m2 Per sheet |
|-------------------|----------------|-----------------|-----------------|
| 60 | 1.200 | 2.400 | 2.88 |
| 70 | 1.200 | 2.400 | 2.88 |
| 80 | 1.200 | 2.400 | 2.88 |
| 90 | 1.200 | 2.400 | 2.88 |
| 100 | 1.200 | 2.400 | 2.88 |
| 110 | 1.200 | 2.400 | 2.88 |
| 120 | 1.200 | 2.400 | 2.88 |

| List price m2 € | List price per sheet € |
|--------------------|---------------------------|
| 16.82 | 48.44 |
| 18.49 | 53.24 |
| 21.12 | 60.82 |
| 23.59 | 67.95 |
| 26.40 | 76.04 |
| 29.05 | 83.66 |
| 31.71 | 91.32 |

Product **Kingspan TR31 Foil Faced Roof Board + 6mm Plywood**

| Thickness (mm) | Width (mtr) | Length (mtr) | m2 Per sheet |
|-------------------|----------------|-----------------|-----------------|
| 25+6 | 1.200 | 2.400 | 2.88 |
| 30+6 | 1.200 | 2.400 | 2.88 |
| 40+6 | 1.200 | 2.400 | 2.88 |
| 50+6 | 1.200 | 2.400 | 2.88 |
| 60+6 | 1.200 | 2.400 | 2.88 |
| 70+6 | 1.200 | 2.400 | 2.88 |
| 80+6 | 1.200 | 2.400 | 2.88 |

| List price m2 € | List price per sheet € |
|--------------------|---------------------------|
| 27.49 | 79.16 |
| 28.36 | 81.67 |
| 29.51 | 84.99 |
| 32.09 | 92.41 |
| 34.85 | 100.36 |
| 37.07 | 106.76 |
| 39.22 | 112.94 |

For Trade Discounts Please Call ROI 01-8612000 NI 00353-1-8612000

For Thermal, Acoustic and Fire Safe Insulation Advice - Talk To The Insulation Experts

Kooltherm Insulation K7 & K8

Kooltherm K7 Roof Rafter Insulation

| Thickness (mm) | Lambda value w/mK | Thermal Resistance | Width (mtr) | Length (mtr) | Pieces/ Pack | m2 Per sheet | List price m2 € | List price per sheet € |
|----------------|-------------------|--------------------|-------------|--------------|--------------|--------------|-----------------|------------------------|
| 50 | 0.020 | 2.50 | 1.200 | 2.400 | 6 | 2.88 | 22.28 | 64.17 |
| 60 | 0.020 | 3.00 | 1.200 | 2.400 | 5 | 2.88 | 25.09 | 72.26 |
| 70 | 0.020 | 3.50 | 1.200 | 2.400 | 4 | 2.88 | 27.86 | 80.24 |
| 80 | 0.020 | 4.00 | 1.200 | 2.400 | 4 | 2.88 | 30.93 | 89.08 |
| 90 | 0.020 | 4.50 | 1.200 | 2.400 | 3 | 2.88 | 34.00 | 97.92 |
| 100 | 0.020 | 5.00 | 1.200 | 2.400 | 3 | 2.88 | 37.21 | 107.16 |
| 120 | 0.020 | 6.00 | 1.200 | 2.400 | 2 | 2.88 | 43.48 | 125.22 |
| 130 | 0.020 | 6.50 | 1.200 | 2.400 | 2 | 2.88 | 46.66 | 134.38 |
| 140 | 0.020 | 7.00 | 1.200 | 2.400 | 2 | 2.88 | 49.68 | 143.08 |

Kooltherm K8 Cavity Wall Insulation

| Thickness (mm) | Lambda value w/mK | Thermal Resistance | Width (mtr) | Length (mtr) | Pieces/ Pack | m2 Per sheet | List price m2 € | List price per pack € |
|----------------|-------------------|--------------------|-------------|--------------|--------------|--------------|-----------------|-----------------------|
| 50 | 0.020 | 2.50 | 1.200 | 0.450 | 10 | 0.54 | 22.50 | 121.50 |
| 60 | 0.020 | 3.00 | 1.200 | 0.450 | 8 | 0.54 | 25.63 | 110.72 |
| 70 | 0.020 | 3.50 | 1.200 | 0.450 | 6 | 0.54 | 28.52 | 92.40 |
| 80 | 0.020 | 4.00 | 1.200 | 0.450 | 6 | 0.54 | 30.93 | 100.21 |
| 90 | 0.020 | 4.50 | 1.200 | 0.450 | 4 | 0.54 | 34.01 | 73.46 |
| 100 | 0.020 | 5.00 | 1.200 | 0.450 | 5 | 0.54 | 37.21 | 100.47 |
| 110 | 0.020 | 5.50 | 1.200 | 0.450 | 5 | 0.54 | 40.88 | 110.38 |

Product

Kingspan Cavity Closer

| Width (mm) | Length (mtr) | Lengths per Pack | Lm per Pack | List price length € | List price per pack € |
|------------|--------------|------------------|-------------|---------------------|-----------------------|
| 100 | 2.400 | 10 | 24 | 15.82 | 158.20 |
| 125 | 2.400 | 10 | 24 | 20.35 | 203.50 |
| 150 | 2.400 | 10 | 24 | 24.87 | 248.70 |

| | |
|--------------------------|-----------------|
| Cavity closer fixing tie | 100 Pcs per box |
|--------------------------|-----------------|

| |
|-----------------------------|
| € List price per box |
| 60.00 |

For Trade Discounts Please Call ROI 01-8612000 NI 00353-1-8612000

Kooltherm Insulation K3 & K5

Kooltherm K3 Floor Insulation

| Thickness (mm) | Lambda value w/mK | Thermal Resistance | Width (mtr) | Length (mtr) | Pieces/ Pack | m2 Per sheet | List price m2 € | List price per sheet € |
|----------------|-------------------|--------------------|-------------|--------------|--------------|--------------|-----------------|------------------------|
| 25 | 0.021 | 1.19 | 1.200 | 2.400 | 12 | 2.88 | 12.11 | 34.88 |
| 30 | 0.021 | 1.43 | 1.200 | 2.400 | 10 | 2.88 | 14.54 | 41.88 |
| 40 | 0.021 | 1.90 | 1.200 | 2.400 | 8 | 2.88 | 18.58 | 53.51 |
| 50 | 0.020 | 2.50 | 1.200 | 2.400 | 6 | 2.88 | 22.28 | 64.17 |
| 60 | 0.020 | 3.00 | 1.200 | 2.400 | 5 | 2.88 | 25.09 | 72.26 |
| 70 | 0.020 | 3.50 | 1.200 | 2.400 | 4 | 2.88 | 27.86 | 80.24 |
| 80 | 0.020 | 4.00 | 1.200 | 2.400 | 4 | 2.88 | 30.93 | 89.08 |
| 90 | 0.020 | 4.50 | 1.200 | 2.400 | 3 | 2.88 | 34.00 | 97.92 |
| 100 | 0.020 | 5.00 | 1.200 | 2.400 | 3 | 2.88 | 37.21 | 107.16 |
| 120 | 0.020 | 6.00 | 1.200 | 2.400 | 2 | 2.88 | 43.48 | 125.22 |
| 130 | 0.020 | 6.50 | 1.200 | 2.400 | 2 | 2.88 | 46.66 | 134.38 |
| 140 | 0.020 | 7.00 | 1.200 | 2.400 | 2 | 2.88 | 49.68 | 143.08 |

Perimeter strips available

| Thickness mm | Length | Depth | Pcs per pack |
|--------------|--------|-------|--------------|
| 30 | 2.400 | 150mm | 25 |

List price per pack

152.75

Kooltherm K5 - EWI External Wall Insulation

| Thickness (mm) | Lambda value w/mK | Thermal Resistance | Width (mtr) | Length (mtr) | Pieces/ Pack | m2 Per sheet | List price m2 € | List price per pack € |
|----------------|-------------------|--------------------|-------------|--------------|--------------|--------------|-----------------|-----------------------|
| 20 | 0.023 | 0.95 | 1.200 | 0.600 | 25 | 0.72 | 10.58 | 190.44 |
| 30 | 0.021 | 1.43 | 1.200 | 0.600 | 16 | 0.72 | 13.84 | 159.44 |
| 40 | 0.021 | 1.90 | 1.200 | 0.600 | 12 | 0.72 | 17.09 | 147.66 |
| 50 | 0.020 | 2.50 | 1.200 | 0.600 | 10 | 0.72 | 20.41 | 146.95 |
| 60 | 0.020 | 3.00 | 1.200 | 0.600 | 8 | 0.72 | 23.75 | 136.80 |
| 70 | 0.020 | 3.50 | 1.200 | 0.600 | 6 | 0.72 | 27.14 | 117.24 |
| 80 | 0.020 | 4.00 | 1.200 | 0.600 | 6 | 0.72 | 30.46 | 131.59 |
| 90 | 0.020 | 4.50 | 1.200 | 0.600 | 4 | 0.72 | 33.93 | 97.72 |
| 100 | 0.020 | 5.00 | 1.200 | 0.600 | 5 | 0.72 | 37.16 | 133.78 |

For Trade Discounts Please Call ROI 01-8612000 NI 00353-1-8612000

For Thermal, Acoustic and Fire Safe Insulation Advice - Talk To The Insulation Experts

Kooltherm Insulation K10 & K12

Kooltherm K10 Soffit Liner Board

| Thickness (mm) | Lambda value w/mK | Thermal Resistance | Width (mtr) | Length (mtr) | Pieces/ Pack | m2 Per sheet | List price m2 € | List price per pack € |
|----------------|-------------------|--------------------|-------------|--------------|--------------|--------------|-----------------|-----------------------|
| 30 | 0.021 | 1.43 | 1.200 | 2.400 | 10 | 2.88 | 18.07 | 520.42 |
| 40 | 0.021 | 1.90 | 1.200 | 2.400 | 8 | 2.88 | 21.65 | 498.82 |
| 50 | 0.020 | 2.50 | 1.200 | 2.400 | 6 | 2.88 | 27.37 | 472.95 |
| 60 | 0.020 | 3.00 | 1.200 | 2.400 | 5 | 2.88 | 29.74 | 428.26 |
| 70 | 0.020 | 3.50 | 1.200 | 2.400 | 4 | 2.88 | 35.87 | 413.22 |
| 80 | 0.020 | 4.00 | 1.200 | 2.400 | 4 | 2.88 | 38.95 | 448.70 |
| 90 | 0.020 | 4.50 | 1.200 | 2.400 | 3 | 2.88 | 42.74 | 369.27 |
| 100 | 0.020 | 5.00 | 1.200 | 2.400 | 3 | 2.88 | 46.57 | 402.36 |

K10 Plus: Price available on request.

Kooltherm K10 bonded to 6mm calcium silicate board

Kooltherm K12 Timber Frame Wall Insulation

| Thickness (mm) | Lambda value w/mK | Thermal Resistance | Width (mtr) | Length (mtr) | Pieces/ Pack | m2 Per sheet | List price m2 € | List price per pack € |
|----------------|-------------------|--------------------|-------------|--------------|--------------|--------------|-----------------|-----------------------|
| 30 | 0.021 | 1.43 | 1.200 | 2.400 | 10 | 2.88 | 14.86 | 427.97 |
| 40 | 0.021 | 1.90 | 1.200 | 2.400 | 8 | 2.88 | 19.43 | 447.67 |
| 50 | 0.020 | 2.50 | 1.200 | 2.400 | 6 | 2.88 | 22.44 | 387.76 |
| 60 | 0.020 | 3.00 | 1.200 | 2.400 | 5 | 2.88 | 25.09 | 361.30 |
| 70 | 0.020 | 3.50 | 1.200 | 2.400 | 4 | 2.88 | 28.90 | 332.93 |
| 80 | 0.020 | 4.00 | 1.200 | 2.400 | 4 | 2.88 | 30.93 | 356.31 |
| 90 | 0.020 | 4.50 | 1.200 | 2.400 | 3 | 2.88 | 34.00 | 293.76 |
| 100 | 0.020 | 5.00 | 1.200 | 2.400 | 3 | 2.88 | 37.21 | 321.49 |
| 120 | 0.020 | 6.00 | 1.200 | 2.400 | 2 | 2.88 | 43.48 | 250.44 |
| 130 | 0.020 | 6.50 | 1.200 | 2.400 | 2 | 2.88 | 46.66 | 268.76 |
| 140 | 0.020 | 7.00 | 1.200 | 2.400 | 2 | 2.88 | 49.68 | 286.16 |



For Trade Discounts Please Call ROI 01-8612000 NI 00353-1-8612000

For Thermal, Acoustic and Fire Safe Insulation Advice - Talk To The Insulation Experts

Kooltherm Insulation K15 & K16

Kooltherm K15 Rain Screen Insulation Board

| Thickness (mm) | Lambda value w/mK | Thermal Resistance | Width (mtr) | Length (mtr) | Pieces/ Pack | m2 Per sheet | List price m2 € | List price per pack € |
|-------------------|----------------------|-----------------------|----------------|-----------------|-----------------|-----------------|--------------------|--------------------------|
| 50 | 0.020 | 2.500 | 1.200 | 2.400 | 6 | 2.88 | 25.61 | 442.54 |
| 60 | 0.020 | 3.000 | 1.200 | 2.400 | 5 | 2.88 | 28.00 | 403.20 |
| 70 | 0.020 | 3.500 | 1.200 | 2.400 | 4 | 2.88 | 31.05 | 357.70 |
| 80 | 0.020 | 4.000 | 1.200 | 2.400 | 4 | 2.88 | 35.38 | 407.58 |
| 90 | 0.020 | 4.500 | 1.200 | 2.400 | 3 | 2.88 | 39.85 | 344.30 |
| 100 | 0.020 | 5.000 | 1.200 | 2.400 | 3 | 2.88 | 42.81 | 369.88 |

Kooltherm K16 Insulated Plasterboards Kraft Paper Facing

| Thickness (mm) | Thermal Resistance | Width (mtr) | Length (mtr) | m2 Per sheet | List price m2 € | List price per sheet € |
|-------------------|-----------------------|----------------|-----------------|-----------------|--------------------|---------------------------|
| 37.5 | 1.25 | 1.200 | 2.400 | 2.88 | 18.11 | 52.17 |
| 42.5 | 1.45 | 1.200 | 2.400 | 2.88 | 19.86 | 57.20 |
| 52.5 | 1.95 | 1.200 | 2.400 | 2.88 | 22.59 | 65.07 |
| 62.5 | 2.55 | 1.200 | 2.400 | 2.88 | 21.80 | 62.79 |
| 72.5 | 3.05 | 1.200 | 2.400 | 2.88 | 27.81 | 80.09 |
| 82.5 | 3.55 | 1.200 | 2.400 | 2.88 | 32.16 | 92.61 |
| 92.5 | 4.05 | 1.200 | 2.400 | 2.88 | 35.94 | 103.50 |
| 102.5 | 4.56 | 1.200 | 2.400 | 2.88 | 38.95 | 112.19 |
| 112.5 | 5.06 | 1.200 | 2.400 | 2.88 | 41.25 | 118.80 |

Insulated plasterboard - Dot and dab application



For Trade Discounts Please Call ROI 01-8612000 NI 00353-1-8612000

For Thermal, Acoustic and Fire Safe Insulation Advice - Talk To The Insulation Experts

Kooltherm Insulation K17 & K18

Kooltherm K17 Insulated Plasterboards Tissue Faced

| Thickness (mm) | Thermal Resistance | Width (mtr) | Length (mtr) | m2 Per sheet |
|----------------|--------------------|-------------|--------------|--------------|
| 37.5 | 1.25 | 1.200 | 2.400 | 2.88 |
| 42.5 | 1.45 | 1.200 | 2.400 | 2.88 |
| 52.5 | 1.95 | 1.200 | 2.400 | 2.88 |
| 62.5 | 2.55 | 1.200 | 2.400 | 2.88 |
| 72.5 | 3.05 | 1.200 | 2.400 | 2.88 |
| 82.5 | 3.55 | 1.200 | 2.400 | 2.88 |
| 92.5 | 4.05 | 1.200 | 2.400 | 2.88 |
| 102.5 | 4.56 | 1.200 | 2.400 | 2.88 |
| 112.5 | 5.06 | 1.200 | 2.400 | 2.88 |

| List price m2 € | List price per sheet € |
|--------------------|---------------------------|
| 18.11 | 52.17 |
| 19.86 | 57.20 |
| 22.59 | 65.07 |
| 21.80 | 62.79 |
| 27.81 | 80.09 |
| 32.16 | 92.61 |
| 35.94 | 103.50 |
| 38.95 | 112.19 |
| 41.25 | 118.80 |

Insulated plasterboard - Dot and dab application

Kooltherm K18 Insulated Plasterboards Composite Foil Facing

| Thickness (mm) | Thermal Resistance | Width (mtr) | Length (mtr) | m2 Per sheet |
|----------------|--------------------|-------------|--------------|--------------|
| 37.5 | 1.25 | 1.200 | 2.400 | 2.88 |
| 42.5 | 1.45 | 1.200 | 2.400 | 2.88 |
| 52.5 | 1.95 | 1.200 | 2.400 | 2.88 |
| 62.5 | 2.55 | 1.200 | 2.400 | 2.88 |
| 72.5 | 3.05 | 1.200 | 2.400 | 2.88 |
| 82.5 | 3.55 | 1.200 | 2.400 | 2.88 |
| 92.5 | 4.05 | 1.200 | 2.400 | 2.88 |
| 102.5 | 4.56 | 1.200 | 2.400 | 2.88 |
| 112.5 | 5.06 | 1.200 | 2.400 | 2.88 |

| List price m2 € | List price per sheet € |
|--------------------|---------------------------|
| 18.11 | 52.17 |
| 19.86 | 57.20 |
| 22.59 | 65.07 |
| 21.80 | 62.79 |
| 27.81 | 80.09 |
| 32.16 | 92.61 |
| 35.94 | 103.50 |
| 38.95 | 112.19 |
| 41.25 | 118.80 |

Insulated plasterboard - Mechanically fixed application



For Trade Discounts Please Call ROI 01-8612000 NI 00353-1-8612000

For Thermal, Acoustic and Fire Safe Insulation Advice - Talk To The Insulation Experts

Resistant Building Products

A1 Non Combustable Building Boards

Product

Multi Pro General Purpose Boards

| Thickness (mm) | Length (mtr) | Width (mtr) | Board Edge | Area/ m2 Per sheet |
|-------------------|-----------------|----------------|---------------|-----------------------|
| 3 | 2.440 | 1.200 | Square | 2.93 |
| 6 | 2.440 | 1.200 | Square | 2.93 |
| 6 | 2.400 | 1.200 | Square | 2.88 |
| 9 | 2.400 | 1.200 | Square | 2.88 |
| 12 | 2.400 | 1.200 | Square | 2.88 |
| 6 | 2.400 | 1.200 | Tapered | 2.88 |
| 9 | 2.400 | 1.200 | Tapered | 2.88 |

List price per sheet

€

14.31

25.64

25.64

34.16

50.88

25.64

34.16

Product

Multi Pro XS Extra Strength Boards

(Behind stoves)

| Thickness (mm) | Length (mtr) | Width (mtr) | Board Edge | m2 Per sheet |
|-------------------|-----------------|----------------|---------------|-----------------|
| 9 | 2.400 | 1.200 | Square | 2.88 |
| 9 | 3.050 | 1.200 | Square | 3.66 |
| 12 | 2.400 | 1.200 | Square | 2.88 |

List price per sheet

€

39.70

53.51

64.83

Product

Render Pro - Approved Render Carrier (Timber frame walls and Dormer cheeks)

| Thickness (mm) | Length (mtr) | Width (mtr) | Board Edge | m2 Per sheet |
|-------------------|-----------------|----------------|---------------|-----------------|
| 9 | 2.400 | 1.200 | Square | 2.88 |
| 12 | 3.050 | 1.200 | Square | 3.66 |

List price per sheet

€

38.90

55.04

Product

Tile Backer boards for walls and floors

| Thickness (mm) | Length (mtr) | Width (mtr) | Board Edge | m2 Per sheet |
|-------------------|-----------------|----------------|---------------|-----------------|
| 12 | 1.200 | 0.800 | Square | 0.96 |
| 6 | 1.220 | 1.200 | Square | 1.46 |
| 6 | 1.195 | 0.590 | Square | 0.705 |

List price per sheet

€

16.56

14.12

6.45

For Trade Discounts Please Call ROI 01-8612000 NI 00353-1-8612000

For Thermal, Acoustic and Fire Safe Insulation Advice - Talk To The Insulation Experts

Resistant Building Products

Product **Base Board 10** General purpose building board

| Thickness (mm) | Length (mtr) | Width (mtr) | Board Edge | m2 Per sheet |
|-------------------|-----------------|----------------|---------------|-----------------|
| 10 | 2.400 | 1.200 | Square | 2.88 |

| List price per sheet € |
|---------------------------|
| 40.84 |

Product **Soffit Strip** Non combustable board

| Thickness (mm) | Length (mtr) | Width (mtr) | Board Edge |
|-------------------|-----------------|----------------|---------------|
| 4 | 2.440 | 0.150 | Square |
| 9 | 2.400 | 0.200 | Square |
| 4 | 2.440 | 0.300 | Square |

| List price per sheet € |
|---------------------------|
| 2.12 |
| 1.83 |
| 4.24 |

A1 Non Combustable Building Boards



For Trade Discounts Please Call ROI 01-8612000 NI 00353-1-8612000

For Thermal, Acoustic and Fire Safe Insulation Advice - Talk To The Insulation Experts

Plain Plasterboard

9.5mm Tapered Edge Wallboard

| Product | Thickness (mm) | Length (mtr) | Width (mtr) | Board Edge | m2 Per sheet |
|---------|-------------------|-----------------|----------------|---------------|-----------------|
| | 9.5 | 2.438 | 1.200 | Tapered | 2.92 |

| List price m2 € | List price per sheet € |
|--------------------|---------------------------|
| 2.74 | 8.00 |

12.5mm Tapered Edge Wallboard

| Product | Thickness (mm) | Length (mtr) | Width (mtr) | Board Edge | m2 Per sheet |
|---------|-------------------|-----------------|----------------|---------------|-----------------|
| | 12.5 | 2.438 | 1.200 | Tapered | 2.93 |
| | 12.5 | 2.700 | 1.200 | Tapered | 3.24 |
| | 12.5 | 3.000 | 1.200 | Tapered | 3.60 |

| List price m2 € | List price per sheet € |
|--------------------|---------------------------|
| 2.92 | 8.54 |
| 2.92 | 9.46 |
| 2.92 | 10.51 |

15mm Tapered Edge Wallboard

| Product | Thickness (mm) | Length (mtr) | Width (mtr) | Board Edge | m2 Per sheet |
|---------|-------------------|-----------------|----------------|---------------|-----------------|
| | 15 | 2.400 | 1.200 | Tapered | 2.88 |

| List price m2 € | List price per sheet € |
|--------------------|---------------------------|
| 3.73 | 10.73 |

12.5mm Tapered Edge Wallboard (Foil Backed)

| Product | Thickness (mm) | Length (mtr) | Width (mtr) | Board Edge | m2 Per sheet |
|---------|-------------------|-----------------|----------------|---------------|-----------------|
| | 12.5 | 2.438 | 1.200 | Tapered | 2.93 |
| | 12.5 | 2.700 | 1.200 | Tapered | 3.24 |

| List price m2 € | List price per sheet € |
|--------------------|---------------------------|
| 3.87 | 11.33 |
| 3.87 | 12.60 |

For Trade Discounts Please Call ROI 01-8612000 NI 00353-1-8612000

For Thermal, Acoustic and Fire Safe Insulation Advice - Talk To The Insulation Experts

Fire Protection Plasterboards

12.5mm Tapered Edge (FIRE)

| Product | Thickness (mm) | Length (mtr) | Width (mtr) | Board Edge | m2 Per sheet |
|---------|----------------|--------------|-------------|------------|--------------|
| | 12.5 | 2.400 | 1.200 | Tapered | 2.88 |
| | 12.5 | 2.700 | 1.200 | Tapered | 3.24 |
| | 12.5 | 3.000 | 1.200 | Tapered | 3.60 |

| List price m2 | List price per sheet |
|---------------|----------------------|
| € | € |
| 4.58 | 13.19 |
| 4.58 | 14.84 |
| 4.58 | 16.49 |

15mm Tapered Edge (FIRE)

| Product | Thickness (mm) | Length (mm) | Width (mm) | Board Edge | m2 Per sheet |
|---------|----------------|-------------|------------|------------|--------------|
| | 15 | 2.400 | 1.200 | Tapered | 2.88 |
| | 15 | 2.700 | 1.200 | Tapered | 3.24 |

| List price m2 | List price per sheet |
|---------------|----------------------|
| € | € |
| 5.80 | 16.70 |
| 5.80 | 18.79 |

Sound Protection Plasterboard

12.5mm Tapered Edge (Sound)

| Product | Thickness (mm) | Length (mm) | Width (mm) | Board Edge | m2 Per sheet |
|---------|----------------|-------------|------------|------------|--------------|
| | 12.5 | 2.400 | 1.200 | Tapered | 2.88 |
| | 12.5 | 2.700 | 1.200 | Tapered | 3.24 |

| List price m2 | List price per sheet |
|---------------|----------------------|
| € | € |
| 4.86 | 14.00 |
| 4.86 | 15.75 |

15.5mm Tapered Edge (Sound)

| Product | Thickness (mm) | Length (mtr) | Width (mtr) | Board Edge | m2 Per sheet |
|---------|----------------|--------------|-------------|------------|--------------|
| | 15 | 2.400 | 1.200 | Tapered | 2.88 |
| | 15 | 2.700 | 1.200 | Tapered | 3.24 |

| List price m2 | List price per sheet |
|---------------|----------------------|
| € | € |
| 6.01 | 17.31 |
| 6.01 | 19.47 |

| |
|--------------------|
| Acoustic Mastic |
| Putty Pads |
| Intumescent mastic |

For Trade Discounts Please Call ROI 01-8612000 NI 00353-1-8612000

Moisture Resistant Plasterboard

12.5mm Tapered Edge Moisture Resistant Board

| Product | Thickness (mm) | Length (mtr) | Width (mtr) | Board Edge | m2 Per sheet |
|---------|-------------------|-----------------|----------------|---------------|-----------------|
| | 12.5 | 2.400 | 1.200 | Tapered | 2.88 |
| | 12.5 | 2.700 | 1.200 | Tapered | 3.24 |

| List price m2 € | List price per sheet € |
|--------------------|---------------------------|
| 5.47 | 15.75 |
| 5.47 | 17.72 |

DURALINE - HEAVY DUTY PLASTERBOARD

13.5mm Tapered Edge Duraline Board

| Product | Thickness (mm) | Length (mtr) | Width (mtr) | Board Edge | m2 Per sheet |
|---------|-------------------|-----------------|----------------|---------------|-----------------|
| | 13.5 | 2.400 | 1.200 | Tapered | 2.88 |
| | 13.5 | 2.700 | 1.200 | Tapered | 3.24 |
| | 13.5 | 3.000 | 1.200 | Tapered | 3.60 |

| List price m2 € | List price per sheet € |
|--------------------|---------------------------|
| 6.42 | 18.49 |
| 6.42 | 20.80 |
| 6.42 | 23.11 |

15mm Tapered Edge Duraline Board

| Product | Thickness (mm) | Length (mtr) | Width (mtr) | Board Edge | m2 Per sheet |
|---------|-------------------|-----------------|----------------|---------------|-----------------|
| | 15 | 2.400 | 1.200 | Tapered | 2.88 |
| | 15 | 2.700 | 1.200 | Tapered | 3.24 |
| | 15 | 3.000 | 1.200 | Tapered | 3.60 |

| List price m2 € | List price per sheet € |
|--------------------|---------------------------|
| 7.19 | 20.71 |
| 7.19 | 23.30 |
| 7.19 | 25.88 |

For Trade Discounts Please Call ROI 01-8612000 NI 00353-1-8612000

For Thermal, Acoustic and Fire Safe Insulation Advice - Talk To The Insulation Experts

Tile Backer Boards - Aqua Panel Interior and Exterior Cement Boards - Fermacell Boards

Product Gyproc Tile Backer Board - Glassroc H

| Thickness (mm) | Length (mtr) | Width (mtr) | Board Edge | m2 Per sheet |
|----------------|--------------|-------------|------------|--------------|
| 6 | 0.900 | 1.200 | Square | 1.08 |
| 6 | 2.400 | 1.200 | Square | 2.88 |
| 12.5 | 0.900 | 1.200 | Square | 1.08 |
| 12.5 | 2.400 | 1.200 | Square | 2.88 |

| List price m2 |
|---------------|
| € |
| 4.48 |
| 4.48 |
| 6.05 |
| 6.05 |

| List price per sheet |
|----------------------|
| € |
| 16.44 |
| 37.83 |
| 22.20 |
| 47.68 |

Product Knauf Aquapanel Exterior and Interior Cement Board

| Thickness (mm) | Length (mtr) | Width (mtr) | Board Edge | m2 Per sheet |
|----------------|--------------|-------------|------------|--------------|
| 12.5 | 1.200 | 0.900 | Square | 1.08 |
| 12.5 | 2.400 | 0.900 | Square | 2.16 |

| List price m2 |
|---------------|
| € |
| 23.46 |
| 23.46 |

| List price per sheet |
|----------------------|
| € |
| 25.34 |
| 50.68 |

| Thickness (mm) | Length (mtr) | Width (mtr) | Board Edge | m2 Per sheet |
|----------------|--------------|-------------|------------|--------------|
| 12.5 | 1.200 | 0.900 | Square | 1.08 |
| 12.5 | 2.400 | 0.900 | Square | 2.16 |

| List price m2 |
|---------------|
| € |
| 20.74 |
| 20.74 |

| List price per sheet |
|----------------------|
| € |
| 22.40 |
| 44.79 |

Product Fermacell Boards

| Thickness mm | Length mtr | Width mtr | Board Edge | m2 Per sheet | Sheets Per pallet |
|--------------|------------|-----------|------------|--------------|-------------------|
| 10mm | 1.200 | 1.200 | Staight | 1.44 | 60 |
| 10mm | 2400 | 1.200 | Tapered | 2.88 | 60 |
| 12mm | 2400 | 1.200 | Straight | 2.88 | 48 |
| 12mm | 2400 | 1.200 | Tapered | 2.88 | 48 |
| 15mm | 2400 | 1.200 | Straight | 2.88 | 40 |
| 15mm | 2400 | 1.200 | Tapered | 2.88 | 40 |
| 18mm | 2400 | 1.200 | Straight | 2.88 | 40 |

| List price per m2 |
|-------------------|
| € |
| 18.06 |
| 18.06 |
| 21.94 |
| 21.94 |
| 28.58 |
| 28.58 |
| 34.18 |

| List price per sheet |
|----------------------|
| € |
| 26.01 |
| 52.01 |
| 63.19 |
| 63.19 |
| 82.31 |
| 82.31 |
| 98.44 |

| Accessories | Length mm | Tube ml | Pcs per box | Ltr per drum |
|-----------------|-----------|---------|-------------|--------------|
| Joint stick | | 310 | | |
| FST Adhesive | | | | 10 |
| Fermacel screws | 30/39 | | 1000 | |

| List price each |
|-----------------|
| 8.85 |
| 70.85 |
| 39.00 |

For Trade Discounts Please Call ROI 01-8612000 NI 00353-1-8612000

Drywall - Metal Stud & Track

| Product | | | | | |
|---------|---------------------|---------------|-------------------|--------------------|-------------------------|
| | 50mm C Studs | | | | |
| | Stud (mm) | Metal Stud | Length lin mtr | Pieces per Pack | List price 1m € |
| | 50mm | Stud | 2.400 | 10 | 1.15 |
| | 50mm | Stud | 2.700 | 10 | 1.15 |
| | 50mm | Stud | 3.000 | 10 | 1.15 |
| | 50mm | Stud | 3.600 | 10 | 1.15 |
| | 52 Track | TRACK | 3.000 | 10 | 1.19 |
| | | | | | List price per len € |
| | | | | | 2.76 |
| | | | | | 3.11 |
| | | | | | 3.45 |
| | | | | | 4.14 |
| | | | | | 3.57 |
| | 70mm C Studs | | | | |
| | Stud Type | Metal Stud | Length lin mtr | Pieces per Pack | List price 1m € |
| | 70mm | Stud | 2.400 | 10 | 1.49 |
| | 70mm | Stud | 2.700 | 10 | 1.49 |
| | 70mm | Stud | 3.000 | 10 | 1.49 |
| | 70mm | Stud | 3.600 | 10 | 1.49 |
| | 70mm | Stud | 4.200 | 10 | 1.49 |
| | 72 Track | TRACK | 3.000 | 10 | 1.36 |
| | | | | | List price per len € |
| | | | | | 3.58 |
| | | | | | 4.02 |
| | | | | | 4.47 |
| | | | | | 5.36 |
| | | | | | 6.26 |
| | | | | | 4.08 |
| | 92mm C Studs | | | | |
| | Stud Type | Metal Stud | Length lin mtr | Pieces per Pack | List price 1m € |
| | 92mm | Stud | 2.700 | 10 | 2.00 |
| | 92mm | Stud | 3.000 | 10 | 2.00 |
| | 92mm | Stud | 3.600 | 10 | 2.00 |
| | 92mm | Stud | 4.200 | 10 | 2.00 |
| | 94 Track | TRACK | 3.000 | 10 | 2.65 |
| | | | | | List price per len € |
| | | | | | 5.40 |
| | | | | | 6.00 |
| | | | | | 7.20 |
| | | | | | 8.40 |
| | | | | | 7.95 |



For Trade Discounts Please Call ROI 01-8612000 NI 00353-1-8612000

For Thermal, Acoustic and Fire Safe Insulation Advice - Talk To The Insulation Experts

Drywall - Metal Stud & Track

Product **146mm C Studs**

| Stud Type |
|--------------------|
| 146mm |
| 146mm |
| 146mm |
| 146mm |
| 146mm |
| 146mm |
| 146mm |
| 146mm |
| 148mm Track |

| Metal Stud | Length lin mtr | Pieces per Pack |
|--------------|-------------------|--------------------|
| Stud | 2.400 | 10 |
| Stud | 2.700 | 10 |
| Stud | 3.000 | 10 |
| Stud | 3.600 | 10 |
| Stud | 4.200 | 10 |
| Stud | 5.000 | 10 |
| Stud | 6.000 | 10 |
| TRACK | 3.000 | 10 |

| List price 1m € |
|--------------------|
| 2.78 |
| 2.78 |
| 2.78 |
| 2.78 |
| 2.78 |
| 2.78 |
| 2.78 |
| 2.78 |
| 2.18 |

| List price per len € |
|-------------------------|
| 7.41 |
| 8.34 |
| 9.26 |
| 11.12 |
| 12.97 |
| 15.44 |
| 18.53 |
| 7.26 |

Product **70mm Acoustic Studs**

| Stud Type |
|-----------------|
| 70mm |
| 70mm |
| 70mm |
| 70mm |
| 72 Track |

| Metal Stud | Length lin mtr | Pieces per Pack |
|--------------|-------------------|--------------------|
| Stud | 2.400 | 10 |
| Stud | 3.000 | 10 |
| Stud | 3.600 | 10 |
| Stud | 4.200 | 10 |
| TRACK | 3.000 | 10 |

| List price 1m € |
|--------------------|
| 2.59 |
| 2.59 |
| 2.59 |
| 2.59 |
| 2.59 |

| List price per len € |
|-------------------------|
| 6.22 |
| 7.77 |
| 9.32 |
| 10.88 |
| 7.77 |



For Trade Discounts Please Call ROI 01-8612000 NI 00353-1-8612000

For Thermal, Acoustic and Fire Safe Insulation Advice - Talk To The Insulation Experts

Drywall - Metal Stud & Track

Product

Standard Track

| Type |
|----------|
| Standard |
| 52 |
| 72 |
| 94 |
| 148 |

| Metal Track | Length lin mtr | Pieces per Pack |
|-------------|-------------------|--------------------|
| TRACK | 3.000 | 10 |
| TRACK | 3.000 | 10 |
| TRACK | 3.000 | 10 |
| TRACK | 3.000 | 10 |

| List price 1m € |
|--------------------|
| 1.19 |
| 1.36 |
| 2.65 |
| 2.18 |

| List price per len € |
|-------------------------|
| 3.57 |
| 4.08 |
| 7.95 |
| 7.26 |

Product

Deep Track

| Type |
|----------|
| Standard |
| 52 |
| 72 |

| Metal Track | Length lin mtr | Pieces per Pack |
|-------------|-------------------|--------------------|
| TRACK | 3.000 | 10 |
| TRACK | 3.000 | 10 |

| List price 1m € |
|--------------------|
| 2.29 |
| 2.51 |

| List price per len € |
|-------------------------|
| 6.87 |
| 7.52 |

Product

Extra Deep Track

| Type |
|----------|
| Standard |
| 52 |
| 72 |
| 92 |
| 148 |

| Metal Track | Length (lin mtr) | Pieces per Pack |
|-------------|---------------------|--------------------|
| TRACK | 3.000 | 10 |
| TRACK | 3.000 | 10 |
| TRACK | 3.000 | 10 |
| TRACK | 3.000 | 10 |

| List price 1m € |
|--------------------|
| 3.33 |
| 2.38 |
| 1.48 |
| 1.71 |

| List price per len € |
|-------------------------|
| 10.00 |
| 7.15 |
| 4.45 |
| 5.12 |

Track also available in 3.6 mtr lengths



For Trade Discounts Please Call ROI 01-8612000 NI 00353-1-8612000

For Thermal, Acoustic and Fire Safe Insulation Advice - Talk To The Insulation Experts

Drywall - MF Ceilings

Product MF5 Ceiling Systems

| Product | Type | Depth (mm) | MF5 Top Hat | Length (lin mtr) | Pieces per Pack | List price 1m € | List price per len € | | |
|---------|-------------|-----------------------|-------------------------|-------------------|-------------------|----------------------------|--------------------------|-------------------------|-------|
| Product | MF5 | N/A | Top Hat | 3.600 | 50 | 1.10 | 3.96 | | |
| Product | MF6A | N/A | Perimeter Channel | 3.600 | 20 | 0.94 | 3.38 | | |
| Product | MF7 | N/A | Primary Support Channel | 3.600 | 20 | 1.08 | 3.89 | | |
| | | | Length 1m | | | | List price per each € | | |
| Product | MF8 | Strap Hanger | | 25 | | | | 10.62 | |
| | | | | Pieces per Box | | | | List price per box € | |
| Product | MF9 | Connecting Clip | | | 200 | | | | 47.11 |
| Product | MF11 | Nut & Bolt | | | 200 | | | | 5.68 |
| Product | MF12 | Soffit Cleat | | | 100 | | | | 14.18 |
| | | Depth (mm) | Thickness mm | | | List price per length € | | | |
| Product | Steel Angle | 25 x 25 | 0.5 | 3.000 | | 2.85 | | | |
| Product | Steel Angle | 25x 25 | 0.5 | 3.600 | | 3.42 | | | |
| | | Length (mm) | | | Pieces Per box | List price per box € | | | |
| | | Wafer head Zippies | 13 | 1000 | | 17.96 | | | |
| | | Length (mm) | | | Pieces Per box | List price per box € | | | |
| | | DBZ | 35 | 100 | | 15.50 | | | |

Fixings for track to concrete

For Trade Discounts Please Call ROI 01-8612000 NI 00353-1-8612000

Drywall - Wall Liner System

Wall liner top and bottom track

| Wall liner Track | Length (lin mtr) | Pieces per Pack |
|------------------|------------------|-----------------|
| Track | 3.000 | 10 |
| Track | 3.600 | 10 |

| Wall liner Channel | Length (lin mtr) | Pieces per Pack |
|--------------------|------------------|-----------------|
| Vertical stud | 2.400 | 20 |
| Vertical stud | 2.700 | 20 |
| Vertical stud | 3.000 | 20 |
| Vertical stud | 3.600 | 20 |

| Connecting Bracket | Length mm | Pieces per Pack |
|--------------------|-----------|-----------------|
| | 195 | 100 |

| Resilliant Bar | Length (lin mtr) | Pieces per Pack |
|----------------|------------------|-----------------|
| | 3.000 | 20 |

| Screw type | Length mm | Pieces per box |
|---------------------|-----------|----------------|
| Wafer head / zippie | 13 | 1000 |
| DBZ / Track fixing | 35 | 100 |

| List price 1m € | List price per len € |
|--------------------|-------------------------|
| 1.06 | 3.18 |
| 1.06 | 3.82 |

| List price 1m € | List price per len € |
|--------------------|-------------------------|
| 1.49 | 3.58 |
| 1.49 | 4.02 |
| 1.49 | 4.47 |
| 1.49 | 5.36 |

| List price per pack € |
|--------------------------|
| 18.32 |

| List price 1m € | List price per len € |
|--------------------|-------------------------|
| 2.64 | 7.90 |

| List price per box |
|--------------------|
| 17.96 |
| 15.50 |



For Trade Discounts Please Call ROI 01-8612000 NI 00353-1-8612000

For Thermal, Acoustic and Fire Safe Insulation Advice - Talk To The Insulation Experts

Drywall Accessories

| | | | |
|-------------------------|----------------------|---------------------|-----------------------------------|
| Coving C profile | | | |
| Product | Length mm | Width mm | List price per length € |
| | 3000 | 127 | 5.00 |
| Coving S profile | | | |
| Product | Length mm | Width mm | List price per length € |
| | 3000 | 135 | 9.03 |
| Artex | | | |
| Product | kg Per bag | | List price per bag € |
| | 25 | | 27.73 |
| Cove Adhesive | | | |
| Product | kg Per bag | | List price per bag € |
| | 12.5 | | 18.00 |
| Polybond - PVA | | | |
| Product | Size ltr | | List price per roll € |
| | 2.5 | | 14.50 |
| Scrim Tape | | | |
| Product | Width mm | Length lm | List price per roll € |
| | 50 | 90 | 3.80 |
| | 75 | 45 | 5.70 |
| | 100 | 90 | 9.59 |

For Trade Discounts Please Call ROI 01-8612000 NI 00353-1-8612000

Drywall Accessories

| Product | Gyproc Corner Tape <table border="1" style="width: 100%; border-collapse: collapse; margin-bottom: 5px;"> <thead> <tr style="background-color: black; color: white;"> <th style="width: 50%;">Width</th> <th style="width: 50%;">Length</th> </tr> <tr style="background-color: black; color: white;"> <th>mm</th> <th>lm</th> </tr> </thead> <tbody> <tr> <td style="text-align: center;">50</td> <td style="text-align: center;">30</td> </tr> </tbody> </table> | Width | Length | mm | lm | 50 | 30 | <table border="1" style="width: 100%; border-collapse: collapse;"> <thead> <tr style="background-color: black; color: white;"> <th>List price per roll</th> </tr> <tr style="background-color: black; color: white;"> <th>€</th> </tr> </thead> <tbody> <tr> <td style="text-align: center;">22.00</td> </tr> </tbody> </table> | List price per roll | € | 22.00 | | | | | | | |
|-----------------------|--|---------------|-----------|-----------|--------|----|---------|--|-----------------------|-----|-------|---|-----------------------|---|-----------------------|------|------|------|
| Width | Length | | | | | | | | | | | | | | | | | |
| mm | lm | | | | | | | | | | | | | | | | | |
| 50 | 30 | | | | | | | | | | | | | | | | | |
| List price per roll | | | | | | | | | | | | | | | | | | |
| € | | | | | | | | | | | | | | | | | | |
| 22.00 | | | | | | | | | | | | | | | | | | |
| Product | Paper Joint Tape <table border="1" style="width: 100%; border-collapse: collapse; margin-bottom: 5px;"> <thead> <tr style="background-color: black; color: white;"> <th style="width: 50%;">Width</th> <th style="width: 50%;">Length</th> </tr> <tr style="background-color: black; color: white;"> <th>mm</th> <th>lm</th> </tr> </thead> <tbody> <tr> <td style="text-align: center;">50</td> <td style="text-align: center;">150</td> </tr> </tbody> </table> | Width | Length | mm | lm | 50 | 150 | <table border="1" style="width: 100%; border-collapse: collapse;"> <thead> <tr style="background-color: black; color: white;"> <th>List price per roll</th> </tr> <tr style="background-color: black; color: white;"> <th>€</th> </tr> </thead> <tbody> <tr> <td style="text-align: center;">8.65</td> </tr> </tbody> </table> | List price per roll | € | 8.65 | | | | | | | |
| Width | Length | | | | | | | | | | | | | | | | | |
| mm | lm | | | | | | | | | | | | | | | | | |
| 50 | 150 | | | | | | | | | | | | | | | | | |
| List price per roll | | | | | | | | | | | | | | | | | | |
| € | | | | | | | | | | | | | | | | | | |
| 8.65 | | | | | | | | | | | | | | | | | | |
| Product | <table border="1" style="width: 100%; border-collapse: collapse; margin-bottom: 5px;"> <thead> <tr style="background-color: black; color: white;"> <th style="width: 50%;">Plaster Beads</th> <th style="width: 50%;">Mini Mesh</th> </tr> <tr style="background-color: black; color: white;"> <th>Thickness</th> <th>Length</th> </tr> <tr style="background-color: black; color: white;"> <th>mm</th> <th>mm</th> </tr> </thead> <tbody> <tr> <td style="text-align: center;">0.5</td> <td style="text-align: center;">2400</td> </tr> <tr> <td style="text-align: center;">0.5</td> <td style="text-align: center;">2700</td> </tr> </tbody> </table> | Plaster Beads | Mini Mesh | Thickness | Length | mm | mm | 0.5 | 2400 | 0.5 | 2700 | <table border="1" style="width: 100%; border-collapse: collapse;"> <thead> <tr style="background-color: black; color: white;"> <th>List price per length</th> </tr> <tr style="background-color: black; color: white;"> <th>€</th> </tr> </thead> <tbody> <tr> <td style="text-align: center;">1.04</td> </tr> <tr> <td style="text-align: center;">1.15</td> </tr> </tbody> </table> | List price per length | € | 1.04 | 1.15 | | |
| Plaster Beads | Mini Mesh | | | | | | | | | | | | | | | | | |
| Thickness | Length | | | | | | | | | | | | | | | | | |
| mm | mm | | | | | | | | | | | | | | | | | |
| 0.5 | 2400 | | | | | | | | | | | | | | | | | |
| 0.5 | 2700 | | | | | | | | | | | | | | | | | |
| List price per length | | | | | | | | | | | | | | | | | | |
| € | | | | | | | | | | | | | | | | | | |
| 1.04 | | | | | | | | | | | | | | | | | | |
| 1.15 | | | | | | | | | | | | | | | | | | |
| Product | Stop Bead <table border="1" style="width: 100%; border-collapse: collapse; margin-bottom: 5px;"> <thead> <tr style="background-color: black; color: white;"> <th style="width: 50%;">Thickness</th> <th style="width: 50%;">Length</th> </tr> <tr style="background-color: black; color: white;"> <th>mm</th> <th>mm</th> </tr> </thead> <tbody> <tr> <td style="text-align: center;">3</td> <td style="text-align: center;">2400</td> </tr> </tbody> </table> | Thickness | Length | mm | mm | 3 | 2400 | <table border="1" style="width: 100%; border-collapse: collapse;"> <thead> <tr style="background-color: black; color: white;"> <th>List price per length</th> </tr> <tr style="background-color: black; color: white;"> <th>€</th> </tr> </thead> <tbody> <tr> <td style="text-align: center;">2.76</td> </tr> </tbody> </table> | List price per length | € | 2.76 | | | | | | | |
| Thickness | Length | | | | | | | | | | | | | | | | | |
| mm | mm | | | | | | | | | | | | | | | | | |
| 3 | 2400 | | | | | | | | | | | | | | | | | |
| List price per length | | | | | | | | | | | | | | | | | | |
| € | | | | | | | | | | | | | | | | | | |
| 2.76 | | | | | | | | | | | | | | | | | | |
| Product | Metal Edge Bead J bead <table border="1" style="width: 100%; border-collapse: collapse; margin-bottom: 5px;"> <thead> <tr style="background-color: black; color: white;"> <th style="width: 33%;">Thickness</th> <th style="width: 33%;">Length</th> <th style="width: 34%;">Pieces</th> </tr> <tr style="background-color: black; color: white;"> <th>mm</th> <th>mm</th> <th>Per box</th> </tr> </thead> <tbody> <tr> <td style="text-align: center;">12.5</td> <td style="text-align: center;">3000</td> <td style="text-align: center;">20</td> </tr> <tr> <td style="text-align: center;">15</td> <td style="text-align: center;">3000</td> <td style="text-align: center;">20</td> </tr> </tbody> </table> | Thickness | Length | Pieces | mm | mm | Per box | 12.5 | 3000 | 20 | 15 | 3000 | 20 | <table border="1" style="width: 100%; border-collapse: collapse;"> <thead> <tr style="background-color: black; color: white;"> <th>List price per length</th> </tr> <tr style="background-color: black; color: white;"> <th>€</th> </tr> </thead> <tbody> <tr> <td style="text-align: center;">4.58</td> </tr> <tr> <td style="text-align: center;">5.50</td> </tr> </tbody> </table> | List price per length | € | 4.58 | 5.50 |
| Thickness | Length | Pieces | | | | | | | | | | | | | | | | |
| mm | mm | Per box | | | | | | | | | | | | | | | | |
| 12.5 | 3000 | 20 | | | | | | | | | | | | | | | | |
| 15 | 3000 | 20 | | | | | | | | | | | | | | | | |
| List price per length | | | | | | | | | | | | | | | | | | |
| € | | | | | | | | | | | | | | | | | | |
| 4.58 | | | | | | | | | | | | | | | | | | |
| 5.50 | | | | | | | | | | | | | | | | | | |

For Trade Discounts Please Call ROI 01-8612000 NI 00353-1-8612000

For Thermal, Acoustic and Fire Safe Insulation Advice - Talk To The Insulation Experts

DRYWALL ACCESSORIES

Product Gyproc Drywall Easi-Fill

| kg Per bag | Pieces |
|---------------|--------|
| 10 | 1 |

| List price per bag € |
|-------------------------|
| 17.53 |

Drywall Screws - Board to metal

| Screw Type | Length mm | Pieces Per box |
|---------------|--------------|-------------------|
| Drywall | 25 | 1000 |
| Drywall | 32 | 1000 |
| Drywall | 38 | 1000 |
| Drywall | 42 | 1000 |
| Drywall | 50 | 1000 |
| Drywall | 65 | 500 |
| Drywall | 75 | 500 |
| Drywall | 90 | 500 |
| Drywall | 100 | 500 |
| Drywall | 125 | 200 |
| Drywall | 150 | 100 |

| List price per box € |
|-------------------------|
| 8.40 |
| 8.93 |
| 9.60 |
| 9.80 |
| 12.60 |
| 9.44 |
| 11.30 |
| 25.28 |
| 26.66 |
| 15.78 |
| 10.96 |

Drywall Jack-Point Screws

| Screw Type | Length mm | Pieces Per box |
|---------------|--------------|-------------------|
| Jack point | 25 | 1000 |
| Jack point | 35 | 1000 |
| Jack point | 41 | 1000 |
| Jack point | 55 | 1000 |
| Jack point | 60 | 500 |

| List price per box € |
|-------------------------|
| 15.22 |
| 21.50 |
| 26.03 |
| 42.00 |
| 22.00 |

For Trade Discounts Please Call ROI 01-8612000 NI 00353-1-8612000

DRYWALL ACCESSORIES

Spax Screws

| Product | Screw | Screw | Length | Pieces |
|---------|--------|-------|--------|---------|
| | Type | Type | mm | Per box |
| | Timber | 3.5 | 30 | 200 |
| | Timber | 3.5 | 35 | 200 |
| | Timber | 3.5 | 40 | 200 |
| | Timber | 3.5 | 45 | 200 |
| | Timber | 3.5 | 50 | 200 |

| List price per box |
|--------------------|
| € |
| 4.72 |
| 6.00 |
| 6.72 |
| 8.40 |
| 9.71 |

Drywall Collated Drywall Screws

| Product | Screw | Length | Pieces |
|---------|---------|--------|---------|
| | Type | mm | Per box |
| | Drywall | 25 | 1000 |
| | Drywall | 35 | 1000 |
| | Drywall | 55 | 1000 |

| List price per box |
|--------------------|
| € |
| 12.16 |
| 12.72 |
| 17.14 |

Drywall Collated Drywall Screws

| Product | Screw | Length | Pieces |
|---------|--------|--------|---------|
| | Type | mm | Per box |
| | Timber | 25 | 1000 |
| | Timber | 35 | 1000 |
| | Timber | 55 | 1000 |

| List price per box |
|--------------------|
| € |
| 12.16 |
| 12.72 |
| 17.14 |

Wafer head screws

| Product | Screw | Length | Pieces |
|---------|------------|--------|---------|
| | Type | mm | Per box |
| | Wafer head | 13 | 1000 |
| | Drywall | | |

| List price per box |
|--------------------|
| € |
| 17.96 |

For Trade Discounts Please Call ROI 01-8612000 NI 00353-1-8612000

DRYWALL ACCESSORIES

Rigidur Screws

| Product | Screw Type | Length mm | Pieces Per box |
|---------|------------|-----------|----------------|
| | Rigidur | 19 | 1000 |
| | Rigidur | 22 | 1000 |
| | Rigidur | 30 | 1000 |
| | Rigidur | 30 | 1000 |

| List price per box |
|--------------------|
| € |
| 16.00 |
| 19.00 |
| 24.00 |
| 30.00 |

Glassroc F Firecase Screws

| Product | Screw Type | Length mm | Pieces Per box |
|---------|------------|-----------|----------------|
| | Firecase | 40 | 1000 |
| | Firecase | 50 | 1000 |
| | Firecase | 58 | 1000 |

| List price per box |
|--------------------|
| € |
| 30.00 |
| 39.00 |
| 52.00 |

Aquaroc Screws

| Product | Screw Type | Length mm | Pieces Per box |
|---------|------------|-----------|----------------|
| | Aquaroc | 41 | 500 |

| List price per box |
|--------------------|
| € |
| 24.00 |

Nailable Plugs

| Product | Fixing Type | Length mm | Pieces Per box |
|---------|----------------|-----------|----------------|
| | Nailable Plugs | 60 | 100 |
| | Nailable Plugs | 80 | 100 |
| | Nailable Plugs | 110 | 100 |

| List price per box |
|--------------------|
| € |
| 32.00 |
| 34.00 |
| 40.00 |

For Trade Discounts Please Call ROI 01-8612000 NI 00353-1-8612000

DRYWALL ACCESSORIES

| | Type Plastering | Size kg | List price per each € |
|---------|---------------------------|-------------|--------------------------|
| Product | Skim Coat | 25kg | 10.66 |
| Product | Febond Blue Grit | 10ltr | 30.66 |
| Product | Gypsum Bonding Coat | 25kg | 14.66 |
| Product | Gypsum Hard Coat | 25kg | 13.80 |
| Product | Gypsum Airtite | 25kg | 14.70 |
| Product | Gypsum Joint Filler | 25kg | 27.63 |
| Product | Ready Mix Sheetrock Blue | 20kg Bucket | 23.66 |
| Product | Ready Mix Sheetrock Green | 20kg Bucket | 20.84 |
| Product | Knauf Multi Fil | 10kg | 17.49 |

Plastering and taping tools available

For Trade Discounts Please Call ROI 01-8612000 NI 00353-1-8612000

For Thermal, Acoustic and Fire Safe Insulation Advice - Talk To The Insulation Experts

Associated Building Materials and Insulation Accessories

| | | | | | | | |
|---------|--|----------|-----------|--|--|--|---------------------|
| Product | Cold water tank jackets | | | | | | |
| | mm | mm | mm | | | | List price per each |
| | 450 | 300 | 300 | | | | € |
| | 1200 | 600 | 600 | | | | 8.00 |
| | | | | | | | 18.20 |
| Product | Cylinder jackets | | | | | | List price per each |
| | Length | Width | | | | | € |
| | mm | mm | | | | | |
| | 918 | 459 | | | | | 16.48 |
| Product | Insulated loft ladder hood/Attic tent | | | | | | List price per each |
| | Length | Width | Thickness | | | | € |
| | mtr | mtr | mm | | | | |
| | 1.500 | 0.600 | 80 | | | | 58.00 |
| Product | Draft proofing E strips | | | | | | List price per each |
| | Colour | lm | mm | | | | € |
| | Brown/White | 100 | 5 | | | | 46.66 |
| Product | Airtight Down Light Covers | | | | | | List price per each |
| | White | Diameter | | | | | € |
| | | mm | | | | | |
| | | 200 | | | | | 12.00 |
| Product | Fire Safe Down Light Covers | | | | | | List price per each |
| | Brown | Diameter | | | | | € |
| | | mm | | | | | |
| | | 200 | | | | | 12.00 |

For Trade Discounts Please Call ROI 01-8612000 NI 00353-1-8612000

For Thermal, Acoustic and Fire Safe Insulation Advice - Talk To The Insulation Experts

Associated Building Materials and Insulation Accessories

Product **Loft Walk** 90mm High density extruded polystyrene bonded to 18mm T & G chipboard

| Thickness mm | Length mtr | Width mtr |
|-----------------|---------------|--------------|
| 108 | 2.400 | 0.600 |

| List price per each € |
|--------------------------|
| 42.00 |

Product **Loft Walk** 90mm High density extruded polystyrene bonded to 12mm Plywood

| Thickness mm | Length mtr | Width mtr |
|-----------------|---------------|--------------|
| 102 | 1.200 | 0.600 |

| List price per each € |
|--------------------------|
| 21.00 |

Product **Loft Walk** 75 Expanded polystyrene bonded to 12mm Plywood

| Thickness mm | Length mtr | Width mtr |
|-----------------|---------------|--------------|
| 87 | 1.200 | 0.600 |

| List price per each € |
|--------------------------|
| 18.00 |

Product **Loft Walk** 100mm Expanded polystyrene bonded to 12mm Plywood

| Thickness mm | Length mtr | Width mtr |
|-----------------|---------------|--------------|
| 112 | 1.200 | 0.600 |

| List price per each € |
|--------------------------|
| 21.00 |

Product **Polythene**

| Thickness Guage | m2 Per roll |
|--------------------|----------------|
| 500 | 53 |
| 1000 | 59.5 |

| List price per roll € |
|--------------------------|
| 12.66 |
| 20.00 |

Product **Staples**

| Thickness mm | Pcs Per Box |
|-----------------|----------------|
| 8 | 1250 |
| 10 | 5000 |

| List price per box € |
|-------------------------|
| 4.60 |
| 11.00 |

For Trade Discounts Please Call ROI 01-8612000 NI 00353-1-8612000

Associated Building Materials and Insulation Accessories

Product

Pipe Lagging Tubolit

| Diameter mm | Thickness mm | Length mtr |
|----------------|-----------------|---------------|
| 15 | 19 | 2.000 |
| 22 | 19 | 2.000 |
| 28 | 19 | 2.000 |

| List price per length € |
|----------------------------|
| 1.75 |
| 2.00 |
| 2.40 |

Product

Duct Tape

| Diameter mm | Width mm | Length mtr |
|----------------|-------------|---------------|
| 15 | 50 | 50 |

| List price per roll € |
|--------------------------|
| 4.80 |

Product

Kingspan Cavity Closers

| Width mm | Length mtr | Pcs Per Pack |
|-------------|---------------|-----------------|
| 100 | 2.400 | 10 |
| 125 | 2.400 | 10 |
| 150 | 2.400 | 10 |

| List price per pack € |
|--------------------------|
| 147.00 |
| 192.00 |
| 237.00 |

Product

Eco Cement

| Size Kg |
|------------|
| 25 |

| List price per bag € |
|-------------------------|
| 6.00 |

Product

Proctor Aerogel

| Insulation Type | Thickness mm | Width mtr | Length mtr | m2 Per sheet |
|--------------------|-----------------|--------------|---------------|-----------------|
| Aerogel | 10 | 1.200 | 1.200 | 1.44 |

| List price per sheet € |
|---------------------------|
| 121.00 |

For Trade Discounts Please Call ROI 01-8612000 NI 00353-1-8612000

For Thermal, Acoustic and Fire Safe Insulation Advice - Talk To The Insulation Experts

Timber Sheeting & Timber Battens

Product **OSB 3**

| Thickness mm | Width mtr | Length mtr | Edge Type |
|-----------------|--------------|---------------|--------------|
| 11 | 1.200 | 2.400 | Square |
| 18 | 1.200 | 2.400 | Square |
| 18 | 0.600 | 2.400 | T&G |

| List price per sheet € |
|---------------------------|
| 15.47 |
| 24.76 |
| 13.20 |

Product **Chipboard P5**

| Thickness mm | Width mtr | Length mtr | Edge Type |
|-----------------|--------------|---------------|--------------|
| 18 | 0.600 | 2.400 | T&G |

| List price per sheet € |
|---------------------------|
| 13.55 |

Product **Timber Battens Treated**

| Thickness mm | Width mm | Length mtr |
|-----------------|-------------|---------------|
| 22 | 44 | 4.800 |
| 35 | 44 | 4.800 |

| List price per length € |
|----------------------------|
| 5.36 |
| 8.52 |

Product **PLYWOOD WBP**

| Thickness mm | Width mtr | Length mtr | Edge Type |
|-----------------|--------------|---------------|--------------|
| 6 | 1.220 | 2.440 | Square |
| 9 | 1.220 | 2.440 | Square |
| 12 | 1.220 | 2.440 | Square |
| 18 | 1.220 | 2.440 | Square |

| List price per sheet € |
|---------------------------|
| 16.68 |
| 17.33 |
| 26.34 |
| 32.60 |

U Value Insulation & Drywall Ltd

Your One Stop Shop for Insulation and Associated Building Materials and Advice

For Trade Discounts Please Call ROI 01-8612000 NI 00353-1-8612000

For Thermal, Acoustic and Fire Safe Insulation Advice - Talk To The Insulation Experts

Foams & Sealants

| Foams / Sealants | | Size ml | Pieces/ Pack | Rating | List price per each € |
|------------------|------------------------------------|------------|-----------------|-----------------------------|--------------------------|
| Product | Hand Held Fixing Foam | 750 | 1 | | 9.64 |
| Product | Flexifoam (for gun) | 750 | 1 | | 15.15 |
| Product | Fix All Fills & Bonds 1K/Gun Grade | 750 | 1 | | 16.17 |
| Product | Soudafoam FR | 750 | 1 | | 17.16 |
| Product | Gun Foam Cleaner | 500 | 1 | | 9.75 |
| Product | Foam Gun | N/A | 1 | | 37.00 |
| Product | Fix All Classic | 290 | 1 | | 8.50 |
| Product | Fix All High Tack | 290 | 1 | | 12.42 |
| Product | Fix All Turbo | 290 | 1 | | 30.72 |
| Product | Silirub B1 | 310 | 1 | 4 Hour Fire Rated Silicone | 9.10 |
| Product | Firecryl | 310 | 1 | Firecryl 4 Hour Intumescent | 5.90 |
| Product | Soudaseal 240 | 290 | 1 | | 11.13 |

For Trade Discounts Please Call ROI 01-8612000 NI 00353-1-8612000

For Thermal, Acoustic and Fire Safe Insulation Advice - Talk To The Insulation Experts

External Wall - Insulation Accessories

| Product Starter Track | | | |
|------------------------------|---------|------------|--------------------|
| Type | Length | Pieces per | List price per len |
| Starter Track | lin mtr | Pack | |
| 80 | 2.500 | 10 | 10.00 |
| 100 | 2.500 | 10 | 16.00 |

| Product External Plaster | | | |
|---------------------------------|------|------|-----------------|
| Size | Unit | Size | List price each |
| kg | Ltr | kg | |
| 20 | | Bag | 18.00 |
| 25 | Drum | | 79.00 |
| 25 | Drum | | 58.50 |

| Product Hammer Fixings | | | |
|-------------------------------|-----------|---------|--------------------|
| Length | Thickness | Pcs Per | List price per box |
| mm | mm | Box | |
| 60 | 8 | 200 | 22.00 |
| 95 | 8 | 200 | 46.00 |
| 155 | 8 | 200 | 52.00 |
| 195 | 8 | 100 | 66.00 |

| Product EWI Bead With Mesh | | | |
|-----------------------------------|-----------|--------|-----------------------|
| Bead | Thickness | Length | List price per length |
| Type | mm | mm | |
| PVC Corner | 0.5 | 3.00 | 2.20 |
| Stop bead | 10 | 2.00 | 1.50 |
| Stop bead | 6 | 2.50 | 1.10 |

For Trade Discounts Please Call ROI 01-8612000 NI 00353-1-8612000

Airpacks - Expanded Polystyrene External WALL Insulation

Product **EWI Aged Polystyrene External Wall Insulation**

| Type | Thickness | Width | Length | m2 |
|-----------------|-----------|-------|--------|-----------|
| Polystyrene EWI | mm | mtr | mtr | Per sheet |
| EWI Polystyrene | 30 | 0.600 | 1.200 | 0.72 |
| EWI Polystyrene | 40 | 0.600 | 1.200 | 0.72 |
| EWI Polystyrene | 50 | 0.600 | 1.200 | 0.72 |
| EWI Polystyrene | 75 | 0.600 | 1.200 | 0.72 |
| EWI Polystyrene | 100 | 0.600 | 1.200 | 0.72 |
| EWI Polystyrene | 125 | 0.600 | 1.200 | 0.72 |
| EWI Polystyrene | 150 | 0.600 | 1.200 | 0.72 |

| List price per m2 |
|-------------------|
| € |
| 4.11 |
| 5.48 |
| 6.85 |
| 10.28 |
| 13.70 |
| 17.13 |
| 20.55 |

| List price per sheet |
|----------------------|
| € |
| 2.96 |
| 3.95 |
| 4.93 |
| 7.40 |
| 9.86 |
| 12.33 |
| 14.80 |

Airpacks - Expanded Polystyrene Floor Insulation

Product **Expanded Polystyrene Floor Insulation**

| Type | Thickness | Width | Length | m2 |
|-------------------|-----------|-------|--------|-----------|
| Polystyrene Floor | mm | mtr | mtr | Per sheet |
| Floor | 30 | 1.200 | 2.400 | 2.88 |
| Floor | 40 | 1.200 | 2.400 | 2.88 |
| Floor | 50 | 1.200 | 2.400 | 2.88 |
| Floor | 75 | 1.200 | 2.400 | 2.88 |
| Floor | 100 | 1.200 | 2.400 | 2.88 |
| Floor | 125 | 1.200 | 2.400 | 2.88 |
| Floor | 150 | 1.200 | 2.400 | 2.88 |

| List price per m2 |
|-------------------|
| € |
| 3.84 |
| 5.13 |
| 6.40 |
| 9.61 |
| 12.80 |
| 16.00 |
| 19.20 |

| List price per sheet |
|----------------------|
| € |
| 11.06 |
| 14.77 |
| 18.43 |
| 27.68 |
| 36.86 |
| 46.08 |
| 55.30 |

Expanded polystyrene (70) Silver
 Also available in smaller sizes POA



For Trade Discounts Please Call ROI 01-8612000 NI 00353-1-8612000

For Thermal, Acoustic and Fire Safe Insulation Advice - Talk To The Insulation Experts

Knauf Drywall Brio Flooring System

Knauf Brio 18 Plain Board

| Product | Thickness (mm) | Length (mm) | Width (mm) | Board Edge | m2 Per sheet |
|---------|-------------------|----------------|---------------|---------------|-----------------|
| | 18 | 0.600 | 1.200 | Shiplap | 0.72 |
| | 23 | 0.600 | 1.200 | Shiplap | 0.72 |

| List price m2 € |
|--------------------|
| €38.74 |
| €46.78 |

| List price per sheet € |
|---------------------------|
| €27.89 |
| €33.68 |

Knauf Brio WF 10mm acoustic insulation bonded to board

| | | | | |
|----|-------|-------|---------|------|
| 28 | 0.600 | 1.200 | Shiplap | 0.72 |
| 33 | 0.600 | 1.200 | Shiplap | 0.72 |

| |
|--------|
| €46.96 |
| €54.80 |

| |
|--------|
| €33.81 |
| €39.46 |

Knauf Brio Screws

| Product | To suit (mm) | Pcs Per box |
|---------|-----------------|----------------|
| | 18 | 500 |
| | 23 | 500 |

| List price per box € |
|-------------------------|
| 17.00 |
| 20.00 |

Knauf Flooring Edge Strip

| Product | Thickness (mm) | Length (mm) |
|---------|-------------------|----------------|
| | 18 | 1.200 |

| List price per length € |
|----------------------------|
| 4.00 |

Knauf Brio Joint Adhesive

| Product | Thickness (mm) |
|---------|-------------------|
| | 18 |

| List price per each € |
|--------------------------|
| 25.00 |

Knauf Brio Schnellgrund Primer

| Product | Tub kg |
|---------|-----------|
| | 5 |

| List price per each € |
|--------------------------|
| 42.00 |

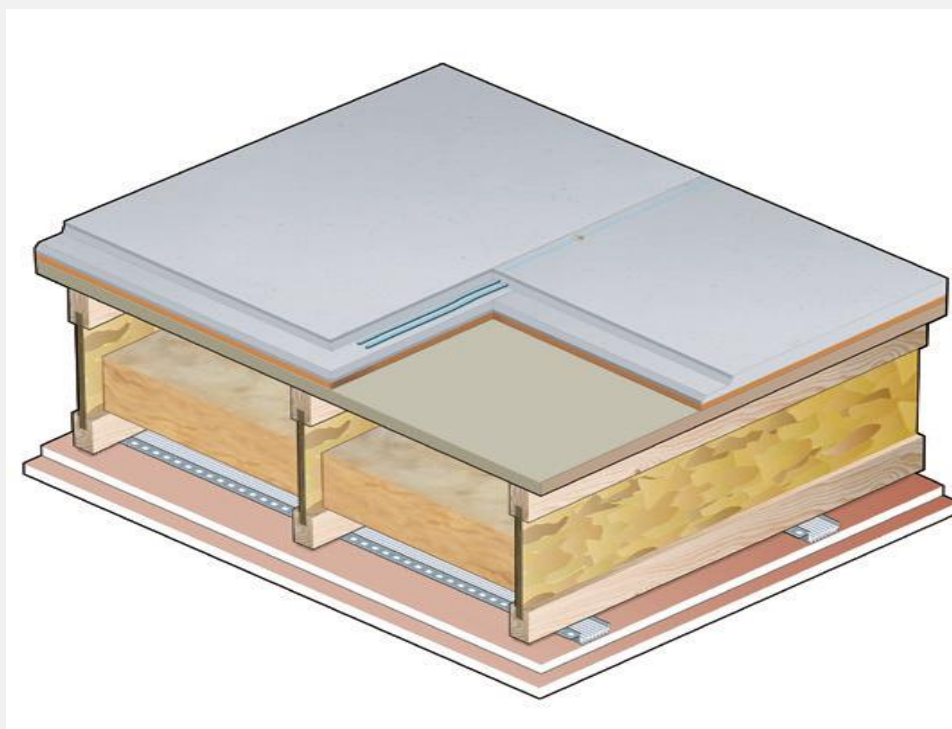

For Trade Discounts Please Call ROI 01-8612000 NI 00353-1-8612000

Knauf Drywall BRIO Flooring System



Key Facts

- Allows underfloor heat through with minimum resistance and maximum efficiency
- Makes room temperature more responsive to control
- Allows UFH systems to run at lower temperatures
- Reduces CO2 emissions by 500kg per house, per year*

*Compared to 22mm chipboard, Independent test data Knauf Insulations

Details available from Knauf Drywall.

- It's a dry construction element
- Requires no water or wet trades
- Easy to install requires no additional specialist trades
- Can be installed and ready for foot traffic within hours
- No drying times, no delays
- Better health and safety on site.



Brio reduces noise underfoot - and in the rooms below

Knauf Brio is an engineered gypsum flooring panel with 60% recycled content, specially developed for use in new or refurbished residential and commercial buildings. It sounds almost too good to be true.

It's a strong, lightweight and quickly-installed dry screed system.

Brio has a very high thermal conductivity ($R = 0.38 \text{ W/mK}$) so heating response times are quicker and energy use is reduced.

Once installed, Brio creates a robust monolithic floor with a high density of 1100 - 1200 kg/m³, and so reduces impact and airborne sound transmission. With a wholly dry installation process, Brio maximises on-site efficiency too. And it's backed by Knauf's unrivalled service and support.

For Trade Discounts Please Call ROI 01-8612000 NI 00353-1-8612000

