



PRODUCT CATALOGUE 2025



U ValueTM
Insulation

Delivering Better Solutions

TABLE OF CONTENTS

<u>Gypfor Plasterboard</u>	03
<u>Knauf Drywall</u>	04
<u>Dalsan Plasterboard</u>	06
<u>SCRU</u>	07
<u>Mannok PIR</u>	10
<u>Unilin</u>	13
<u>Warmline PIR</u>	16
<u>Kingspan</u>	17
<u>Fibran</u>	20
<u>Volcalis</u>	21
<u>Guide for Rafters</u>	24
<u>Rockwool</u>	26
<u>Knauf Insulation</u>	31
<u>Isover</u>	33
<u>Termolan</u>	34
<u>ODE</u>	34
<u>KLEIB</u>	35
<u>Auxillary Products</u>	37
<u>EWI U Value Guide</u>	41
<u>Ventos</u>	42
<u>Loft Leg</u>	43
<u>ARC</u>	44
<u>FSI</u>	47
<u>Exitile</u>	50
<u>Kemwell</u>	51
<u>Resistant Board</u>	52
<u>Magply</u>	53
<u>OSB</u>	53
<u>Superior Sections</u>	54
<u>Knauf Ceiling</u>	58
<u>TVS Group</u>	62
<u>Cipriani</u>	64
<u>Soudal</u>	65
<u>Tec7</u>	70
<u>Everbuild</u>	72
<u>Miscellaneous Products</u>	74

***Disclaimer:** Sizes and specifications should be checked and verified with your local supplier or sales representative.
Product details are subject to change due to routine testing and manufacturer discretion.

STANDARD BOARD

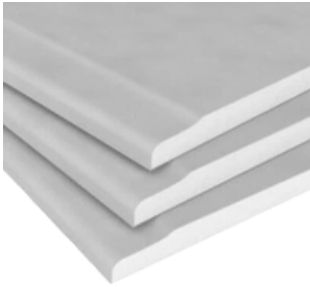

Gypfor Standard Plasterboards are designed to be lightweight, making them easy to handle, transport, and install. They can be easily cut to fit specific dimensions ensuring quick and efficient installation.

Code	Sizes	Pallet Quantity
GY/WB	2400x1200mm 12.5	42
GY/WB	2438x1200mm 12.5	42
GY/WB	2700x1200mm 12.5	42
GY/WB	2400x1200mm 15	36
GY/WB	2438x1200mm 15	36
GY/WB	2700x1200mm 15	36

FIRE BOARD



Gypfor Fire Boards are designed to provide enhanced fire resistance and significantly reduce the spread of flames, contributing to overall building safety.

Code	Sizes	Pallet Quantity
GY/FB	2400x1200mm 12.5	42
GY/FB	2700x1200mm 12.5	42
GY/FB	2400x1200mm 15	36
GY/FB	2700x1200mm 15	36

SOUND BOARD



Gypfor Sound Boards provide superior acoustic performance, making them ideal for environments where sound insulation is critical. Reduces noise pollution and enhances privacy within a building.

Code	Sizes	Pallet Quantity
GY/SB	2400x1200mm 12.5	42

MOISTURE BOARD



Gypfor Moisture Boards are engineered to resist moisture, with the aim of preventing damage in wet or humid environments such as bathrooms and kitchens.

Code	Sizes	Pallet Quantity
GY/MB	2400x1200mm 12.5	42
GY/MB	2438x1200mm 12.5	42

FOIL BOARD



Code	Sizes	Pallet Quantity
GY/VB	2400x1200mm 12.5	42
GY/VB	2438x1200mm 12.5	42

Gypfor Foil Boards are specialised boards designed to enhance the thermal insulation and moisture resistance. The foil back reflects the heat, improving the thermal insulation of the walls and ceilings.

STANDARD BOARDS



Knauf Standard Plasterboards are widely used in projects due to their versatility, easy of use, and various beneficial properties such as allowing for quick and easy installation.

Code	Sizes	Pallet Quantity
KD/PB/WB	1800x900mm 9.5	100
KD/PB/WB	2438x1200mm 9.5	92
KD/PB/WB	2400x1200mm 12.5	72
KD/PB/WB	2438x1200mm 12.5	72
KD/PB/WB	2700x1200mm 12.5	72
KD/PB/WB	3000x1200mm 12.5	60
KD/PB/WB	2400x1200mm 15	60
KD/PB/WB	2438x1200mm 15	60
KD/PB/WB	2700x1200mm 15	48
KD/PB/WB	3000x1200mm 15	48

MOISTURE PANEL

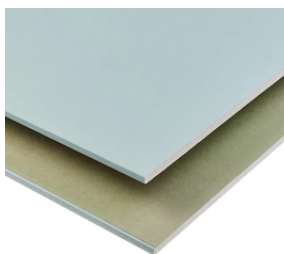

Knauf Moisture Panels are designed to withstand high levels of humidity and direct water exposure, making them ideal for specific environments.

The moisture resistant properties help prevent any mould or mildew growth, enhancing overall quality.

Code	Sizes	Pallet Quantity
KD/PB/MP	2400x1200mm 12.5	60
KD/PB/MP	2700x1200mm 12.5	60
KD/PB/MP	2400x1200mm 15	60

FIRE PANEL



Knauf Fire Panel elevates the fire resistance of a plasterboard. Easily identifiable by the pink paper face, the boards can be finished with ready-mixed finishes, traditional plaster, or direct decoration.

Code	Sizes	Pallet Quantity
KD/PB/FP	2400x1200mm 12.5	60
KD/PB/FP	2700x1200mm 12.5	60
KD/PB/FP	3000x1200mm 12.5	48
KD/PB/FP	2400x1200mm 15	48
KD/PB/FP	2700x1200mm 15	48
KD/PB/FP	3000x1200mm 15	48

SOUNDSHIELD PLUS



Knauf Soundshield Plus is a high performance board designed for superior sound protection. These are ideal for creating a quieter, more comfortable environment in both residential and commercial buildings.

Code	Sizes	Pallet Quantity
KD/PB/SS	2400x1200mm 12.5	56
KD/PB/SS	2700x1200mm 12.5	48
KD/PB/SS	3000x1200mm 12.5	42
KD/PB/SS	2400x1200mm 15	48
KD/PB/SS	2700x1200mm 15	42
KD/PB/SS	3000x1200mm 15	36

VAPOUR PANEL



Knauf Vapour Panel is Knauf plasterboard with a metallised polyester foil laminated on the grey paper face, creating a vapour barrier. Not suitable for areas of high humidity.

Code	Sizes	Pallet Quantity
KD/PB/MP	2400x1200mm 12.5	60
KD/PB/MP	2700x1200mm 12.5	60
KD/PB/MP	2400x1200mm 15	60

CORE BOARD

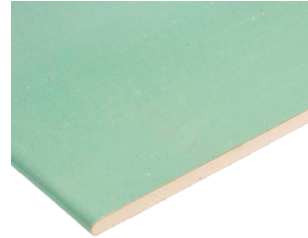

Knauf Core Board is designed to be used in conjunction with the Knauf Shaftwall systems. It has both fire and moisture resistant qualities.

Code	Size	Pallet Quantity
KD/PB/CO	19x3000x600mm	32



STANDARD BOARD

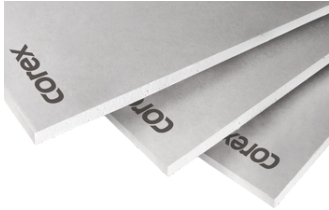

White COREX is a plasterboard that is used in the construction of partition walls, dry- linings and suspended ceilings. Both faces are covered with special paper that gives flexibility and high strength to the board

Code	Sizes	Pallet Quantity
DAL/PB/WB-12.5-2.47-TE	12.5x2400x1200mm	80
DAL/PB/WB-12.5-2.400-SE	12.5x2400x1200mm	80
DAL/PB/WB-12.5-2.438-TE	12.5x2438x1200mm	80
DAL/PB/WB-15-2.438-TE	15x2438x1200mm	60

MOISTURE BOARD

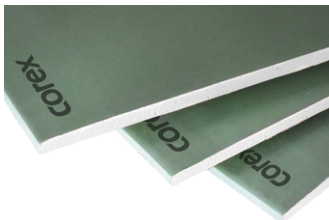

Green COREX, is a plasterboard that is used in the construction of partition walls, drywall linings and suspended ceilings where water and moisture resistance are required.

Code	Sizes	Pallet Quantity
DAL/PB/MB-12.5-2.4-TE	12.5x2400x1200mm	80

FIRESHIELD



Red COREX is a plasterboard that is used for construction of partition walls, drywall linings and suspended ceilings where resistance to fire. The core is enhanced by special fibres and additives.

Code	Sizes	Pallet Quantity
DAL/PB/FB-12.5-2.4-TE	12.5x2400x1200mm	72
DAL/PB/FB-15-2.4-TE	15x2400x1200mm	66

SOUND BOARD

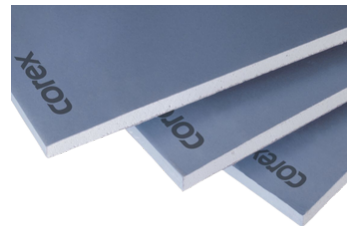

COREX Sound is a plasterboard that is used for construction of partition walls, drywall linings and suspended ceilings where greater levels of sound insulation are required.

Code	Sizes	Pallet Quantity
DAL/PB/SB-12.5-2.4-TE	12.5x2400x1200mm	72
DAL/PB/SB-15-2.4-TE	15x2400x1200mm	60

Drywall Screw - Coarse

Phosphate

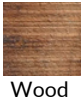

Used to attach sheets of drywall to the wooden framework of a building, providing a stable surface for finishing.

Code	Length	Box Quantity	Carton Quantity
DW-C-032	32x3.5mm	1000	10
DW-C-038	38x3.5mm	500	10
DW-C-042	42x3.5mm	500	10

Drywall Screw - Fine

Phosphate

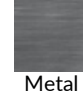

Used to attach sheets of drywall to the metal framework of a building, providing a secure surface for finishing.

Code	Length	Box Quantity	Pallet Quantity
DW -F-025	25x3.5mm	1000	10
DW-F-032	32x3.5mm	1000	10
DW-F-038	38x3.5mm	500	10

Collated Drywall Screw - Coarse

Phosphate

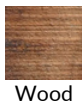

Used to attach sheets of drywall to the wooden framework of a building, providing a stable surface for finishing.

Code	Length	Box Quantity	Carton Quantity
COLL-C-35	35x3.5mm	1000	10
COLL-C-38	38x3.5mm	1000	10
COLL-C-42	42x3.5mm	1000	10
COLL-C-45	42x3.5mm	1000	10

Collated Drywall Screw - Fine

Phosphate



Used to attach sheets of drywall to the metal framework of a building, providing a secure surface for finishing.

Code	Length	Box Quantity	Carton Quantity
COLL-F-25	25x3.5mm	1000	10
COLL-F-38	38x3.5mm	1000	10
COLL-F-42	42x3.5mm	1000	10
COLL-F-45	45x3.5mm	1000	10

Metal Insulation Plug

Galvanized Steel



Used to secure insulation into place and helps maintain the insulation's position. Material coated in zinc to protect from rust and corrosion.

Code	Length	Bag Quantity	Pallet Quantity
MF-8X060	8x60mm	50	72
MF-8X090	8x90mm	50	54
MF-8X110	8x110mm	50	54
MF-8X140	8x140mm	50	54
MF-8X170	8x170mm	50	36
MF-8X200	8x200mm	50	36

Metal Insulation Plug - Stainless Steel

Stainless Steel

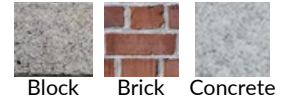

Used to secure insulation into place and helps maintain the insulation's position. Material is highly resistant to corrosion and rust to maintain integrity.

Code	Length	Box Quantity	Pallet Quantity
MF-SS-8X140	8x140mm	250	54
MF-SS-8X150	8x150mm	250	54
MF-SS-8X170	8x170mm	250	36
MF-SS-8X200	8x200mm	250	36
MF-SS-8X230	8x230mm	250	36

Mini Mesh

Galvanized Steel

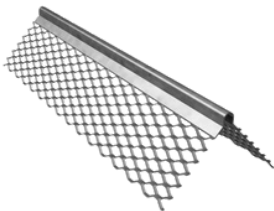

Used to reinforce concrete slabs, walls and other structures providing additional strength and reducing the risk of structural issues.

Code	Length	Box Quantity
B/MM-2.4	2400mm	50
B/MM-2.7	2700mm	50

Edge J Bead

Galvanized Steel



Used to protect the edges of drywall and plasterboard to help prevent damage from impacts. Can also help prevent moisture seeping into the edges of the drywall.

Code	Length	Box Quantity
B/JB-3.0	12.5mmx3m	50
B/JB-3.0	15.0mmx3m	50

Insulation Disc

Galvanized Steel



Used in External Wall Insulation (EWI) systems to secure insulation boards to the building's exterior wall to enhance thermal & acoustic insulation properties.

Code	Length	Box Quantity	Pallet Quantity
MFDISC-085SS	85mm	1000	36

Scrim Tape

Drywall Joint Tape



Used to provide structural reinforcement to strengthen the joints between drywall panels or repairs. Helps enforce a strong and smooth finish.

Code	Length
T/SCRIM-050	50mmx90m

U Value Insulation has manufactured our personal brand of screws & accessories.

Check out our services at uvalue.ie or uvalueinsulations.co.uk

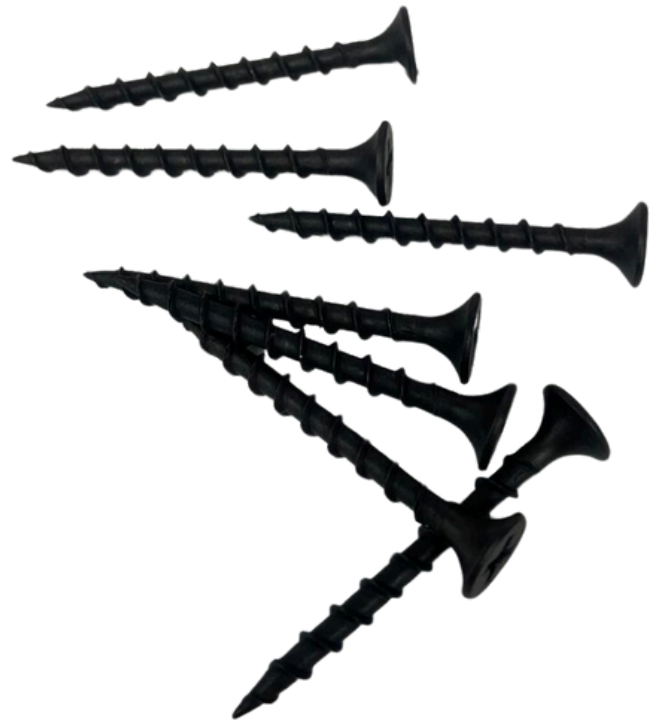

PIR



Mannok PIR contains low thermal conductivity and maximises the performance of their insulation properties and enables low U-values to be achieved.

Code	Sizes	Pallet Quantity
Q/UF025	25x2400x1200mm	12
Q/UF030	30x2400x1200mm	10
Q/UF040	40x2400x1200mm	8
Q/UF050	50x2400x1200mm	6
Q/UF060	60x2400x1200mm	5
Q/UF070	70x2400x1200mm	4
Q/UF075	75x2400x1200mm	4
Q/UF080	80x2400x1200mm	4
Q/UF090	90x2400x1200mm	3
Q/UF100	100x2400x1200mm	3
Q/UF110	110x2400x1200mm	3
Q/UF120	120x2400x1200mm	2
Q/UF125	125x2400x1200mm	2
Q/UF130	130x2400x1200mm	2
Q/UF140	140x2400x1200mm	2
Q/UF150	150x2400x1200mm	2

PERIMETER STRIPS

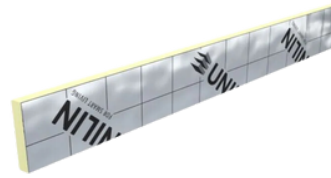

These insulation strips are designed to be placed around both external and internal wall/floor junctions, creating a robust thermal barrier.

Code	Sizes	Pack Quantity
Q/PS-25-100	25x100x1200mm	72
Q/PS-25-150	25x1200x225mm	45
Q/PS-25-200	25x200x1200mm	36
Q/PS-25-225	25x1200x225mm	45

ISOCAVITY



Mannok IsoCavity board is manufactured with profiled tongue-and-groove edges which aids installation, ensure continuity of insulation across the joint and eliminates any risk of moisture ingress.

Code	Sizes	Pack Quantity
Q/ISOCAV-090	90x1200x450mm	4
Q/ISOCAV-115	115x1200x450mm	4
Q/ISOCAV-140	140x1200x450mm	3

BAG CEMENT



Mannok Cement is a versatile product suitable for use in any building application, including concrete, mortar, plastering and screeding. Bags available in plastic or paper.

Code	Sizes	Pallet Quantity
Q/CEMENT	25kg	40

EPS WHITE



Mannok EPS boards are lightweight, versatile and a cost effective alternative to PIR insulation. The same U-values can be achieved at a lower cost.

Code	Sizes	Pack Quantity
QL/070W-100-2400	100x2400x1200mm	6
QL/070W-120-2400	120x2400x1200mm	5
QL/070W-150-2400	150x2400x1200mm	4
QL/070W-175-2400	175x2400x1200mm	3
QL/100W-100-2400	100x2400x1200mm	6
QL/100W-150-1200	150x2400x1200mm	4
QL/150W-150-2400	150x2400x1200mm	4
QL/200W-100-1000	100x500x1000mm	6
QL/200W-115-2400	115x2400x1200mm	6
QL/200W-130-1200	130x1200x600mm	6
QL/200W-180-1200	180x1200x600mm	3

*Other sizes available upon request

AIRCRETE BLOCK



Aircrete blocks are high performance thermal blocks which are precision manufactured using autoclaved aerated concrete (AAC) by advanced technical processes.

Code	Sizes
Q/QLB7001-100	100mm
QLQLB7001-215	215mm

EPS PEARL



Mannok EPS boards are lightweight, versatile and a cost effective alternative to PIR insulation. The same U-values can be achieved at a lower cost.

Code	Sizes	Pallet Quantity
QL/070G-040-1200	40x1200x600mm	15
QL/070G-040-2400	40x2400x1200mm	15
QL/070G-050-1200	50x1200x600mm	15
QL/070G-050-2435	50x2435x1197mm	15
QL/070G-060-2400	60x2400x1200mm	10
QL/070G-070-2400	70x2400x1200mm	9
QL/070G-080-2400	80x2400x1200mm	7
QL/070G-090-1200	90x2400x1200mm	20

*Other sizes available upon request

THERM CAVITY WALL



Mannok IsoCavity board is manufactured with profiled tongue-and-groove edges which aids installation, ensure continuity of insulation across the joint and eliminates any risk of moisture ingress.

Code	Sizes	Pack Quantity
Q/TCW-60	60x450x1200mm	24
Q/TCW-70	70x450x1200mm	24
Q/TCW-80	80x450x1200mm	24
Q/TCW-100	100x450x1200mm	24
Q/TCW-110	110x450x1200mm	28

**NEW
PRODUCT**



CERTIFIED FULL FILL CAVITY WALL INSULATION

UP TO 10MM RESIDUAL CAVITY

EASE OF INSTALLATION WHILST MAXIMISING
THE THERMAL PERFORMANCE OF THE WALL



Low Emissivity
Composite Foil
Facing



Profiled Tongue & Groove Edges
aid Installation and Ensure
Continuity of Insulation Across
the Joint



Moisture
Resistant



Reduced Cavity Width and
Build Cost



Easy Cut & Fit



Extremely Low U-Values



mannokbuild.com



technical@mannokbuild.com



STONEWOOL



Unilin Insulation's range of non-combustible, Euroclass 'A1' stonewool insulation provides surety when the highest fire performance is required.

Code	Size
XTRA/STW-070-075	75x600x1200mm
XTRA/STW-070-200	200x600x1200mm
XTRA/STW-120-100	100x600x1200mm
XTRA/STW-FF-120-100	100x600x1000mm
XTRA/STW-120-130	130x600x1200mm
XTRA/STW-120-150	150x600x1200mm
XTRA/STW-120-160	160x600x1200mm
XTRA/STW-120-16OFF	160x600x1200mm
XTRA/STW-120-1000-160	160x600x1000mm

THIN-R PIR

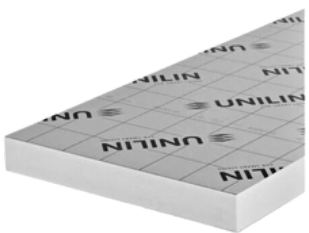

Unilin Insulation's Thin-R range is a high-performance, foil faced Polyisocyanurate (PIR) insulation with a certified thermal conductivity as Low as 0.022 W/mK.

Code	Size
XTRA/XTUF-025	25x2400x1200mm
XTRA/XTUF-050	50x2400x1200mm
XTRA/GA-070	70x2435x1200mm
XTRA/GA-080	80x2435x1200mm

*Other sizes available upon request

SAFE-R SOFFIT



Safe-R Soffit board provides effective thermal and fire performance solutions in structural ceiling applications in commercial and residential buildings.

Code	Size
XTRA/SR/SP/116	116x2400x1200mm
XTRA/SR/SP/126	126x2400x1200mm
XTRA/SR/ST/060	60x2400x1200mm
STRA/SR/ST/100	100x2400x1200mm
XTRA/SR/ST/100-PR	100x2400x1200mm
XT/SR/RS-100	100x2400x1200mm
XT/SR/STP-106	106x2400x1200mm

*Other sizes available upon request

XPS 300KPA

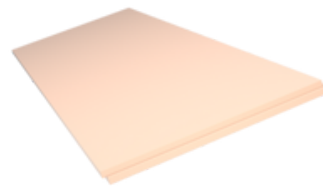

XPS 300 is a high performance rigid extruded polystyrene insulation board providing a durable thermal solution to technically demanding applications where high compressive loading is a requirement.

Code	Size
XTRA/300L-030	30x1250x600mm
XTRA/300L-040	40x1250x600mm
XTRA/300L-050	50x1250x600mm
XTRA/300L-060	60x1250x600mm
XTRA/300L-080	80x1250x600mm
XTRA/300L-100	100x1250x600mm
XTRA/300L-120	120x1250x600mm

XPS 500KPA

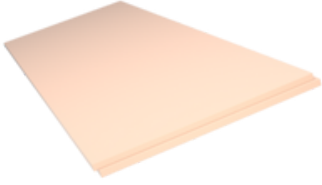

XPS 500 is a high performance rigid extruded polystyrene insulation board providing a durable thermal solution to technically demanding applications where high compressive loading is a requirement.

Code	Size
XTRA/500L-050	50x1250x600mm
XTRA/500L-100	100x1250x600mm
XTRA/500L-120	120x1250x600mm

XPS 700KPA

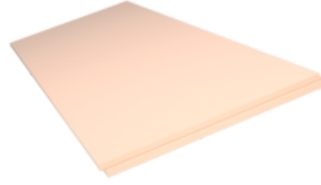

XPS 700 is a high performance rigid extruded polystyrene insulation board providing a durable thermal solution to technically demanding applications where high compressive loading is a requirement.

Code	Size
XTRA/700L-050	50x1250x600mm
XTRA/700L-100	100x1250x600mm
XTRA/700L-120	120x1250x600mm

XTROWALL

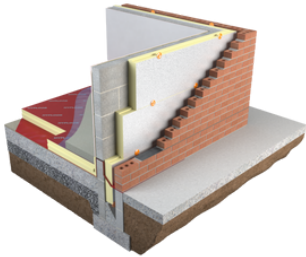

XtroWall is an innovative partial fill wall insulation system incorporating robust facings, engineered jointing details, preformed corners and a certified lambda of 0.021W/mK.

Code	Size	Quantity
XTRA/XO/CW-100	100x1200x450mm	2.16m ²
XTRA/XO/CW-110	110x1200x450mm	2.16m ²

XTROWALL PLUS

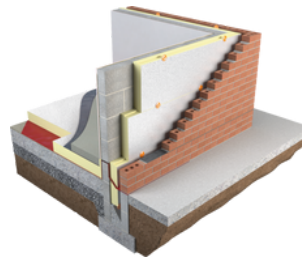

XtroWall Plus is a superior performance insulation with an Agrément declared lambda value of 0.020 W/mK. It is faced with a robust PIR aluminium foil.

Code	Size	Quantity
XTRA/XO/XWP-110	110x1200x450mm	2.16m ²

FIRELINE THERMAL LAMINATE



Safe-R Fireline Thermal Laminate is a composite insulated panel of Euroclass C-s1, d0 phenolic insulation bonded to 15mm Fireline plasterboard for internal applications.

Code	Size
XTRA/SR/TBFLMF/065/GYF15/SP06	65x2400x1200mm

*Other sizes available upon request

CAVITY THERM FULL FILL



CavityTherm wall insulation board is a high performance composite board of enhanced PIR core with a lambda value of 0.021 W/mK.

Code	Size	Pack Quantity
XTRA/XO/FF-100	100x1200x450mm	4
XTRA/XO/FF-125	125x1200x450mm	4
XTRA/XO/FF-150	150x1200x450mm	4

CAVITY INTERNAL CORNERS

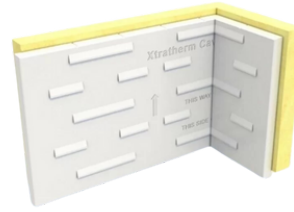

Cavity Internal Corners are used as a partial fill cavity wall insulation system to minimise the threat of Thermal Bridging and improve the overall U-Value of the wall.

Code	Size	Pack Quantity
XTRA/XO/IC-100	1200x450x100mm	4
XTRA/XO/IC-125	1200x450x125mm	4
XTRA/XO/IC-150	1200x450x150mm	4

CAVITY EXTERNAL CORNERS



CavityTherm's unique engineered profiled facing directs any moisture that might penetrate the external wall down the protective facing and back onto the external leaf, giving added protection from wind driven rain.

Code	Size	Pack Quantity
XTRA/XO/EC-100	100x1200x450mm	4
XTRA/XO/EC-125	125x1200x450mm	4
XTRA/XO/EC-150	150x1200x450mm	4



WARMLINE PIR PAPER



The Warmline insulated plasterboards are designed as a simple and effective way to improve the thermal efficiency in both walls and roof dwelling applications.

Code	Size	Pallet Quantity
U/WL/GA-029-2.438	29.5x2438x1200mm	60
U/WL/GA-032-2.438	32.5mmx2438x1200mm	-
U/WL/GA-038-2.4	38x2400x1200mm	55
U/WL/GA-050-2.4	50.5x2400x1200mm	40
U/WL/GA-053-2.438	53x2438x1200mm	-
U/WL/GA-062-2.4	62x2400x1200mm	33
U/WL/GA-072-2.4	72.5x2400x1200mm	28
U/WL/GA-082-2.438	82x2438x1200mm	24
U/WL/GA-088-2.4	88x2400x1200mm	-
U/WL/GA-092-2.438	92x2438x1200mm	22
U/WL/GA-102-2.438	102x2438x1200mm	-

*Board sizes available in 2700mm and 3000mm

WARMLINE XPS

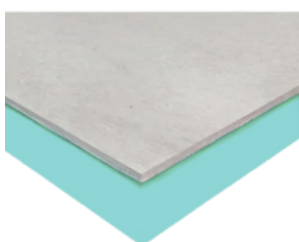

Used in External Wall Insulation (EWI) systems to secure insulation boards to the building's exterior wall to enhance thermal & acoustic insulation properties.

Code	Size
U/WLX27	27x2400x1200mm
U/WLX29	29x2400x1200mm
U/WLX35	35x2400x1200mm
U/WLX40	40x2400x1200mm
U/WLX45	45x2400x1200mm
U/WLX55	55x2400x1200mm

WARMLINE EPS

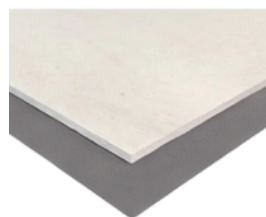

The Warmline insulated plasterboards are designed as a simple and effective way to improve the thermal efficiency in both walls and roof dwelling applications.

Code	Size
U/AG22PLAT	22x2400x1200mm
U/AG24	22.5x2438x1200mm
U/AG29	29x2435x1196mm
U/AG38PLAT	38x2435x1196mm
U/AG50PLAT	52x2435x1196mm
U/AG62PLAT	62x2435x1196mm
U/AG72PLAT	72x2435x1196mm

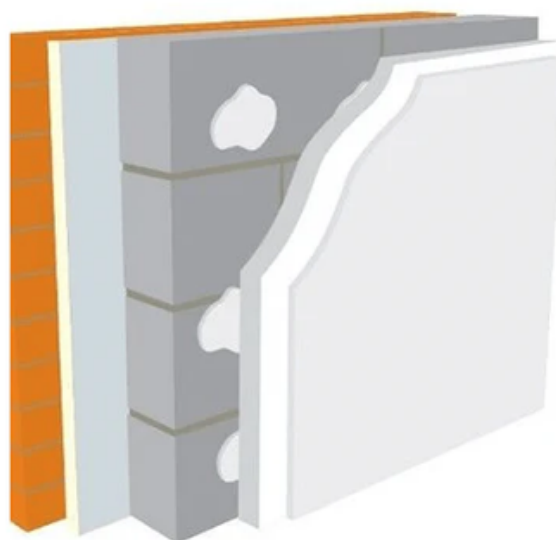

The Warmline insulating laminates are designed as a simple effective way to improve the thermal efficiency in both walls and roof applications. They are fully applicable with Part L of the building regulations.

KOOLTHERM RANGE

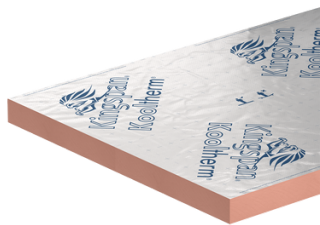

Kooltherm is a thin floor insulation board, It can be used in solid concrete or suspended timber floors. The range includes: K3, K5, K7, K8, K10, K12, K15, K103, K107 & K108.

Code	Size
K3/025-150	2400x1200mm
K5/030-100	1200x600mm
K7/030-150	2400x1200mm
K8/060-130	1200x450mm
K10/030-100	2400x1200mm
K12/025-150	2400x1200mm
K15/050-150	2400x1200mm
K103/025-150	2400x1200mm
K107/050-100	2400x1200mm
K108/090-120	1200x450mm

*Other sizes available upon request

KOOLTHERM K17

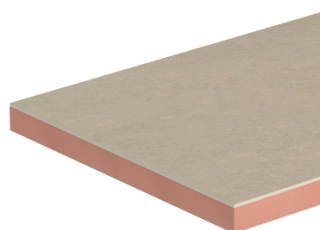

Kooltherm K17 is insulation, dry-lining and vapour control in one. This easy-to-install board is ideal for solid walls that would otherwise remain uninsulated.

Code	Size
K17/042.5	42.5x2400x1200mm
K17/052.5	52.5x2400x1200mm
K17/062.5	62.5x2400x1200mm

KOOLTHERM K18

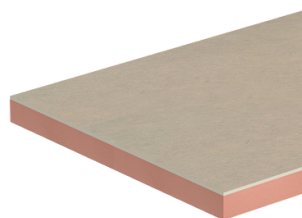

Kooltherm K18 is insulation, dry-lining and vapour control in one easy-to-fix board. It can be installed to battens mounted on either stonework or brickwork walls, with or without an existing lining.

Code	Size
K18/037.5	37.5x2400x1200mm
K18/042.5	42.5x2400x1200mm
K18/052.5	52.5x2400x1200mm
K18/062.5	62.5x2400x1200mm
K18/072.5	72.5x2400x1200mm
K18/082.5	82.5x2400x1200mm
K18/092.5	92.5x2400x1200mm
K18/102.5	102.5x2400x1200mm
K18/112.5	112.5x2400x1200mm

TW THERMAWALL

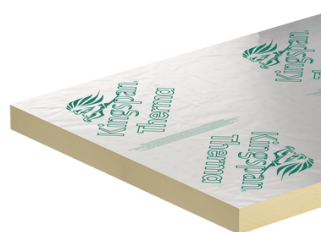

Thermawall TW is an insulation for timber frame and steel frame walls. These insulation boards are easy to cut, handle and install.

Code	Size	Pack Quantity
K/CW060	60x1200x450mm	7
K/CW080	80x1200x450mm	6
K/CW100	100x1200x450mm	5
K/CW110	110x1200x450mm	4

PIR UNDERFLOOR

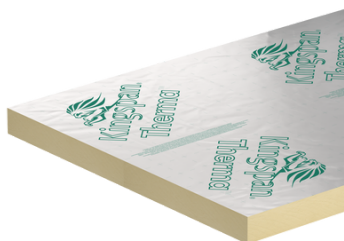

Kingspan PIR can be used in solid concrete or suspended timber floors and is ideal for both new build and refurbishment projects.

Code	Size	Pack Quantity
K/UF025	25x2400x1200mm	12
K/UF030	30x2400x1200mm	10
K/UF040	40x2400x1200mm	8
K/UF050	50x2400x1200mm	6
K/UF060	60x2400x1200mm	5
K/UF070	70x2400x1200mm	4
K/UF075	75x2400x1200mm	4
K/UF080	80x2400x1200mm	4
K/UF090	90x2400x1200mm	4
K/UF100	100x2400x1200mm	3
K/UF120	120x2400x1200mm	3
K/UF125	125x2400x1200mm	3
K/UF130	130x2400x1200mm	2
K/UF150	150x2400x1200mm	2

THERMAROOF 26

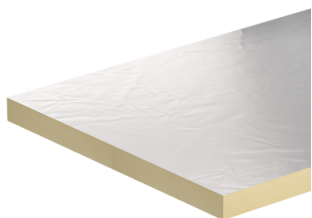

Thermaroom TR26 is a PIR, flat-roof insulation board, offering a thermal conductivity of 0.022 W/mK. It is fully compatible with most mechanically-fixed, single-ply waterproofing systems and most green roof systems.

Code	Size	Pack Quantity
K/TR26-060	60x2400x1200mm	5
K/TR26-070	70x2400x1200mm	4
K/TR26-120	120x2400x1200mm	3

THERMAROOF 24

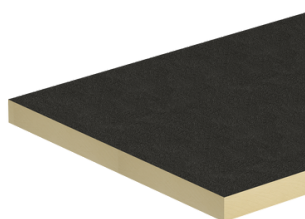

Thermaroom TR24 is a PIR insulation board for flat roofs, offering a thermal conductivity of 0.024 - 0.027 W/mK. It is compatible with the majority of torch applied waterproofing systems.

Code	Size	Pack Quantity
K/TR24-0600-100	100x1200x600mm	5
K/TR24-0600-120	120x1200x600mm	4
K/TR24-1200-050	50x1200x1200mm	6
K/TR24-1200-100	100x1200x1200mm	2
K/TR24-1200-120	120x1200x1200mm	2
K/TR24-1200-140	140x1200x1200mm	2

THERMAROOF 27



Thermaroom TR27 is a high performance PIR, flat-roof insulation for use on roofs waterproofed with fully-adhered, single-ply, partially-bonded, built-up felt, mastic asphalt or cold liquid applied waterproofing.

Code	Size	Pack Quantity
K/TR27-1200-050	50x1200x1200mm	6
K/TR27-1200-080	80x1200x1200mm	2
K/TR27-1200-100	100x1200x1200mm	2
K/TR27-1200-120	120x1200x1200mm	2
K/TR27-1200-130	130x1200x1200mm	2

GREEN GUARD XPS

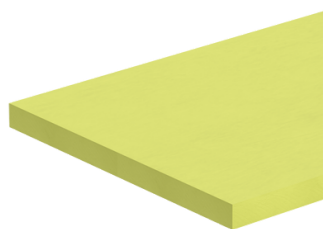

GreenGuard XPS has the necessary compressive strength to make it the product of choice for specialist applications such as inverted roofs, basements, car park decks and heavy-duty commercial, etc.

Code	Size	Compressive Strength	Pack Quantity
K/STY-N300R-030	30x1250x600mm	N300	14
K/STY-N300R-050	50x1250x600mm	N300	8
K/STY-N300R-060	60x1250x600mm	N300	7
K/STY-N300R-060-2500	60x2500x600mm	N300	7
K/STY-N300R-080	80x1250x600mm	N300	5
K/STY-N300R-100	100x1250x600mm	N300	4
K/STY-N300R-120	120x1250x600mm	N300	2
K/STY-N500R-050	50x1250x600mm	N500	8
K/STY-N500R-080	80x1250x600mm	N500	5
K/STY-N500R-100	100x1250x600mm	N500	4
K/STY-N700R-050	50x1250x600mm	N700	8
K/STY-N700R-060	60x1250x600mm	N700	7
K/STY-N700R-080	80x1250x600mm	N700	5

AEROBOARD

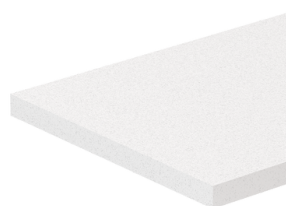

Our range of high performance, rigid EPS insulation boards are suitable for use in heavy-duty floor applications. With high compressive strength, our products are available in various grades, suitable for a range of service loads.

Code	Size	Colour	Pack Quantity
K/070G-150-1800	150x1800x1200mm	Grey	4
K/070W-150-1800	150x1800x1200mm	White	4

*Other sizes available upon request

K-ROC RAINSCREEN

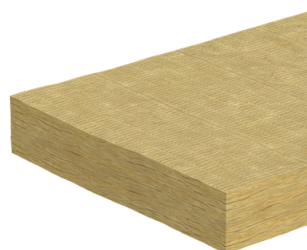

For buildings with complex designs, high aesthetics or requiring a ventilated facade, Kingspan ventilated and non-ventilated rainscreens provide fast-build, high technical performance solutions.

Code	Size	Pack Quantity
K/KROCRS-80	80x1200x600mm	6
K/KROCRS-100	100x1200x600mm	5
K/KROCRS-110	110x1200x600mm	4
K/KROCRS-120	120x1200x600mm	4
K/KROCRS-150	150x1200x600mm	3

XPS 300L

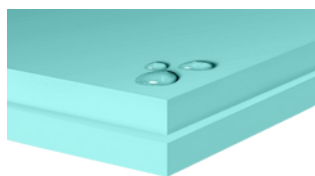

FIBRANxps 300-L is a thermal insulation board made of extruded polystyrene, having a smooth surface and edges in the shape of letter "L" to prevent the formation of thermal bridges.

Code	Size	Pack Quantity	Coverage
FIB/300L-030	30x1250x600mm	10	7.5m ²
FIB/300L-040	40x1250x600mm	14	10.5m ²
FIB/300L-050	50x1250x600mm	8	6.0m ²
FIB/300L-060	60x1250x600mm	7	5.25m ²
FIB/300L-080	80x1250x600mm	5	3.75m ²
FIB/300L-100	100x1250x600mm	4	3.0m ²
FIB/300L-120	120x1250x600mm	3	2.25m ²

MAESTRO XPS

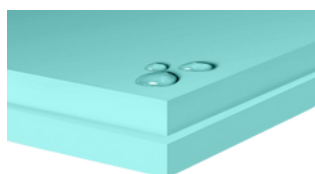

FIBRANxps MAESTRO is a thermal insulation board made of extruded polystyrene, having a smooth surface and tongue and grooved edges to prevent the formation of thermal bridges.

Code	Size	Pack Quantity	Coverage
FIB/M-060-2600	60x2600x600mm	7	10.92m ²

XPS 500L

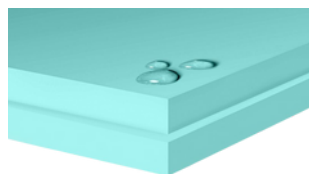

FIBRANxps 500-L is a thermal insulation board made of extruded polystyrene, having a smooth surface and edges in the shape of letter "L" to prevent the formation of thermal bridges.

Code	Size	Pack Quantity	Coverage
FIB/500L-050	50x1250x600mm	8	6.0m ²
FIB/500L-080	80x1250x600mm	5	3.0m ²
FIB/500L-100	100x1250x600mm	4	3.0m ²

XPS 700L

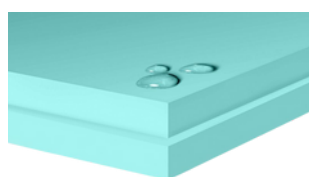

FIBRANxps 700-L is a thermal insulation board made of extruded polystyrene, having a smooth surface and edges in the shape of letter "L" to prevent the formation of thermal bridges.

Code	Size	Pack Quantity	Coverage
FIB/700L-050	50x1250x600mm	8	6.0m ²
FIB/700L-100	100x1250x600mm	4	3.0m ²
FIB/700L-120	120x1250x600mm	3	2.25m ²

EASY LIGHT 44



Volcalis EASY, mineral wool roll with or without coating. Light and easy to apply, with good thermal and acoustic performance. Suitable for roofs and ceilings. Thermal conductivity of **0.044W/mK**.

Code	Sizes	Coverage	Pallet Quantity
VOL/L44-100	100x1200x12000mm	14.4m ²	24
VOL/L44-150	150x1200x8000mm	9.6m ²	24
VOL/L44-200	200x1200x6000mm	7.2m ²	24

ALPHA ROLL 35



Volcalis ALPHA, mineral wool is a non-combustible roll, of very low thermal conductivity, and excellent acoustic performance. Suitable for partitions, walls and ceilings Thermal conductivity of **0.035W/mK**.

Code	Sizes	Coverage	Pallet Quantity
VOL/C35-100-600	100x1200x6000mm	7.2m ²	24
VOL/C35-140	140x1200x4000mm	4.8m ²	24

EASY 40 COMBI



Volcalis EASY is an excellent thermal and acoustic insulation for application in all types of buildings, with pre cuts for easy installation. Thermal conductivity of **0.040W/mK**.

Code	Sizes	Coverage	Pallet Quantity
VOL/FC40-090-COMBI	90x1200x9000mm	10.8m ²	24
VOL/FC40-100-COMBI	100x1200x8000mm	9.6m ²	24
VOL/FC-140-COMBI	140x1200x6000mm	7.2m ²	24
VOL/FC40-150-COMBI	150x1200x5600mm	6.72m ²	24
VOL/FC40-200-COMBI	200x1200x4600mm	5.52m ²	24

ALPHA PLUS 32



Volcalis ALPHA PLUS, mineral wool with high thermal resistance. With excellent thermal and acoustic properties. Suitable for partitions, walls, roofs and ceilings. Thermal conductivity of **0.032W/mK**.

Code	Sizes	Coverage	Pallet Quantity
VOL/C32-100-SOLID	100x1200x3500mm	4.2m ²	24
VOL/C32-120	120x1200x3000mm	3.6m ²	24
VOL/C32-140-SOLID	140x1200x2500mm	3.0m ²	24
VOL/C32-160-SOLID	160x1200x2200mm	2.64m ²	24

ALPHA ROLL 34



Volcalis ALPHA is an excellent thermal and acoustic insulation suitable for use in construction and rehabilitation works, such as: partitions, wall lining and ceilings. Thermal conductivity of 0.034W/mK.

Code	Sizes	Coverage	Pallet Quantity
VOL/C34-050	50x1200x9300mm	11.16m ²	24
VOL/C34-100	100x1200x5000mm	6.0m ²	24
VOL/C34-150	150x1200x3300mm	3.96m ²	24
VOL/C34-180	180x1200x2700mm	3.24m ²	24
VOL/C34-200	200x1200x2500mm	3.0m ²	24
VOL/C34-220	220x1200x2200mm	2.64m ²	24

INSULATION KNIFE









A Insulation knife with a 50 mm wide, flexible blade and scale. Its serrated blade makes it easy to cut through all types of insulation wool.

Code	Size
VOL/L-KNIFE	465mm



Volcalis Applications

Recommended applications

	 Partitions	 Wall lining	 Ceilings	 Pitched roofs	 Metal roofs	 Metal facades	 Ventilated facades	Page
EASY								
Roll Kraft Paper			●	●				6
Roll			●		●			7
Roll Alu Kraft				●				7
Reinforced Roll						●		7
COMFORT								
Slab	●	●	●					8
Roll	●	●	●					8
Slab Kraft Paper		●	●					9
Slab SR		●						9
Roll Black Veil							●	9
ALPHA								
Slab	●	●	●					10
Roll	●	●	●					10
Slab Kraft Paper		●	●					11
Slab Black Veil			●					11
Roll Black Veil							●	11
ALPHA PLUS								
Slab	●	●	●	●			●	12
Roll	●	●	●	●			●	13
Slab Kraft Paper		●	●	●				13

Volcalis product range

EASY
λ40



Mineral Wool in Roll

Volcalis **EASY**, mineral wool roll with or without coating. Light and easy to apply, with good thermal and acoustic performance.

COMFORT
λ37



Mineral Wool in Slab or Roll

Volcalis **COMFORT** is suitable for multiple applications, ideal for increasing the thermal and acoustic comfort of buildings.

ALPHA
λ35



Mineral Wool with improved performance

Volcalis **ALPHA**, mineral wool with improved performance. Non-combustible, of very low thermal conductivity, and excellent acoustic performance.

ALPHA PLUS
λ32



Mineral wool with high thermal resistance

Volcalis **ALPHA PLUS**, mineral wool in panel or roll with high thermal resistance. With excellent thermal and acoustic properties.

Guide for Rafters

The following sheet breaks down the size of each standard rafter, which Volcalis 32 roll fits into the rafter after leaving room for *airflow per regulations. With a breakdown of which Warmboard should be used to achieve the customers target U Value, with 0.16 being the standard industry performance.

The beauty of using the Volcalis 32 role here is that, as this is a better performer than a 34 roll which is most commonly used, you can use a smaller warmboard to reach the U Value performance required. As well as giving more headroom, this is saving the customer money both on the glasswool (As Volcalis is well priced) and the Warmboard (As it's a smaller board needed).

*Rafters must be counter-battened if a customer was filling the full void, to always allow for airflow.

Rafter	Volcalis Alpha Plus	Warmboard	U-Value
125mm (5 inch)	100mm	37.5mm	0.24 W/(m2K)
	100mm	50.5mm	0.21 W/(m2K)
	100mm	62.5mm	0.19 W/(m2K)
	100mm	72.5mm	0.17 W/(m2K)
	100mm	82.5mm	0.16 W/(m2K)
	100mm	92.5mm	0.15 W/(m2K)
	100mm	102.5mm	0.14 W/(m2K)
	100mm	112.5mm	0.13 W/(m2K)

150mm (6 inch)	120mm	37.5mm	0.21 W/(m2K)
	120mm	50.5mm	0.19 W/(m2K)
	120mm	62.5mm	0.17 W/(m2K)
	120mm	72.5mm	0.16 W/(m2K)
	120mm	82.5mm	0.15 W/(m2K)
	120mm	92.5mm	0.14 W/(m2K)
	120mm	102.5mm	0.13 W/(m2K)
	120mm	112.5mm	0.12 W/(m2K)

Rafter	Volcalis Alpha Plus	Warmboard	U-Value
175mm (7 inch)	140mm	37.5mm	0.19 W/(m2K)
	140mm	50.5mm	0.17 W/(m2K)
	140mm	62.5mm	0.16 W/(m2K)
	140mm	72.5mm	0.15 W/(m2K)
	140mm	82.5mm	0.14 W/(m2K)
	140mm	92.5mm	0.13 W/(m2K)
	140mm	102.5mm	0.12 W/(m2K)
	140mm	112.5mm	0.12 W/(m2K)

200mm (8 inch)	160mm	37.5mm	0.17 W/(m2K)
	160mm	50.5mm	0.16 W/(m2K)
	160mm	62.5mm	0.14 W/(m2K)
	160mm	72.5mm	0.14 W/(m2K)
	160mm	82.5mm	0.13 W/(m2K)
	160mm	92.5mm	0.12 W/(m2K)
	160mm	102.5mm	0.11 W/(m2K)
	160mm	112.5mm	0.11 W/(m2K)

225mm (9inch)	200mm	37.5mm	0.15 W/(m2K)
	200mm	50.5mm	0.13 W/(m2K)
	200mm	62.5mm	0.13 W/(m2K)

FLEXI SLAB



Flexi is suitable for acoustic and thermal insulation for partitions and thermal insulation for suspended floors, walls, and roofs.

Code	Sizes	Coverage	Pack Quantity	Pallet Quantity
RW/FLEXI-400-050	50x400x1200 mm	5.76m ²	12	24
RW/FLEXI-400-100	100x400x1200 mm	2.88m ²	6	30
RW/FLEXI-400-140	140x400x1200 mm	1.92m ²	4	24
RW/FLEXI-600-050	50x600x1200 mm	8.64m ²	16	12
RW/FLEXI-600-060	60x600x1200 mm	8.64m ²	12	12
RW/FLEXI-600-070	70x600x1200 mm	5.76m ²	8	16
RW/FLEXI-600-090	90x600x1200 mm	4.32m ²	6	20
RW/FLEXI-600-100	100x600x1200 mm	4.32m ²	6	20
RW/FLEXI-600-120	120x600x1200 mm	4.32m ²	6	16
RW.FLEXI-600-140	140x600x1200 mm	2.88m ²	4	16
RW/FLEXI-600-180	180x600x1200 mm	2.16m ²	3	12

ROLLBATT



ROCKWOOL Rollbatt is an all-round option for thermal and acoustic solutions for roof and loft spaces.

Code	Sizes	Pack Quantity	Pallet Quantity
RW/RB-400-100	100x3x400x4800mm	3	18
RW/RB-400-150-3.2	150x3x400x3200mm	3	18
RW/RB-600-100	100x2x600x4800mm	2	18
RW/RB-600-150-3.2	150x2x600x3200	2	18

RW3



RW3 is a robust insulation solution for a range of general building projects such as commercial, leisure, industrial buildings and more.

Code	Sizes	Coverage	Pack Quantity	Pallet Quantity
RW/RW3-025	25x600x1200 mm	11.52m ²	16	12
RW/RW3-030	30x600x1200 mm	10.80m ²	15	12
RW/RW3-040	40x600x1200 mm	7.20m ²	10	12
RW/RW3-050	50x600x1200 mm	5.76m ²	8	12
RW/RW3-060	60x600x1200 mm	4.32m ²	6	12
RW/RW3-075	75x600x1200 mm	4.32m ²	6	12
RW/RW3-090	90x600x1200 mm	3.60m ²	5	12
RW/RW3-100	100x600x1200 mm	2.88m ²	4	12
RW/RW3-50B Black	50x600x1200 mm	4.80m ²	8	15
RW/RW3-30W White	30x600x1200 mm	6.0m ²	10	12
RW/RW3-100F Foil	100x600x1200 mm	2.40m ²	4	15

RW4



ROCKWOOL RW4 is a robust insulation solution for a range of general building projects as well as specialist specifications.

Code	Sizes	Coverage	Pack Quantity	Pallet Quantity
RW/RW4-050	50x600x1200 mm	4.32m ²	3	18
RW/RW4-075	75x600x1200 mm	2.88m ²	3	18
RW/RW4-100	100x600x1200 mm	2.16m ²	2	18

RWA45



RWA45 is a robust insulation solution for a range of general building projects such as commercial, leisure, industrial buildings and more.

Code	Sizes	Coverage	Pack Quantity	Pallet Quantity
RW/RW45-25	25x600x1200 mm	11.52m ²	16	12
RW/RW45-30	30x600x1200 mm	8.64m ²	12	16
RW/RW45-40	40x600x1200 mm	8.64m ²	12	16
RW/RW45-50	50x600x1200 mm	6.48m ²	9	16
RW/RW45-60	60x600x1200 mm	5.76m ²	8	16
RW/RW45-75	75x600x1200 mm	4.32m ²	6	20
RW/RW45-100	100x600x1200 mm	2.88m ²	4	20

FULL FILL CAVITY



Full Fill Cavity Batt is a semi-rigid, insulation solution for masonry cavity wall constructions, suitable for use in new builds or extensions.

Code	Sizes	Coverage	Pack Quantity	Pallet Quantity
RW/FFCAVITY-050	50x455x1200 mm	6.55m ²	12	15
RW/FFCAVITY-075	75x455x1200 mm	4.91m ²	9	15
RW/FFCAVITY-080	80x455x1200 mm	4.37m ²	8	15
RW/FFCAVITY-100	100x455x1200 mm	3.28m ²	6	25
RW/FFCAVITY-150	150x455x1200 mm	2.18m ²	4	25

RW5



RW5 is a robust insulation solution for a range of general building projects such as commercial, leisure, industrial buildings and more.

Code	Sizes	Coverage	Pack Quantity	Pallet Quantity
RW/RW5-025	25x600x1200 mm	5.76m ²	8	24
RW/RW5-030	30x600x1200 mm	5.76m ²	8	20
RW/RW5-050	50x600x1200 mm	2.88m ²	4	24
RW/RW5-075	75x600x1200 mm	2.16m ²	3	20
RW/RW5-100	100x600x1200 mm	1.44m ²	2	24

HIGH PERFORMANCE PARTIAL FILL CAVITY SLAB



High Performance Partial Fill Cavity Slab has been developed to provide effective thermal insulation for both masonry and frame constructions.

Code	Sizes	Coverage	Pack Quantity	Pallet Quantity
RW/PTCAVITY-050	50x455x1200 mm	4.37m ²	8	15
RW/PTCAVITY-080	80x455x1200 mm	4.37m ²	8	10
RW/PTCAVITY-100	100x455x1200 mm	3.28m ²	6	10
RW/PTCAVITY-120	120x455x1200 mm	2.73m ²	5	10
RW/PTCAVITY-150	150x455x1200 mm	2.18m ²	4	10
RW/PTCAVITY-170	170x455x1200 mm	2.18m ²	4	10

STEEL FRAME SLAB



Steel Frame Slab is a semi-rigid insulation designed specifically for use between the studs in light gauge steel frame wall constructions.

Code	Sizes	Coverage	Pack Quantity	Pallet Quantity
RW/SFS-100	100x600x1200mm	4.32m ²	6	12
RW/SFS-120	120x600x1200mm	3.60m ²	5	12
RW/SFS-150	150x600x1200mm	2.88m ²	4	12

TIMBER FRAME SLAB



Timber Frame Slab has been engineered with an optimal density offering a low thermal conductivity, with fire and acoustic performance.

Code	Sizes	Coverage	Pack Quantity	Pallet Quantity
RW/TIM-090	90x570x1200mm	4.10m ²	6	12
RW/TIM-140	140x570x1200mm	2.74m ²	4	12
RW/TIM-140	140x400x1200mm	1.92m ²	4	18

NYROCK FRAME SLAB 032



Non-combustible thermal stone wool insulation designed specifically for use within timber and steel frames.

Code	Sizes	Coverage	Pack Quantity	Pallet Quantity
RW/NYSLAB-90	90x570x1200mm	2.74m ²	4	12
RW/NYSLAB-100	100x600x1200mm	2.16m ²	3	16
RW/NYSLAB-120	120x600x1200mm	1.44m ²	2	20
RW/NYSLAB-140	140x570x1200mm	2.05m ²	3	12
RW/NYSLAB-150	150x600x1200mm	1.44m ²	2	16



NYROCK CAVITY 032 PARTIAL FILL



NyRock Cavity Slab 032 is a full and partial fill stone wool slab designed for the thermal insulation of masonry cavity walls.

Code	Sizes	Coverage	Pack Quantity	Pallet Quantity
RW/NR-CAVITY32-50	50x455x1200 mm	4.37m ²	8	15
RW/NR-CAVITY32-75	75x455x1200 mm	2.18m ²	4	20
RW/NR-CAVITY32-85	85x455x1200 mm	2.18m ²	4	15

NYROCK CAVITY 032 FULL FILL



NyRock Cavity Slab 032 is a full and partial fill stone wool slab designed for the thermal insulation of masonry cavity walls. Suitable for partial or full fill applications.

Code	Sizes	Coverage	Pack Quantity	Pallet Quantity
RW/NR-CAVITY32-100	100x455x1200 mm	2.18m ²	4	15
RW/NR-CAVITY32-125	125x455x1200 mm	1.64m ²	3	15
RW/NR-CAVITY32-150	150x455x1200 mm	1.09m ²	2	20
RW/NR-CAVITY32-160	160x455x1200 mm	1.09m ²	2	20
RW/NR-CAVITY32-200	200x455x1200 mm	1.09m ²	2	15

NYROCK RAINSCREEN 032



NyRock Rainscreen is designed for use within ventilated cladding systems, as well as sealed systems such as curtain walling.

Code	Sizes	Coverage	Pack Quantity	Pallet Quantity
RW/NR-RSCREEN-50	50x1200x600 mm	4.32m ²	6	16
RW/NR-RSCREEN-60	60x1200x600 mm	4.32m ²	6	12
RW/NR-RSCREEN-70	70x1200x600 mm	2.88m ²	4	16
RW/NR-RSCREEN-75	75x1200x600 mm	2.88m ²	4	16
RW/NR-RSCREEN-80	80x1200x600 mm	2.88m ²	4	16
RW/NR-RSCREEN-85	85x1200x600 mm	2.16m ²	3	20
RW/NR-RSCREEN-90	90x1200x600 mm	2.88m ²	4	12
RW/NR-RSCREEN-100	100x1200x600 mm	2.16m ²	3	16
RW/NR-RSCREEN-110	110x1200x600 mm	2.16m ²	3	12
RW/NR-RSCREEN-115	115x1200x600 mm	2.16m ²	3	12
RW/NR-RSCREEN-125	125x1200x600 mm	2.16m ²	3	12
RW/NR-RSCREEN-135	135x1200x600 mm	2.16m ²	3	12
RW/NR-RSCREEN-150	150x1200x600 mm	1.44m ²	2	16
RW/NR-RSCREEN-165	165x1200x600 mm	1.44m ²	2	12
RW/NR-RSCREEN-180	180x1200x600 mm	1.44m ²	2	12
RW/NR-RSCREEN-200	200x1200x600 mm	1.44m ²	2	12

RAINSCREEN DUOSLAB



RainScreen Duo Slab® is a BBA-approved insulation product, that in addition to thermal comfort, provides an independently-tested acoustic benefit.

Code	Size	Coverage	Pack Quantity	Pallet Quantity
RW/RSCREEN-050	50x600x1200 mm	5.76m ²	8	12
RW/RSCREEN-060	60x600x1200 mm	4.32m ²	6	12
RW/RSCREEN-075	75x600x1200 mm	4.32m ²	6	12
RW/RSCREEN-080	80x600x1200 mm	2.88m ²	4	16
RW/RSCREEN-090	90x600x1200 mm	2.88m ²	4	12
RW/RSCREEN-100-46.08	100x600x1200 mm	2.88m ²	4	12
RW/RSCREEN-110-46.08	110x600x1200 mm	2.88m ²	4	12
RW/RSCREEN-120	120x600x1200 mm	2.88m ²	4	12
RW/RSCREEN-125	125x600x1200 mm	2.88m ²	4	12
RW/RSCREEN-130	130x600x1200 mm	2.16m ²	3	12
RW/RSCREEN-140	140x600x1200 mm	2.16m ²	3	12
RW/RSCREEN-150-PK	150x600x1200 mm	2.16m ²	3	12
RW/RSCREEN-160	160x600x1200 mm	1.44m ²	2	16
RW/RSCREEN-170	170x600x1200 mm	1.44m ²	2	16
RW/RSCREEN-180	180x600x1200 mm	1.44m ²	2	16
RW/RSCREEN-190	190x600x1200 mm	1.44m ²	2	12
RW/RSCREEN-200-23.04	200x600x1200 mm	1.44m ²	2	12
RW/RSCREEN-220	220x600x1200 mm	1.44m ²	2	12
RW/RSCREEN-225	225x600x1200 mm	1.44m ²	2	12

SOFFIT SLAB

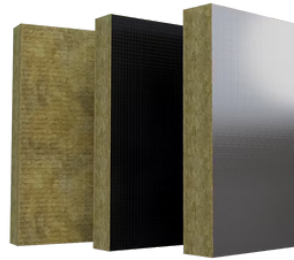

Soffit Slab is manufactured using, non-combustible stone wool insulation that provides thermal and acoustic insulation, as well as up to four hours of fire protection.

Code	Size	Coverage	Pallet Quantity
RW/SOFFIT-050 Plain	50x600x1000mm	57.6m ²	96
RW/SOFFIT-130 Plain	130x600x1000mm	21.60m ²	36
RW/SOFFIT-160 Plain	160x600x1000mm	19.60m ²	32
RW/SOFFIT-F-130 Foil	130x600x1000mm	21.60m ²	36
RW/SOFFIT-F-145 Foil	145x600x1000mm	19.20m ²	32
RW/SOFFIT-F-160 Foil	160x600x1000mm	19.20m ²	32
RW/SOFFIT-BT-130 Black	130x600x1000mm	21.60m ²	36
RW/SOFFIT-BT-160 Black	160x600x1000mm	19.20m ²	32
RW/SOFFIT-WT-130 White	130x600x1000mm	21.60m ²	36

HIGH-IMPACT SOFFIT SLAB



High-Impact Soffit Slab is manufactured using, non-combustible stone wool insulation that provides thermal and acoustic insulation, as well as up to four hours of fire protection.

Code	Size	Coverage	Pallet Quantity
RW/HISOFFIT-136	136x600x1200mm	23.04m ²	32
RW/HISOFFIT-166	166x600x1200mm	17.28m ²	24

ACOUSTIC ROLL



Acoustic Roll is a glass mineral wool roll, designed for use in internal wall and floor applications, offering sound absorption and noise reduction properties.

Code	Sizes	Pallet Quantity
KNA/G/APR-025	25x11100x2400mm	24
KNA/G/APR-050-16.2	50x13500x1200mm	24
KNA/G/APR-100-12.36	100x9170x1200mm	24

LOFT ROLL 44



Loft Roll 44 is a glass mineral wool roll, designed for insulating cold pitched roofs at ceiling level. It offers thermal conductivity of 0.044 W/mK.

Code	Sizes	Pallet Quantity
KNA/G/LR44-100	150x1140x8050mm	24
KNA/G/LR44-150	150x8050x1140mm	24
KNA/G/LR44-200	200x6000x1140mm	24

OMNIFIT STUD



OmniFit Roll 40 is a Glass Mineral Wool roll, designed for use in multiple applications that offers excellent thermal and acoustic performance.

Code	Sizes	Pallet Quantity
KNA/G/OMNIST34-100	100x1200x5200mm	24
KNA/G/OMNIST34-150	150x1200x3500mm	24
KNA/G/OMNIST34-180	180x1200x3000mm	24



RAINSCREEN SLAB



Knauf Rainscreen is a non-combustible with the best possible Euroclass A1 reaction to fire classification, and is manufactured using our unique bio-based binder, ECOSE® Technology.

Code	Size	Pack Quantity	Pallet Quantity
KNA/R/RSCREEN-050	50x600x1200mm	8	12
KNA/R/RSCREEN-060	60x600x1200mm	7	12
KNA/R/RSCREEN-070	70x600x1200mm	6	12
KNA/R/RSCREEN-075	75x600x1200mm	6	16
KNA/R/RSCREEN-080	80x600x1200mm	5	12
KNA/R/RSCREEN-090	90x600x1200mm	5	12
KNA/R/RSCREEN-100	100x600x1200mm	4	12
KNA/R/RSCREEN-110	110x600x1200mm	4	12
KNA/R/RSCREEN-120	120x600x1200mm	4	10
KNA/R/RSCREEN-125	125x600x1200mm	4	10
KNA/R/RSCREEN-130	130x600x1200mm	3	12
KNA/R/RSCREEN-140	140x600x1200mm	3	12
KNA/R/RSCREEN-150	150x600x1200mm	3	12
KNA/R/RSCREEN-160	160x600x1200mm	3	10
KNA/R/RSCREEN-170	170x600x1200mm	3	10
KNA/R/RSCREEN-180	180x600x1200mm	3	10
KNA/R/RSCREEN-190	190x600x1200mm	2	12
KNA/R/RSCREEN-200	200x600x1200mm	2	12
KNA/R/RSCREEN-210	210x600x1200mm	2	12
KNA/R/RSCREEN-220	220x600x1200mm </td <td>2</td> <td>12</td>	2	12
KNA/R/RSCREEN-230	230x600x1200mm	2	12
KNA/R/RSCREEN-240	240x600x1200mm	2	10
KNA/R/RSCREEN-250	250x600x1200mm	2	10

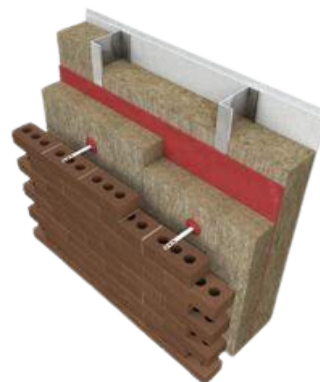

ACOUSTIC ROLL



A glass mineral wool roll contributing to the acoustic performance of partitions, walls and floors. Contributes to acoustic and thermal performance.

Code	Sizes	Coverage	Pallet Quantity
ISO/APR-025	25mmx20mx1.2m	24m ²	24
ISO/APR-050-15.6	50mmx13mx1.2m	15.6m ²	24
ISO/APR-075	75mmx12mx1.2m	14.64m ²	24
ISO/APR-100-11	100mmx9.71mx1.2m	11m ²	24

METAC ROLL



A mineral wool insulation roll typically used in the pitched roof application. Contributes to acoustic & thermal performance, as well as energy savings.

Code	Sizes	Coverage	Pallet Quantity
ISO/MET-050	50x1200x9300mm	11.16m ²	18
ISO/MET-100	100x1200x6000mm	7.2m ²	18
ISO/MET-150	150x1200x4100mm	4.92m ²	18
ISO/MET-180	180x1200x3400mm	4.08m ²	18
ISO/MET-220	220x1200x2900mm	3.48m ²	18

CALIBEL



Calibel is a glass wool insulation board composed of a mineral wool slab combined with a plasterboard lining.

Code	Sizes	Coverage	Pallet Quantity
ISO/CAL-42.5	42.5x2438x1200mm	2.92m ²	22

MODULAR ROLL



A glass mineral wool roll used for the thermal insulation of large areas in buildings. Vapour permeable insulation.

Code	Sizes	Coverage	Pallet Quantity
ISO/MOD-100	100x1200x9170mm	11m ²	24



TERMOLAN ROLL



TERMOLAN's products makes it easier to renew the air from the living spaces. It allows protection from sound aggression and improve the comfort of buildings.

Code	Sizes	Pallet Quantity
TER/ROLL-100	100x120x4500mm	18



ACOUSTIC ROLL



ODE Acoustic Roll is a glass mineral roll contributing to the acoustic performance of partitions, walls and floors as well as increasing energy performance.

Code	Sizes	Pallet Quantity
ODE/APR-025-LRG	25x1200x20000mm	24
ODE/APR-050-18kg	50x1200x10000mm	32
ODE/APR-075	75x1200x10000mm	24
ODE/APR-100-7.8	100x1200x6500mm	32

DUCT WRAP



Oriented Strand Board is used in residential and commercial construction for sub-flooring, roof sheathing, exterior sheathing and other residential and commercial construction applications.

Code	Size	Coverage
ODE/DW-025	25x1200x1800mm	19.2m ²



ADHESIVE C1W



C1W is an adhesive cement mortar intended for attaching mineral wool panels in the KLEiB W Thermal insulation system. High yield, vapour permeable, and increased adhesion.

Code	Sizes	Coverage
UVK/K-ADHESIVE-C1W	25kg	5m ²

POLYSTYRENE ADHESIVE C1



C1 is an adhesive cement mortar designed to attach EPS boards to a substrate in the KLEiB system. High yield and easily workable.

Code	Sizes	Coverage
UVK/K-ADHESIVE	25kg	5m ²

BASE COAT C2



C2 is a cement adhesive mortar for forming a base coat layer in the KLEiB system. It is suitable for fixing EPS boards on all typical, structurally sound substrates.

Code	Sizes	Coverage
UVK/K-BASECOAT	25kg	5m ²

BASE COAT C2B



KLEiB C2B is a cement adhesive mortar for forming a base coat layer in the KLEiB system. It is also suitable for fixing polystyrene panels on all typical, load-bearing and even mineral substrates.

Code	Sizes	Colour
UVK/K-BASECOAT-C2B	25kg	White

BASE COAT C2W



KLEiB C2W is an adhesive cement mortar intended for attaching mineral wool boards and adding a reinforced layer in the KLEiB W thermal insulation system.

Code	Sizes	Coverage
UVK/K-BASECOAT-C2W	25kg	5m ²

UNIVERSAL PRIMER C3



KLEiB C3 is a base primer intended for preparing the working surface before laying thin-layer mineral, acrylic and siloxane plasters in the KLEiB external thermal insulation composite system with plaster.

Code	Sizes	Coverage
UVK/K-PRIMER-UNI	15kg	50m ²

SILICONE PRIMER C3



KLEiB C3SIL is a base primer intended for substrate preparation prior to laying silicone render coats in the KLEiB external thermal insulation composite system.

Code	Sizes	Pallet Quantity
UVK/K-PRIMER-SIL	15kg	44

SILICONE RENDER C7



KLEiB C7 is intended for protective and decorative rendering coats in the external thermal insulation system with rendering coats. It can be used on any mineral and acrylic substrate which is adequately even and sound.

Code	Sizes	Pallet Quantity
UVK/K-REND-SILICONE-D	15kg	33
UVK/K-REND-SILICONE-P	15kg	33
UVK/K-REND-SILICONE-TR	15kg	33

LIGHTWEIGHT PLASTER C17



KLEiB C17 is a general purpose lightweight plastering mortar for mechanical application of traditional internal and external plasters. It can also be applied manually.

Code	Sizes	Pallet Quantity
UVK/K-C17	25kg	54

ACRYLIC RENDER C5



KLEiB C5 is dedicated for forming protective and decorative roughcast texture plaster in the external thermal insulation composite system with plaster.

Code	Sizes	Pallet Quantity
UVK/K-REND-ACRYLIC-D	15kg	33
UVK/K-REND-ACRYLIC-P	15kg	33
UVK/K-REND-ACRYLIC-TR	15kg	33

SILICONE EXTERNAL PAINT Q3



KLEiB Q3 is a façade silicone paint, intended primarily for painting thin-layer mineral and silicone plasters in the KLEiB and KLEiB W building insulation systems.

Code	Sizes	Colour
UVK/K-Q3-P	10ltr	Light
UVK/K-Q3-TR	10ltr	Dark

PLASTERING MORTAR C18



KLEiB C18 is a general-purpose plastering mortar for manual application of traditional internal and external plasters. It is waterproof and has excellent adhesion and flexibility.

Code	Sizes	Coverage
UVK/K-PRIMER-SILI	15kg	50m ²

BRICK RENDER C25



KLEiB C25 is a high quality plaster used to imitate architectural concrete & brick using various application tools. It is easy to apply, highly water resistant and can be mixed in any colour.

Code	Sizes	Pallet Quantity
UVK/K-BRICKREND-C25	16kg	3.6m2



AUXILLARY PRODUCTS - EWI

ALUMINIUM WINDOW SILL



The oversill is designed to extend the length of an existing windowsill, ensuring that it overhangs the insulation. With an added slot at the back of the sill is to slide in added insulation.

Code	Length	Colour
UVK/S-ALU-300-9005-BLACK	3m	Black
UVK/S-ALU-300-9010	3m	White

OVERSILL HYBRID

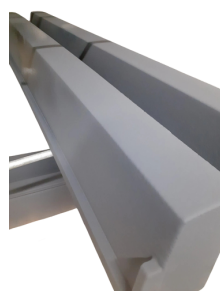

The oversill is designed to extend the length of an existing windowsill, ensuring that it overhangs the insulation. To be used with Expanda Composite Tape.

Code	Size
UVK/S-HYBRID	40x2400mm

AUXILLARY PRODUCTS - EWI

EXPANDING FOAM TAPE



Xpanda Expanding Foam Tape is a pre compressed open cell polyurethane foam backed roll with a self adhesive scrim tape to assist positioning.

Code	Gap Size	Tape Width
UVK/QT/XPANDA-5/26-15MM	5-10mm	15mm
UVK/QT/XPANDA-5/26-20MM	5-10mm	20mm
UVK/QT/XPANDA-5/26-25MM	5-10mm	25mm

PVC STARTER TRACK



The base starter track provides a level and secure starting point for the installation of rigid insulation boards on exterior walls. Made of PVC.

Code	Size
UVK/B-START+140	140-180mm

ALUMINIUM ENDCAP



Aluminium Endcaps serve as a protective component used to cover the open ends of various building materials. It ensures that exposed edges are aesthetically pleasing as well as protected from environmental factors.

Code	Colour	Pack Quantity
WUVK/ENDCAP-A-WHITE	White	2
WUVK/ENDCAP-A-BLACK	Black	2

BASE STARTER TRACK



The base starter track provides a level and secure starting point for the installation of rigid insulation boards on exterior walls.

Code	Size	Material
UVK/B-START-050	50x2500mm	Aluminium
UVK/B-START-103	103x2500mm	Aluminium
UVK/B-START-120	120x2500mm	Aluminium
UVK/B-START-140	140x2500mm	Aluminium
UVK/B-START-150	150x2500mm	Aluminium
UVK/B-START-200	200x2500mm	Aluminium

PVC MOVEMENT BEAD



PVC Movement Beads are used to accommodate movement in plaster, stucco, or render finishes. It helps prevent cracking in large or long sections of walls or ceilings by allowing for controlled expansion and contraction.

Code	Sizes
UVK/B-PVC-MB	4mmx2.5m

EWI CORNER BEAD W/MESH

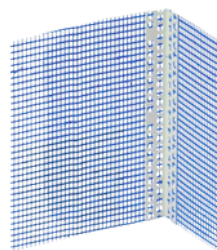

PVC Corner Bead is used to reinforce and protect the corners of walls, especially in plastering installations. It ensures straight, clean edges and prevents cracking or damage to these vulnerable areas.

Code	Length	Mesh
UVK/K-B-CORNER	2.5m	160g

AUXILLARY PRODUCTS - EWI

DROP DOWN VERGE



Drop Down Verge addresses the transition between the roof edge and the wall below, creating a neat, durable finish while protecting the structure from water ingress.

Code	Length	Colour
UVK/S-ALU-115-9005-BLACK	3m	Black
UVK/S-ALU-115-9010	3m	White

WINDOW BEAD W/MESH

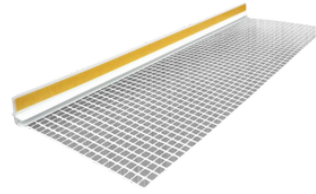

Window Bead is used to provide a clean, durable edge around window openings when applying plaster or render. It protects the edges, while maintaining a smooth finish.

Code	Sizes
UVK/B-WINDOW-6	3m
UVK/K-B-WINDOW	3m

STOP BEAD W/MESH

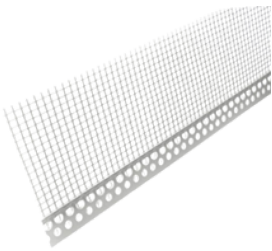

Stop Bead is used to create a clean, defined edge in drywall applications. It ensures the render finishes neatly while preventing cracks and providing additional strength.

Code	Length
UVK/B-STOP-6	6mm

ADHESIVE DRIP BEAD W/MESH

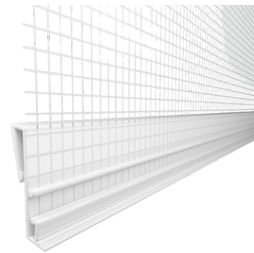

Adhesive Drip Bead is attached to the starter track to manage water runoff on external walls which helps reduce the risk of water damage, staining, or erosion of the materials below.

Code	Length
UVK/B-DRIP	2.5m

NYLON HAMMER W/PIN



Nylon Hammers with Pins are used to secure the starter track to the substrate.

Code	Size	Box Quantity
UVK/F-NYLON-40	40mm	200

EWI SPIRAL DOWELS



Spiral Dowels are used to secure all external fixing points in the EWI system including down pipes, rainwater pipes, light fittings, etc.

Code	Sizes	Pack Quantity
UVK/F-SPIRAL-50	50mm	25
UVK/F-SPIRAL-85	85mm	100

AUXILLARY PRODUCTS - EWI

G4 ALGI WASH



KLEIB G4 is a disinfectant used for the removal of microorganisms, fungi and algae from the surfaces of walls, facades, plaster, concrete, stone, paving and roofs without damaging them.

Code	Size
UVK/K-G4	5ltr

MESH ROLL



KLEIB Reinforced Mesh is to be applied within the basecoat layer in the KLEIB ETICS System.

Code	Coverage	Weight	Pallet Quantity
UVK/K-MESH	55m2	160kg	33

POLYCHLOROPRENE ADHESIVE



The adhesive provides excellent adhesion to typical building substrates such as plaster, brick, concrete, wood. You can also use KLEIB P2 to glue PIR boards with aluminium foil.

Code	Size
UVK/IZO-ADH-K14	750ml

ADHESIVE FOAM



KLEIB Adhesive Foam is a low-pressure polyurethane foam providing excellent adhesion, sealing and sound proofing. It is low-pressure and ultra-durable.

Code	Size
UVK/K-ADHESIVE-750	750ml

MS POLYMER ADHESIVE



MS Polymer has excellent adhesion to common construction materials. It can be applied on wet substrates and can be painted after curing, including water paints.

Code	Sizes	Colour
UVK/MS-POLY-CLEAR	290ml	White

EWI U VALUES GUIDE

Wall Structure	Insulation Material	Thermal Conductivity ($\lambda_{90/90}$) of Insulation (W/mK)	U-Value (thickness of insulation) W/m ² K					
			0.27	0.25	0.21	0.17	0.15	0.11
215mm Blockwork	EPS 70 White	0.038	125mm	140mm (0.24)	160mm	210mm	240mm	340mm
	EPS 70 Grey	0.031	100mm	110mm	140mm (0.20)	170mm	190mm	270mm
	Dual Density MF	0.036	120mm (0.26)	130mm	160mm (0.20)	200mm	220mm	300mm
215 Hollow Blockwork	EPS 70 White	0.038	130mm (0.26)	140mm (0.24)	170mm (0.20)	210mm	230mm	320mm
	EPS 70 Grey	0.031	100mm	110mm	140mm (0.20)	170mm	190mm	260mm
	Dual Density MF	0.036	120mm	130mm	160mm (0.20)	200mm	220mm	300mm
Concrete Block Cavity Wall (No Insulation)	EPS 70 White	0.038	120mm	130mm	160mm	200mm	230mm	310mm
	EPS 70 Grey	0.031	100mm (0.26)	110mm (0.24)	130mm	160mm	190mm	260mm
	Dual Density MF	0.036	110mm	120mm	150mm	190mm	220mm	300mm
Concrete Block Cavity Wall 100/100/100 (50mm Cavity insulation = 0.039W/mk)	EPS 70 White	0.038	70mm	80mm	110mm	150mm	180mm	260mm
	EPS 70 Grey	0.031	60mm (0.26)	70mm (0.24)	90mm	120mm	150mm	220mm
	Dual Density MF	0.036	70mm (0.26)	80mm (0.24)	100mm	140mm	170mm	250mm
Concrete Block Cavity Wall 100/100/100 (50mm Cavity insulation = 0.033W/mk)	EPS 70 White	0.038	60mm	70mm	100mm	140mm	170mm	260mm
	EPS 70 Grey	0.031	50mm	60mm	80mm	120mm	140mm	210mm
	Dual Density MF	0.036	60mm (0.26)	70mm	100mm (0.20)	130mm	160mm	240mm

*All calculations assume horizontal heat flow, unventilated cavities >25mm with a thermal resistance of 0.18m²K/W, 18mm of external render $\lambda=1.0$ W/mK. Concrete block thickness as specified - dense solid $\lambda=1.200$ W/mK, dense hollow $\lambda=1.280$ W/mK, medium dense internal $\lambda=0.500$ W/mK. 15mm plasterboard fixing dabs with a thermal resistance of 0.170m²K/W, 12.5mm plasterboard $\lambda=0.190$ W/mK, Grey EPS reference is the Silver EPS.

VARIABLE MEMBRANE



Ventos Membrane is a two-layer moisture variable high performance membrane and air seal. It is a light, dimensionally stable vapour barrier that is easy to install.

Code	Sizes
VETNOS/MEM-SDV	1.5mx50m

F1D SPLIT UNIVERSAL



F1-D Universal Split Release for sealing windows, doors, concrete, floor, wall junctions and masonry. Split liner for easy application. Can be plastered over.

Code	Sizes	Split	Colour
VENTOS/T/FIS-075	75mmx25m	15mm	Pink
VENTOS/T/FIS-100	100mmx25m	15mm	Pink
VENTOS/T/FIS-150	150mmx25m	15mm	Pink
VENTOS/T/FIS-200	200mmx25m	15mm	Pink

CONTROL MEMBRANE



Ventos Membrane is a two-layer vapour barrier and air seal for laying on roofs and walls indoors. It has a printed laying and cutting aid to assist with precision and accurate measurements.

Code	Sizes
VENTOS/MEM-SD2	3mx50m
VENTOS/MEM-SDC	1.5mx50m

SPLIT RELEASE WINDOW TAPE



Ventos Split-Release tape is used for internal airtight bonding and sealing of doors and window reveals. Several splits available. Cannot be plastered over.

Code	Sizes	Split	Colour
VENTOS/T-SR-45/15	60mmx25m	45/15mm	Green
VENTOS/T-SR-50/50	100mmx25m	50/50mm	Green
VETNOS/T-SR-85/15	100mmx25m	85/15mm	Green

AIRTIGHT SEALANT



Ventos Airtight Sealant is an internal adhesive, used for permanent connections of airtightness layers. This product is also an excellent solution for permanent bonding solutions.

Code	Sizes
VENTOS/S-310	310ml
VENTOS/S-600	600ml

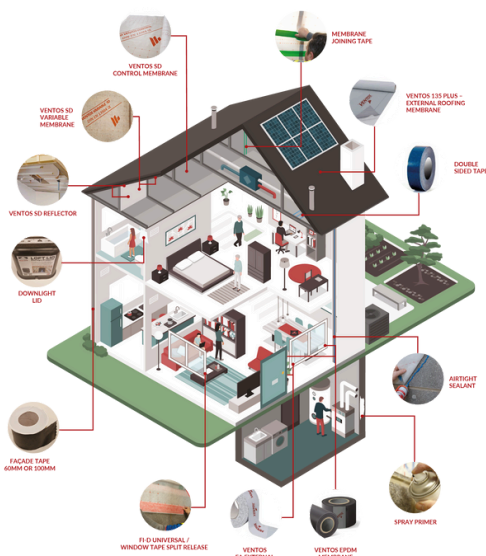

FACADE TAPE



Fully adhesive tape for exterior use. Due to the stretchability of the film, movements of the building structure are absorbed.

Code	Sizes	Colour
VENTOS/T/EXT-060	60mmx25m	Black
VENTOS/T/EXT-100	100mmx25m	Black
VENTOS/T/EXT-150	150mmx25m	Black

DOUBLE SIDE TAPE



Double sided tape to be used in place of staples on ceiling joists, rafters, metal studs and purlins for applying membrane.

Code	Sizes	Colour
VENTOS/T-DS-30	30mmx50m	Blue

MEMBRANE JOINING TAPE



Membrane Joining Tape is used for the continuous joining of membrane over laps.

Code	Sizes	Colour
VENTOS/T-KP-060	60mmx25m	Green



LOFT LID



Loft Lids create a protective barrier over downlights ensuring loft insulation does not directly contact the light fitting and that there is sufficient ventilation around the light for heat dissipation.

Code	Colour
FI/DLC1	Black

LOFT LEG



Loft Legs are used to avoid insulation compression when using your loft for storage. This product is strong, lightweight and easy to install.

Code	Pack Size
FI/LLEG	12

CONTRACT CAVITY CLOSER



ARC Contract-Closer closes the cavity around window and door openings. Contract-Closer helps prevent moisture, mould and staining from around windows and doors.

Code	Size	Pack Quantity
ARC/CC075	75x2400mm	8
ARC/CC100	100x2400mm	8
ARC/CC140-SF	140x2400mm	6
ARC/CC150	150x2400mm	6
ARC/CC150-SF	150x2400mm	6
ARC/CC160	160x2400mm	6
ARC/CC200	200x2400mm	4
ARC/CC220	220x2400mm	4

ECO CAVITY CLOSER

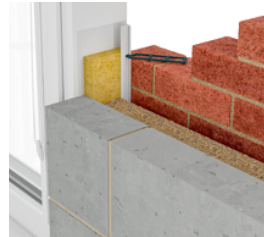

ARC Eco-Closer closes the cavity around window and door openings in masonry walls, providing up to 60 minutes fire integrity.

Code	Length	Pack Quantity
ARC/EC050	50x2400mm	8
ARC/EC100	100x2400mm	8
ARC/EC110	110x2400mm	8
ARC/EC125	125x2400mm	8
ARC/EC140	140x2400mm	8
ARC/EC150	150x2400mm	8
ARC/EC160	160x2400mm	8
ARC/EC175	175x2400mm	8

*Also available in single-flange

ECO-CLOSER PLUS



ARC Eco-Closer Plus closes wider cavities around window and door openings in masonry walls, providing up to two hours fire integrity.

Code	Size	Pack Quantity
ARC/EC160PLUS	160x2400mm	3
ARC/EC170PLUS	170x2400mm	5
ARC/EC175PLUS	175x2400mm	3
ARC/EC180PLUS	180x2400mm	3
ARC/EC200PLUS	200x2400mm	3

*Other sizes available upon request

BRICK TIE

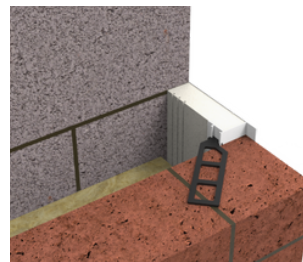

ARC Brick Ties are then used to build the closer in as the external brickwork progresses.

Code	Pack Quantity
ARC/BRICKTIES	100

CAVITY STOP SOCKS

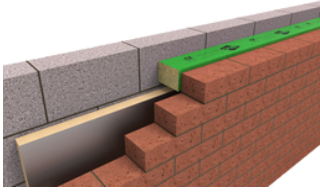

ARC Cavity Stop Sock restricts the spread of smoke and flames within the cavity of external masonry walls. It is ideally suited for providing a cavity barrier within the external wall cavity.

Code	Size	Pack Quantity
ARC/CSS090	110x100x1200mm	20
ARC/CSS100	120x100x1200mm	20
ARC/CSS110	120x120x1200mm	15
ARC/CSS115	130x120x1200mm	15
ARC/CSS120	135x120x1200mm	15
ARC/CSS130	140x120x1200mm	15
ARC/CSS140	150x120x1200mm	15
ARC/CSS145	155x120x1200mm	15
ARC/CSS150	160x120x1200mm	15
ARC/CSS155	165x120x1200mm	12

PARTY WALL STOP SOCK

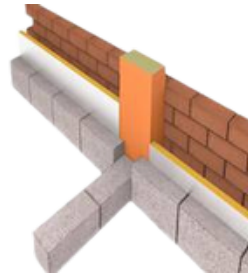

ARC's Party Wall Cavity Stop Sock is designed for use at the party wall junction; fitted in the external wall cavity, with a minimum 50mm overlap either side of the party wall cavity.

Code	Size	Pack Quantity
ARC/PWCSS130	135x250x1200mm	6
ARC/PWCSS150	155x250x1200mm	6
ARC/PWCSS170	175x250x1200mm	4
ARC/PWCSS175	180x250x1200mm	4

FIRE STOP SLAB

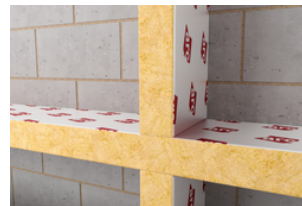

ARC Fire Stop Slab provides up to four hours of fire integrity horizontally and vertically within external wall cavities. It is particularly well suited for use with medium and high-rise projects.

Code	Size
ARC/FFS100	100x600x1200mm

THERMAL CAVITY BARRIER

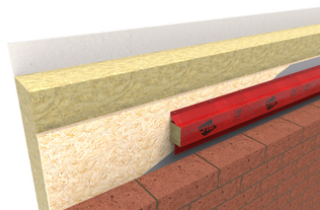

ARC TCB restricts the spread of smoke and flames within the cavity of timber frame walls, while also minimising the effect of flanking noise pollution.

Code	Size	Pack Quantity
ARC/TCB050	65x65x1200mm	40
ARC/TCB060	75x75x1200mm	35
ARC/TCB110	125x150x1200mm	12

*Other sizes available upon request

THE SIGNIFICANCE OF FIRE SAFETY COMPLIANCE

Fire protection is essential as part of any building project, and must be in compliance with UK Building Regulations. Failure to meet fire standards during inspection can result in fines or penalties.

<p>FIRE DOORS</p> <p>Buildings require FD30 or FD60 fire doors to be installed where there are fire escape routes or exits. Installation of fire doors ensures compliance with UK Building Regulations.</p>	<p>FIREPROOF PAINT</p> <p>Intumescent paints provide a layer of protection on elements of buildings which cannot be replaced. Suitable for lath-and-plaster walls and ceilings, heritage doors, steel, and more.</p>
<p>ELECTRICAL FAULTS</p> <p>Buildings must be in compliance with 18th Edition IEE Wiring Regulations. Failure can result in overloading sockets, causing serious fires within homes and buildings.</p>	<p>BUILDING CONTROL</p> <p>Inspections carried out by Building Control will record the condition and quality of buildings, ensuring that adequate fire protection is installed. Check with your local provider.</p>
<p>VENTILATION</p> <p>Buildings must ensure compliance with Document F of UK Building Regulations, carrying out maintenance for ventilation systems. Air quality must be to standard.</p>	<p>FIRE BARRIERS</p> <p>Installing cavity barriers within voids of buildings prevents dangerous smoke and flames spreading, and complies with Approved Document B of UK Building Regulations.</p>

FIRE COMPARTMENTATION

Containing fires to the room of origin helps prevent fires from ravaging throughout buildings and structures. Installing fire doors and fire-resistant wall elements can achieve passive fire compartmentation.

Fire Stopping and Effective Edge Sealing at the Party Wall and Eaves

Masonry construction with single spandrel panel



ARC Eaves Insulator

- Nail the plastic tray to the roof trusses
- A drops into the external cavity,
- B sits in the loft space above the ceiling
- A can be adjusted to ensure continuous insulation from the external cavity, over the wall plate into the loft
- Cut end sections to suit and make good

ARC Soffit Slab

- Simply cut to suit roof angle and brick height, ensuring a snug fit
- Fix to the truss using helical fixing provided

ARC T-Barrier Masonry

- Push fit into party wall cavity once blockwork has set
- External brickwork then fitted up against the barrier ensuring tight fit
- DPC overlap at the bottom onto length below

ARC Cavity Stop Sock

- Push fit into the top of the external wall cavity, held in place by compression fit

T-Barrier Foundation

- For use below DPC
- Push fit into party wall cavity
- External brickwork then fitted up against the barrier ensuring correct compression fit

ARC Wired Tile Batten Barrier

- The barrier should be scored to allow the batten to be installed within the rockfibre
- Work the material up the sides of the batten leaving enough material to fill the underside of the tile

ARC U-Barrier

- Simply push fit on to the top of the spandrel panel
- Lengths of ARC U-Barrier should be tightly butted together

ARC Spandrel Barrier

- A Push fit into the top of the party wall cavity
- B Spandrel panel sits on to the high density top of the barrier

ARC T-Barrier Pitched Roof

- Push fit into the top of the party wall cavity, held in place by compression fit

FITTING TIPS

These points should be adhered to when installing any fire barrier product:

- Barrier lengths butted tightly together, ensuring no gaps remain
- Where barriers meet at the roof line (party wall and gable ends), joints require mitre cuts so barriers achieve a tight fit
- At horizontal corners, cut lengths to suit

Fire Stopping and Effective Edge Sealing at the Party Wall and Eaves

Timber frame construction with full height double skin party wall



ARC Eaves Insulator

- Nail the plastic tray to the roof trusses
- A drops into the external cavity,
- B sits in the loft space above the ceiling
- A can be adjusted to ensure continuous insulation from the external cavity, over the wall plate into the loft
- Cut end sections to suit and make good

ARC Soffit Slab

- Simply cut to suit roof angle and brick height, ensuring a snug fit
- Fix to the truss using helical fixing provided

ARC T-Barrier Timber Frame

- Push fit into party wall cavity, staple flanges to timber frame at 600mm centres
- External brickwork then fitted up against the barrier ensuring correct compression fit

ARC TCB

- Push fit into the top of the external wall cavity, staple the top flange to the timber frame at 600mm centres

ARC Wired Tile Batten Barrier

- The barrier should be scored to allow the batten to be installed within the rockfibre
- Work the material up the sides of the batten leaving enough material to fill the underside of the tile

ARC T-Barrier Pitched Roof

- Push fit into the top of the party wall cavity, held in place by compression fit

ARC TCB Square around a pipe penetration

- Push fit over in situ pipe and staple to the timber frame at the top and bottom

T-Barrier Foundation

- For use below DPC
- Push fit into party wall cavity
- External brickwork then fitted up against the barrier ensuring correct compression fit

FITTING TIPS

These points should be adhered to when installing any fire barrier product:

- Barrier lengths butted tightly together, ensuring no gaps remain
- Where barriers meet at the roof line (party wall and gable ends), joints require mitre cuts so barriers achieve a tight fit
- At horizontal corners, cut lengths to suit

PIPEBLOC PCP



PipeBloc PCP is designed to provide a high volume expansion and pressure seal during a fire to combustible pipes that pass through floor and wall service openings.

Code	Size
FSI/PC-040	40mm
FSI/PC-055	55mm
FSI/PC-063	63mm
FSI/PC-082	82mm
FSI/PC-110	110mm
FSI/PC-125	125mm
FSI/PC-160	160mm

PIPEBLOC PWP



Pipebloc PWP is designed to provide a high volume expansion and pressure seal during a fire to combustible pipes that pass through floor and wall service openings.

Code	Size
FSI/PWP-040	40mm
FSI/PWP-055	55mm
FSI/PWP-063	63mm
FSI/PWP-082	82mm
FSI/PWP-110	110mm
FSI/PC-125	125mm
FSI/PC-160	160mm

FIRE PILLOW



S-Line Fire Pillow are a fire resistant penetration sealing system used to create a temporary or permanent fire barrier around single or multi-service penetrations to prevent the passage of fire through a compartment wall or floor.

Code	Size	Box Quantity
FSI/PILLOW-SAUS	330x50x20mm	50
FSI/PILLOW-SMALL	330x200x25mm	25
FSI/PILLOW/LARGE	330x200x45mm	12

PASS-IT TRANSIT SYSTEM

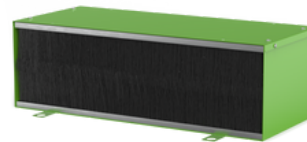

Pass-It Transit System is designed to prevent the passage of fire between compartment floors and walls, whilst still allowing for the easy installation and removal of services without destruction of the seal.

Code	Size
FSI/PASSIT_TYPEA	300x100x130mm
FSI/PASSIT_TYPEB	200x100x130mm
FSI/PASSIT_TYPEC	100x100x130mm
FSI/PASSIT_TYPED	300x100x150mm
FSI/PASSIT_TYPEE	200x100x150mm
FSI/PASSIT_TYPEF	100x100x150mm

PUTTY PAD



NS Putty® Pads are a pre-cut ablative pads designed for easy application around single and double electrical sockets where fire resistance must be upheld in the event of a fire.

Code	Size
FSI/PP-DOUBLE	230x170x4mm
FSI/PP-SINGLE	170x170x4mm

SILVERSEAL



Silverseal HS Compound is a fire-resistant Gypsum based mortar material used to reinstate the fire resistance performance of floor and wall constructions where apertures exist.

Code	Size
FSI/HSCOMP	20kg

FIREBATT



Fire Batt is a coated mineral wool board used to reinstate the fire rating of wall and floor constructions where they have been penetrated by services.

Code	Size	Pallet Quantity
FSI/FIREBATT-50-D	50x600x1200mm	48
FSI/FIREBATT-60-D	60x600x1200mm	42

PYROCOUSTIC SEALANT



Fire Resistant Sealant is a water based, acrylic, ablative sealant. Pyrocoustic® is used to reinstate the fire resistance of wall and floor constructions in linear gap seals, and where apertures are penetrated by single or multiple services.

Code	Size	Box Quantity
FSI/FRSEAL-310-WHITE	310ml	25
FSI/FRSEAL-F-600-WHITE	600ml	15

SILICONE PYROLASTIC



Pyrolastic® Silicone is a fire-resistant silicone sealant. It is used to reinstate the fire resistance of wall and floor construction in linear joints and where apertures are penetrated by services.

Code	Size	Box Quantity
FSI/SEAL-310-DAT	310ml	25

HPE SEALANT



HPE Sealant is designed to provide a high-volume expansion and pressure seal during a fire for areas where combustible services penetrate apertures in floors and walls that are designed to provide compartmentation.

Code	Size	Box Quantity
FSI/SEAL-HPE-310-GREY	310ml	25

PARAFLAM



Paraflam® is a non-combustible stone wool based product with a foil facing which prevents fibre migration and provides an excellent seal.

Code	Size
FSI/SEB/UFCB-100	100x1200x1000mm

PIPEBLOC EL



PipeBloc® PWP Wraps are designed and tested to seal service penetration apertures containing plastic pipes formulated with thermoplastic composites based on reactive intumescent technology.

Code	Size
FSI/PWPEL	2mmx25m

PS COAT



PS Coating is an ablative brushable coating used to apply to uncoated stonewool boards to reinstate the fire resistance performance of wall and floor constructions where apertures are penetrated by single or multiple services.

Code	Size	Colour
FSI/PSCOAT-5KG	5kg	White

FLEXICOAT



Flexi-Coat® is a highly advanced flexible penetration and aperture sealing system. Acts as a coating to be applied to stone/mineral wool backing material.

Code	Size	Colour
FSI/FLEXICOAT-10KG	10kg	White



ACCESS PANEL

Key Code

1

2

3

4

5

6

Panel Range

Fire Rating

Door Type

Frame Type

Lock Type

Special Attributes

1. Panel Range

From our FlipFix range to our standard EX ranges

FF

FlipFix Fitting Device
This panel is equipped with the FlipFix Fitting Device

01

Up To

51

EX Ranges
Each number represents one of our Access Panel Ranges

2. Fire Rating

Up to 3 hours fire rating, higher ratings available upon request

000

Non Fire Rated

060

1 Hour Fire Rated

120

2 Hour Fire Rated

180

3 Hour Fire Rated

3. Door Type

Multiple door types for all your needs

MD

Metal Door

PD

Plasterboard Door

TD

Tile Door

PL

Plastic Door

4. Frame Type

Our FlipFix range now comes with the Mitreless picture frame, for a better, cleaner look

BF

Beaded Frame
25mm Beaded Frame suitable for plastering in for a discrete finish

PF

Picture Frame
Picture Frame to rest on top of the plaster for a visible finish

5. Lock Type

Various lock types are available on request. May not be suitable for some panels

BL

Budget Lock

IP65

Key Retaining Lock

5B

5mm Bit

3W

3 Way Lock

STL

Slotted Lock

TC

Touch Catch

3WEP

3 Point Euro Cylindar Lock

CTL

Castellated Key Lock

SL

Tamper Proof Lock

TS

Turn Screw Lock

FL

Flush Bung

6. Special Attributes

These special attributes will sit on the end of the code icons in gray will have no effect on the code structure and are just for description purposes

AT

Airtight Rating
This panel is available with Airtight Rating

30A

Acoustic Rating
This panel is available with Acoustic Rating

CIR

Circular Panel
This panel is Circular

PR

Primed
Primed for on site decoration or used as a matt

PARTL

Part L Compliant
This panel is Part L Compliant

SMOKE

Smoke Insulation
This panel is insulated against Smoke

EZ

EziFit Hinge System
This panel comes with the EziFit Hinge System

INS

Thermas Insulation
Materials used to reduce the rate of heat transfer



This panel is designed to fit into a structural membrane of a joint-less plasterboard ceiling system. It is manufactured with a Beaded frame for tape and jointing / skim-coat plastering.

Exitile Access Panels are made to order. Please reference the Key Code below for specifications.



Reach out for a Quote



FIRE KEM FP-900



Kemwell PFP Corex A1 is a non-combustible gypsum board for applications where superior fire performance and innovative solutions are required, such as structural steel protection, shaft walls, etc.

Code	Size	Pallet Quantity
KEM/FK-09	9x2400x1200mm	65
KEM/FK-12	12x2400x1200mm	50
KEM/FK-15	15x2400x1200mm	40
KEM/FK-20	20x2400x1200mm	30
KEM/FK-25	25x2400x1200mm	25

WEATHERKEM

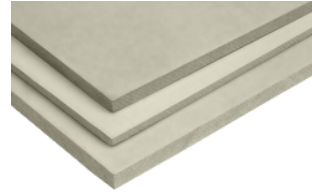

BBA certified WeatherKem is a non-combustible calcium silicate fibre cement board, combining weather, moisture and fire resistance properties with high impact strength and sound insulation.

Code	Size	Pallet Quantity
KEM/WK-06	6x2400x1200mm	100
KEM/WK-09	9x2400x1200mm	65
KEM/WK-12	12x2400x1200mm	48
KEM/WK-15	15x2400x1200mm	40
KEM/WK-18	18x2400x1200mm	33

A1 COREX BOARD

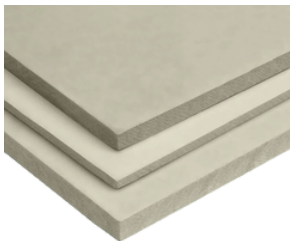

Kemwell Corex boards are clean and lightweight, non-combustible calcium silicate fire protection building boards. They has multi-purpose applications and is commonly used for commercial and industrial building projects.

Code	Size	Pallet Quantity
KEM/COREX-12.5	12.5x2000x1200mm	40
KEM/COREX-15	15x2000x1200mm	32
KEM/COREX-20	20x2000x1200mm	24
KEM/COREX-25	25x2000x1200mm	20

KEMFLOOR

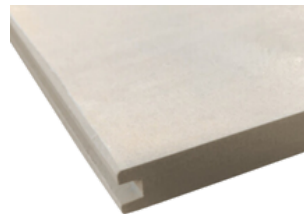

Kemwell KemFloor is an A1 fire-rated, non-combustible fibre cement flooring board. It combines moisture and fire resistance properties with high impact strength and sound insulation.

Code	Size	Pallet Quantity
KEM/FK-18	18x2400x1200mm	33



FIBRE CEMENT BOARD 20/20

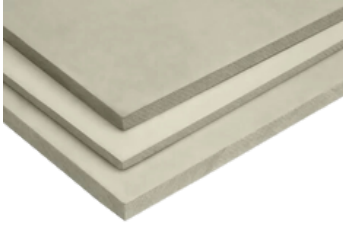

Fibre Cement Board 20/20 provides the stability and durability to suit a range of applications, whilst offering the necessary specification and budget within construction projects.

Code	Size	Pallet Quantity
RES/FCB-RBP-09	9X1200X2400mm	54
RES/FCB-RBP-12	12x1200x2400mm	42
RES/FCB-RBP-19 T&G	19x2400x600mm	54
RES/FCB-RBP-22 T&G	22x2400x600mm	46

MULTIPRO

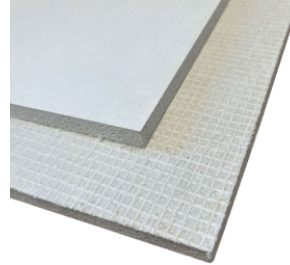

Multi-pro is a versatile passive fire protection board which will satisfy the needs of many type of projects. It is also very dimensionally stable and can be used in many forms of construction where plywood is currently used.

Code	Size	Pallet Quantity
RES/MULTIPRO6MM	6x1200x2400mm	58
RES/MULTIPRO9MM	9x1200x2400mm	58
RES/MULTIPRO12MM	12x1200x2400mm	58

BASE BOARD



Base Board is ideal as both a sheathing and budget render carrier board. The boards are also fire rated giving your building envelope added protection.

Code	Size	Pallet Quantity
RES/BB-10	10x2400x1200mm	58

Roofing

Resistant Building Products provide highly durable A1 Non-combustible building boards for use as both structural roofing decks and overlay components.

MAGNESIUM BOARDS



Magply provides an A1 Non-combustible solution to a variety of Roofing applications. Magply features a Magnesium Oxy-Sulphate formulation which is manufactured from a cold production process that ensures a very low chloride content, enhancing both stability and durability.

Code	Size	Pallet Quantity
BM/MAG-06	6x2400x1200mm	150
BM/MAG-09	9x2400x1200mm	100
BM/MAG-12	12x2400x1200mm	75

OSB BOARDS

OSB3



Oriented Strand Board is used in residential and commercial construction for sub-flooring, roof sheathing, exterior sheathing and other residential and commercial construction applications.

Code	Size	Pallet Quantity
DPV/OSB3-11	11x2440x1220mm	82
DVP/OSB3-18-1220	18x2440x1220mm	50

OSB T&G



SmartPly OSB Flooring board manufactured to OSB3 standard. Tongue and grooved on four sides to ensure a noise and squeak free floor TG4. Should fit most attic hatches.

Code	Size	Pallet Quantity
DPV/OSB3-18-1220-T&G	18x2440x1220mm	50
DPV/OSB3-18-590	18x2440x590mm	100
DPV/OSB3-22	22x2440x1220mm	34



C STUD

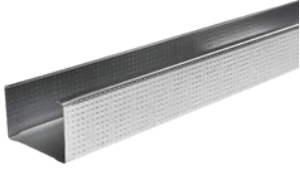

'C' Studs are used as the vertical support in wall framing. C studs provide the vertical support for walls, serving as the primary framework to which drywall or other wall materials are attached.

Code	Width	Length	Pack Quantity
U/M/CSTUD-050-2.7	50mm	2.7m	10
U/M/CSTUD-050-3.0	50mm	3.0m	10
U/M/CSTUD-050-3.6	50mm	3.6m	10
U/M/CSTUD-070-2.4	70mm	2.4m	10
U/M/CSTUD-070-2.7	70mm	2.7m	10
U/M/CSTUD-070-3.0	70mm	3.0m	10
U/M/CSTUD-070-3.6	70mm	3.6m	10
U/M/CSTUD-070-4.2	70mm	4.2m	10
U/M/CSTUD-070-4.5	70mm	4.5m	10
U/M/CSTUD-092-2.4	92mm	2.4m	10
U/M/CSTUD-092-2.7	92mm	2.7m	10
U/M/CSTUD-092-3.0	92mm	3.0m	10
U/M/CSTUD-092-3.6	92mm	3.6m	10
U/M/CSTUD-092-4.2	92mm	4.2m	10
U/M/CSTUD-146-3.0	146mm	3.0m	10
U/M/CSTUD-146-3.6	146mm	3.6m	10
U/M/CSTUD-146-4.2	146mm	4.2m	10
U/M/CSTUD-146-5.0	146mm	5.0m	10
U/M/CSTUD-146-6.0	146mm	6.0m	10



I STUD

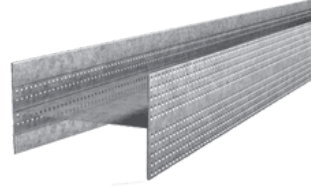

Gypframe 'I' Studs are the strongest available in the Gypframe range. They allow for increased partition height, without increasing partition width and provide improved impact resistance.

Code	Width	Length
U/M/ISTUD-050-2.7	50mm	2.7m
U/M/ISTUD-050-3.0	50mm	3.0m
U/M/ISTUD-060-3.6	60mm	3.6m
U/M/ISTUD-060-4.2	60mm	4.2m
U/M/ISTUD-070-3.6	70mm	3.6m

RESILIENT BAR



A resilient bar is a specialized metal strip used in wall and ceiling framing to improve soundproofing by reducing the transmission of noise.

Code	Length
U/M/RB-3.0	3.0m

COMPRESSION SLEEVE

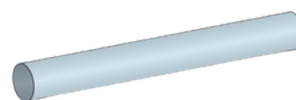

Compression Sleeves are used in residential and commercial construction for sub-flooring, roof sheathing, exterior sheathing and other residential and commercial construction applications.

Code	Size
ANC/COMPSL-120	120mm

U TRACK

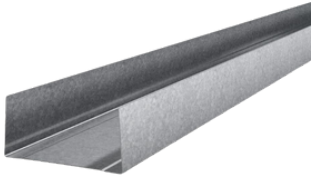

Superior Sections U Tracks provide a framework for partitions and wall linings designed for use with Superior Sections Metal C Stud Partitions.

Code	Width	Length	Pack Quantity
U/M/UTRACK-52-3.0	52mm	3.0m	10
U/M/UTRACK-72-3.0	72mm	3.0m	10
U/M/UTRACK-94-3.0	94mm	3.0m	10
U/M/UTRACK-148-3.0	148mm	3.0m	10

EXTRA DEEP U TRACK

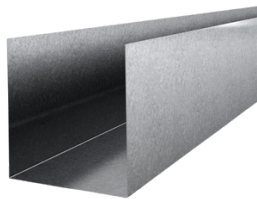

Extra Deep U Track is for fixing wall studs at the floor or ceiling. Extra deep U track is used for partitions greater than 4.2m in height, or where easier skirting fixing or greater impact resistance is required.

Code	Width	Length	Pack Quantity
U/M/UTRACK-ED-052-3.0	52mm	3.0m	10
U/M/UTRACK-ED-072-3.0	72mm	3.0m	10
U/M/UTRACK-ED-094-3.0	94mm	3.0m	10

MF5

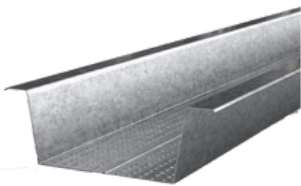

Made from galvanised steel, the Superior Sections Ceiling Channel is designed for use alongside the Superior Sections Perimeter Channel and Superior Sections Primary Channel.

Code	Length
U/M/MF5-3.0	3.0m
U/M/MF5-3.6	3.6m

DEEP U TRACK

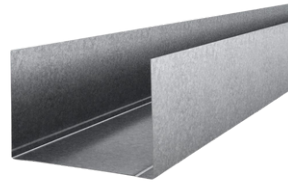

Metal stud partitioning is ideal for use in domestic and commercial situations, for heights up to 12m, depending on structure. A wide range of partition thickness are available to order.

Code	Width	Length	Pack Quantity
U/M/UTRACK-D-052-3.0	52mm	3.0m	10
U/M/UTRACK-D-072-3.0	72mm	3.0m	10
U/M/UTRACK-D-94-3.0	94mm	3.0m	10

SUSPENSION ANGLE

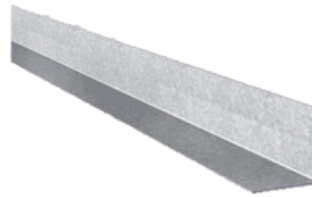

Suspension Angle is suitable for most internal dry lining applications. With a simple steel framework, a new ceiling or an upgrade to an existing structure can be quickly erected to provide a quality ceiling.

Code	Size
U/M/ANGLE-25-3.0	25x25x3000mm
U/M/ANGLE-25-3.6	25x25x3600mm
U/M/ANGLE-50-3.6	25x50x3600mm

MF6A



Made from galvanised steel, the Superior Sections Perimeter Channel is designed for use as the perimeter support for the Superior Sections Suspended MF Ceiling System.

Code	Length
U/M/MF6A-3.6	3.6m

MF7



Made from galvanised steel, the Superior Sections Primary Channel is designed for use with the Superior Sections Perimeter Channel and Superior Sections Ceiling Channel

Code	Length
U/M/MF7-3.6	3.6m

MF9



MF9 Metal Furring Clips are used in the construction of the MF metal ceiling system and connect the MF5 Ceiling Furring Channel to the MF7 Primary Channel.

Code	Pack Quantity
U/M/MF9	200

MF10



The MF10 channel is designed to aid the installation of plasterboard linings directly on masonry walls. Allows for the direct fix of plasterboard to masonry walls.

Code	Length
U/M/MF10-2.8	2.8m

BRICK TIE CHANNEL



The Brick Tie Channel has been designed to tie masonry to steelwork. Once the channel is installed, Brick Ties can be positioned at any point along its length and are built into the bed joints of the outer leaf of masonry.

Code	Size
U/M/SS-BTC	25x14x2700mm

GL1 WALL LINER STUD



GL1 Lining Channels/Studs are the metal stud partitions used to construct the universal stud wall system. They are compatible with plasterboard linings, meaning specific levels of acoustic and thermal insulation can be achieved.

Code	Width	Length
U/M/LS-2.7	45x18mm	2.7m
U/M/LS-3.0	45x18mm	3.0m
U/M/LS-3.6	45x18mm	3.6m
U/M/LS-4.4	45x18mm	4.4m

LINER TRACK



Made from galvanised steel, the Superior Sections Wall Liner Channel is designed for use alongside the Superior Sections Wall Liner Track, providing a reliable framework for partitions and wall linings.

Code	Length
U/M/LT-3.0	3.0m

LEG LINER BRACKET



Long Leg Metal Liner Brackets are used in the construction of stud walls and attach the GL1 Liner Stud to brick or ceiling.

Code	Length	Pack Quantity
U/M/DSS2	195mm	100
U/M/DSS9	295mm	100

FLAT STRAP



These high performance internal framing profiles are fully compatible with all makes of plaster board and ensure quick and reliable installation.

Code	Width	Length
U/M/FLAT-70	70mm	2.4m

LINER CONNECTOR



Liner Connector is designed to ease the plasterboard lining installation process into timber joists, concrete soffits, masonry walls, as well as for steel beams and columns encasement.

Code	Pack Quantity
U/M/LC	100

MAIN RUNNER



The Main Runner, often referred to as the Main Tee Bar or Primary Channel, is a typically 3.6m length of 'T' shape grid which forms the primary support for the suspended ceiling.

Code	Length	Pack Quantity
U/M/G/MAIN-RUN	24x33x600mm	20

CROSS TEE



The Cross Tee is the interlocking section of grid which fixes between the main tee sections. It fixes directly into pre-punched holes within the main tee bar.

Code	Width	Length	Pack Quantity
U/M/G/CTEE-600	24x33	600mm	60
U/M/G/CTEE-1200	24x33	1200mm	60

PERIMETER TRIM



Superior Sections Perimeter Channels are made of galvanised steel and are designed to support the Superior Sections Suspended MF Ceiling System.

Code	Length	Box Quantity
U/M/G/PTRIM	29x19x3000mm	25

C STUD



Galvanised lightweight steel section for use in non-load bearing Knauf partition systems. These partition studs can be used to achieve a wide range of performance criteria.

Code	Width	Length
KD/M/CSTUD-050-2.4	50mm	2.4m
KD/M/CSTUD-050-2.7	50mm	2.7m
KD/M/CSTUD-050-3.0	50mm	3.0m
KD/M/CSTUD-050-3.6	50mm	3.6m
KD/C/CSTUD-060-3.0	60mm	3.0m
KD/M/CSTUD-070-2.4	70mm	2.4m
KD/M/CSTUD-070-2.7	70mm	2.7m
KD/M/CSTUD-070-3.0	70mm	3.0m
KD/M/CSTUD-070-3.6	70mm	3.6m
KD/M/CSTUD-070-4.2	70mm	4.2m
KD/M/CSTUD-092-3.6	92mm	3.6m
KD/M/CSTUD-092-4.2	92mm	4.2m
KD/M/CSTUD-148-2.7	148mm	2.7m
KD/M/CSTUD-148-3.0	148mm	3.0m
KD/M/CSTUD-148-3.6	148mm	3.6m
KD/M/CSTUD-148-4.2	148mm	4.2m

DEEP U CHANNEL

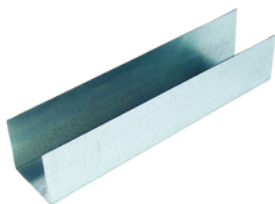

U Channel is a galvanised steel section for use as a head track where increased deflection is expected. All Knauf Deflection Head details will require 70mm Deep Flange U Channel

Code	Width	Length
KD/M/UTRACK-D-052-3.0	52x50mm	3.0m
KD/M/UTRACK-D-072-3.0	72x50mm	3.0m

I STUD



Knauf I Stud is a galvanised lightweight steel sections for use in non-load-bearing Knauf partition and wall lining systems allowing increased partition heights to be designed.

Code	Width	Length
KD/M/ISTUD-050-2.7	50mm	2.7m
KD/M/ISTUD-050.3.0	50mm	3.0m
KD/M/ISTUD-060-3.6	60mm	3.6m
KD/M/ISTUD-060-4.2	60mm	4.2m
KD/M/ISTUD-070-3.6	70mm	3.6m
KD/M/ISTUD-070-4.2	70mm	4.2m

U CHANNEL



U Channel's are galvanised steel sections for use as the standard head and floor track for Knauf partitions and wall linings.

Code	Width	Length
KD/M/UTRACK-052-3.0	52x25mm	3.0m
KD/M/UTRACK-062-3.0	62x25mm	3.0m
KD/M/UTRACK-072-3.0	72x25mm	3.0m
KD/M/UTRACK-094-3.0	94x25mm	3.0m
KD/M/UTRACK-148-3.0	148x25mm	3.0m

EXTRA DEEP U CHANNEL



Knauf Deep Flange U Channels are a galvanised steel section for use as an optional head track where increased deflection is expected.

Code	Width	Length
KD/M/UTRACK-ED-052-3.0	52x70mm	3.0m
KD/M/UTRACK-ED-62-3.0	62x70mm	3.0m
KD/M/UTRACK-ED-72-3.0	72x70mm	3.0m
KD/M/UTRACK-ED-94-3.0	94x70mm	3.0m
KD/M/UTRACK-ED-148-3.0	148x70mm	3.0m

J CHANNEL



Knauf J Channels are a high quality galvanised steel section, used as head and floor track and perimeter framing section of the Knauf Shaftwall System.

Code	Width	Length
KD/M/JCHAN-62-3.0	62mm	3.0m
KD/M/JCHAN-62-4.5	62mm	4.5m
KD/M/JCHAN-94-4.5	94mm	4.5m
KD/M/JCHAN-94-5.5	94mm	5.5m
KD/M/JCHAN-148-5.5	148mm	5.5m
KD/M/JCHAN-148-6.5	148mm	6.5m

C CHANNEL



Knauf C Channels are galvanised lightweight steel sections for use in Knauf wall lining systems and Knauf Soffit lining systems.

Code	Length
KD/M/CCHAN-2.4	2.4m
KD/M/CCHAN-2.7	2.7m
KD/M/CCHAN-3.0	3.0m
KD/M/CCHAN-4.0	4.0m

RB1 RESILIENT BAR

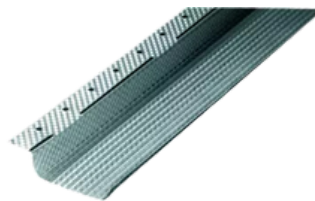

RB1 Resilient Bars are designed to provide maximum material separation, optimising sound insulation performance in Gyproc wall and ceiling systems.

Code	Length
KD/M/RB-3.0	3.0m

U CHANNEL PERIMETER SUPPORT



Knauf U Channel Perimeter Support are galvanised steel sections for use as standard head and floor track for Knauf Wall Liner system.

Code	Length
KD/M/UTRACK-PS-3.0	3.0m

UNIVERSAL BRACKET



The Knauf Universal Bracket is fixed to the background structure and the Knauf 'C' Channel as part of the Knauf Wall Liner system.

Code	Pack Quantity
KD/M/UB	100

MF5



Galvanised steel main channel section for the Knauf MF ceiling channel system to which the Knauf plasterboard is fixed.

Code	Length
KD/M/MF5-3.6	3.6m

MF6



MF6 Perimeter Channel is a rigidised channel, using UltraSTEEL® technology, that supports Gypframe MF ceiling sections at perimeters, establishing the ceiling level.

Code	Length
KD/M/MF6-3.6	3.6m

MF7



Galvanised steel section to be used as the main cross-section and hanger support section of the Knauf MF Ceiling system.

Code	Length
KD/M/MF7-3.6	3.6m



KNAUF ANGLE



Knauf Angle Sections are galvanised mild steel angles for use with partitions, column and beam encasements and suspended ceilings.

Code	Width	Length
KD/M/ANGLE-25-3.0	25x25mm	3.0m

FLAT FIXING PLATE



Knauf Flat Fixing Plate is a lightweight galvanised steel fixing plate for use within partitions, wall linings and ceilings.

Code	Length
KD/M/FLATPLATE-2.4	2400mm

BONDING COMPOUND



Knauf bonding compound plasterboard adhesive should be used with Knauf metal furring channel and for direct bonding of Knauf plasterboards and insulating laminates.

Code	Size	Pallet Quantity
KD/PB/BOND	25kg	60



Competitor Alternatives

Product	Attributes	Competitor Alternatives
TVS Cleancare	<ul style="list-style-type: none"> No Absorption Class 37dB Attenuation 90% Moisture Resistance 	<ul style="list-style-type: none"> British Gypsum Satinspar Knauf Danotile CEP Cleancare/Toughcheck
TVS Mineral	<ul style="list-style-type: none"> Class C Absorption 35dB Attenuation 99% Moisture Resistance 89% Light Resistance White similar to RAL9016 	<ul style="list-style-type: none"> Zentia/Dune/Dune Evo AMF Fein Stratos Sektor Sahara Perforated
TVS Soft	<ul style="list-style-type: none"> Class A Absorption 25dB Attenuation 100% Moisture Resistance 88% Light Reflectance 	<ul style="list-style-type: none"> Ecophon Focus/Gedina Rockfon Artic/Sonar CEP Sequence AMF Topiq Zentia Sierra OP/Perla OP
TVS Soft dB	<ul style="list-style-type: none"> Class A Absorption 46dB Attenuation 100% Moisture Resistance 88% Light Reflectance 	<ul style="list-style-type: none"> Ecophon Combison Rockfon Sonar dB
TVS Healthcare	<ul style="list-style-type: none"> Class A Absorption 25dB Attenuation Anti-Bacterial Coating 100% Moisture Resistance 88% Light Reflectance 	<ul style="list-style-type: none"> Ecophon Hygiene Rockfon Medicare Zentia Bioguard AMF Laguna/Thermatex Alpha
TVS ABSorb	<ul style="list-style-type: none"> Class A Absorption Fabric Wrapped in Camira Cara Lucia 	<ul style="list-style-type: none"> Ecophon Solo Rockfon Sonar Soundsorba Soundhush CEP Sequence
TVS Care	<ul style="list-style-type: none"> Class A Absorption Fabric Wrapped in Camira Cara Lucia 	<ul style="list-style-type: none"> Autex Soundsorba Soundhush
TVS Metal	<ul style="list-style-type: none"> Perforated or Plain Class A or C Absorption RAL Coloured or Wood Effect Finish 	<ul style="list-style-type: none"> SAS Hunter Douglas Zentia/Armstrong AMF OWA

Metal Tiles

Competitor Product	System	TVS Group Equivalent
SAS120	Clip-in	Clip-in
SAS130	Lay-in	Lay-in
SAS150	Clip-in	Clip-in Swing Down
SAS200	Hook-on	Hook-on
SAS205	Hook-on for corridors	Hook-on for corridors
SAS320	Lay-in	Lay-on
SAS330	Lay-in	Bandraster
SAS500	Baffle	Spiked Baffle
SAS510	Waveform Baffle	Wave Baffle
SAS600	Ceiling Rafts	*Special Production / Not Standard
SAS700	Linear	Spiked Baffle
SAS710	Linear	Spiked Baffle
SAS720	Linear	Multipanel
SAS730	Linear	Extruded Baffle
SAS740	Linear	Extruded Baffle
SAS750	Tubeline	Tube
SAS800	Open Cell	Open Cell
SAS810	Open Cell	Triangular Open Cell
MESH	Mesh	Mesh

U Value Insulation now supplies Cipriani Tile & Grid products.

For any enquiries or technical information please reach out to one of our sales representatives.

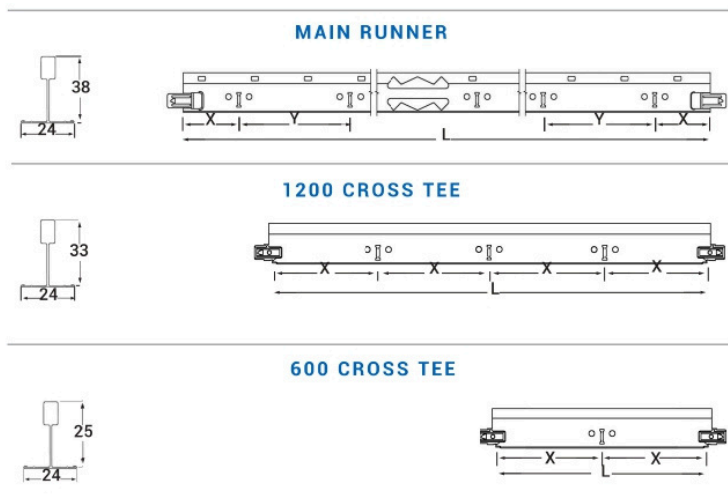
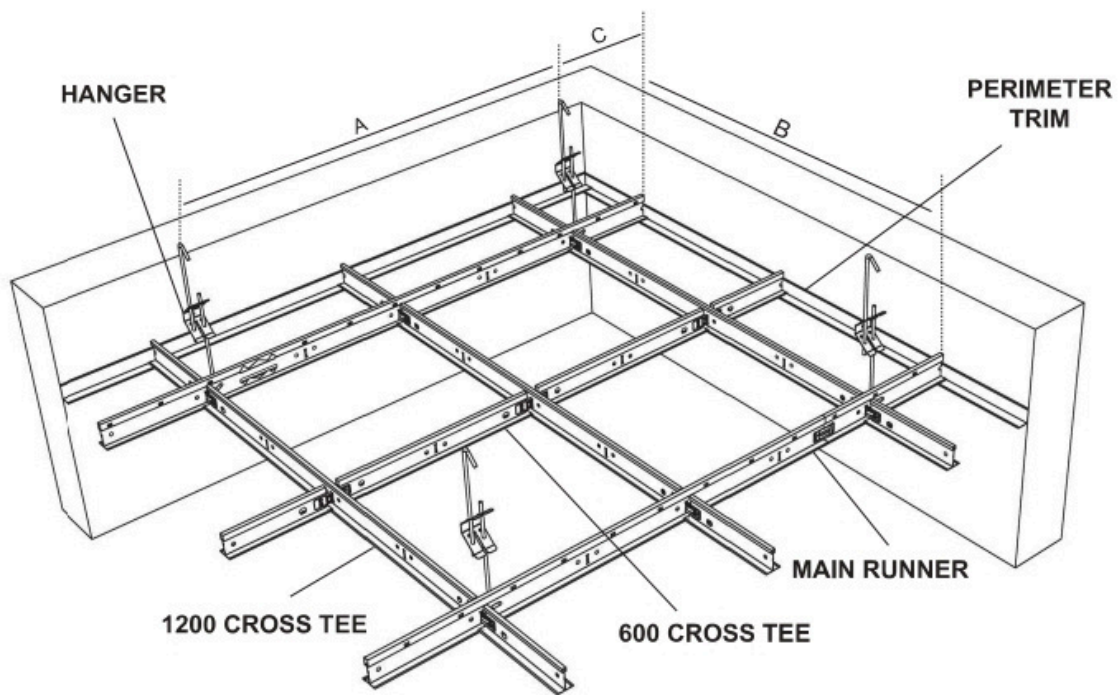

FLASHING TAPE



Butyband is a butyl rubber, ready to use, self-adhesive, elastoplastic flashing and sealing tape. Excellent adhesion onto all surfaces when applied at low temperatures.

Code	Sizes
SEAL/BUTYBAND-75	75mm
SEAL/BUTYBAND-100	100mm
SEAL/BUTYBAND-150	150mm
SEAL/BUTYBAND-225	225mm
SEAL/BUTYBAND-300	300mm

GAP FILLER EXPANDING FOAM



General all purpose filling of holes, gaps and joints. Adheres to all common building materials, resistant to water, heat and ageing. Can be cut, sanded, plastered and painted after full cure.

Code	Sizes	Type
SEAL/GENIUS	600ml	Genius

EXPANDING FOAM



Moisture curing, self-expanding polyurethane foam for all general purpose gap filling. Adheres to all common building materials, resistant to water, heat and ageing.

Code	Sizes	Type
SEAL/GRAB	750ml	Gun Grade

GENERAL PURPOSE FILLER



Soudal Gap Filler Expanding Foam is a hand held PU foam with patented "Genius Gun" application system. The Genius Gun applicator enables high precision, single handed use. Re-useable for up to 6 weeks.

Code	Sizes	Type
SEAL/GAPFILLER-HAND	500ml	Genius

GAP FOAM



Adheres to most common building materials, resistant to water, heat and ageing. Excellent thermal and acoustic insulation values.

Code	Sizes	Type
SEAL/GG-GAP	750ml	Genius

SWS SOUDAFOAM



Airtight premium quality polyurethane expanding foam filler for use around windows & doors. Recommended for all A, A+ and A++ windows & doors. Vastly improved thermal and insulation properties.

Code	Sizes	Type
SEAL/FLEXI	750ml	Gun Grade

EXPANDING FOAM



Soudal Expanding Foam is a rapid curing product with excellent thermal and acoustic properties; as well as primerless adhesion on most construction materials.

Code	Sizes	Type
SEAL/HHFOAM	750ml	Handheld
SEAL/HHFOAMB2	750ml	Handheld

PLASTERBOARD ADHESIVE



FAST CURING PU plasterboard adhesive that replaces the need for traditional mortar based adhesives; this means no mixing required, avoiding any unnecessary mess.

Code	Sizes	Type
SEAL/PGENIUS	600ml	Genius Gun

SOUDABOND ADHESIVE



Soudabond Adhesive is a high performance polyurethane adhesive foam that is quick and easy to use, with no mixing required.

Code	Sizes	Type
SEAL/SOUDABOND	500ml	Spray
SEAL/SOUDABOND-GUN	700ml	Gun Grade
SEAL/SOUDABOND-HAND	700ml	Handheld

GAP FILLER COMBI-BOX



GAP FILLER EXPANDING FOAM Multi-Pack. Contains 6 units of Trade Gap Filler Expanding Foam Gun Grade 750ml and the tools to apply and clean after use.

Code	Sizes	Box Quantity
SEAL/COMBI-BOX	750ml	6

SOUDABOND EASY



Soudabond EASY is a high performance polyurethane adhesive foam that replaces traditional powder based adhesives, with strong adhesion characteristics.

Code	Sizes	Type
SEAL/EASY	750ml	Handheld
SEAL/EASY-GUN	750ml	Gun Grade

SWS APPLICATOR PACK



This Soudafam Window & Door SWS Airtight Foam Kit contains 5 x Soudafam SWS Flexifoam, 1 x PU Foam Applicator Gun, and 1 x Soudafam Cleaner for hassle-free installation.

Code	Sizes	Box Quantity
SEAL/SWSAIR-KIT	750ml	7

INSULATION FOAM



Specially formulated moisture curing polyurethane insulation foam, for applications with high and repetitive movement, or where vibration resistance is required.

Code	Sizes	Type
SEAL/SPRAYINSU-GENIUS	700ml	Genius Gun
SEAL/SPRAYINSU-GUN	700ml	Gun Grade

FIRE & ACOUSTIC FILL/FIX



Rapid curing. Excellent thermal and acoustic insulation properties. Excellent primerless adhesion on most construction materials.

Code	Sizes	Type
SEAL/FIREB1-GUN	750ml	Gun Grade
SEAL/FIREB1-HAND	750ml	Hand Held

SEAL FIX ALL



Soudal Fix All is a range of multi-functional sealant and adhesive products that are suitable for all your bonding and sealing needs.

Code	Sizes	Colour
SEAL/FIXALL-CRYSTAL-DUO	290ml	Clear
SEAL/FIXALL-FLEX-DUO	290ml	White
SEAL/FIXALL-FLEXI	290ml	White
SEAL/FIXALL/FLEXI-CRY	290ml	Clear
SEAL/FIXALL-FLEXI-BLK	290ml	Black
SEAL/FIXALL-HIGHTACK-BLK	290ml	Black
SEAL/FIXALL-HIGHTACK-INV	290ml	Clear
SEAL/FIXALL-HIGHTACK-WHT	290ml	White
SEAL/FIXALL-TURBO	290ml	White
SEAL/FIXALL-WHITE	290ml	White

GUN CLEANER



Solvent based aerosol cleaner for the removal of fresh PU Foam stains and for the maintenance of the regular Foam Gun with threaded adaptor.

Code	Sizes	Type
SEAL/CLEANER	500ml	Gun Grade
SEAL/GUNCLEANER	500ml	Spray

SOLVENT ADHESIVE



SOLVENT BASED, high performance, fast curing, gap filling grab adhesive. The high strength construction adhesive has good initial grab in both vertical and horizontal positions. Fast drying.

Code	Sizes	Colour
SEAL/GRAB	290ml	Beige

SOLVENT FREE ADHESIVE



SOLVENT FREE, high performance, fast curing, gap filling grab adhesive. The high strength construction adhesive has good initial grab in both vertical and horizontal positions.

Code	Sizes	Colour
SEAL/BRAB-FREE	290ml	White

SILICONE SEALANT



Acetoxy silicone sealant that cures to form a flexible, durable weathertight seal on many common building surfaces, including glass, metal, wood and ceramic tiles.

Code	Sizes	Colour
SEAL/MULTISIL-BLK	270ml	Black
SEAL/MULTISIL-CLEAR	270ml	Clear
SEAL/MULTISIL-WHITE	270ml	White

FIRE SILICONE B1 FR



Highly elastic fire rated neutral cure silicone sealant with a fire rating of up to 4 hours in certain joint configurations according to EN 1366 Part 4.

Code	Sizes	Fire Rating
SEAL/FIRESIL-B1	310ml	4 Hr

INSTANT SEAL ADHESIVE



Trade All Weather Sealant is a solvent based waterproof sealant that adheres to all types of surfaces, even grassy and bituminous, even when immersed in water.

Code	Sizes	Colour
SEAL/ALLWEATHER-CLEAR	290ml	Clear
SEAL/ALLWEATHER-WHITE	290ml	White

FIRECRYL FR



FIRE RATED intumescent acrylic sealant and filler. Totally solvent, silicone and isocyanate free. Colourfast and waterproof after curing. Can be painted over after curing. Odourless.

Code	Sizes	Fire Rating
SEAL/FIRESEAL-CRY	310ml	4 Hr

ASTROFLAME MASTIC



A water based acrylic sealant used to reinstate the fire resistance of wall and floor constructions in linear joints and where apertures are penetrated by multiple services.

Code	Sizes	Colour
SEAL/ASTRO	310ml	White

SOUDASEAL FR



FIRE RATED non-staining, SMX® polymer, sealant and adhesive for use in passive fire protection systems. Totally solvent, silicone and isocyanate free. Highly elastic. Paintable. Odourless.

Code	Sizes	Type
SEAL/SOUDASEAL-FR	600ml	Grey

SOUDATIGHT LQ



Soudatight LQ is a high-quality fibre reinforced polymer membrane which forms an air and vapour tight elastic membrane after drying. Can be quickly and easily applied with a brush on almost any mineral substrate

Code	Sizes	Type
SEAL/ST-LQ	4.5kg	Black

CLEANING FOAM SPRAY



A universal cleaning foam spray. Foam action helps to break down dirt and contaminants. Does not drip. 400ml aerosol can.

Code	Sizes	Base
SEAL/MULTICLEAN	400ml	Water

SUPER CLEANING WIPES



Heavy duty cleaning wipes for removal of sealant stains and other dirt from surfaces, tools and hands.

Code	Quantity
SEAL/WIPE	300



BLACK SEALANT



Tec7 is an instantly waterproof adhesive that also bonds, mounts and seals even under water. It is a solvent free, food grade safe and practically odourless adhesive meaning it can be used throughout the house without causing harm

Code	Sizes	Colour
TEC7/BLACK-7535106	310ml	Black
TEC7/WHITE-7535206	310ml	White
TEC7/CEALR-535506	310ml	Clear

XTACK WHITE



X-Tack is a super-strong and satable adhesive with thickness of up to 40mm. It is permanently elastic and free of phthalates, solvents, and isocyanates. Water and airtight. Can be used on most building materials.

Code	Sizes	Colour
TEC7/XTACK-WHITE	290ml	White

FOAMTACK PRO



All season PU adhesive foam with very low post-expansion for indoor and outdoor use, from -5°C to +30°C. The first choice for all assembly and bonding work where speed, strength and insulating capacity are important qualities.

Code	Sizes	Base
TEC7/FOAMTACK-PRO	750ml	Polyurethane

GT7 WITH COBRA NOZZLE



Gt7 repels moisture super fast due to its extremely low surface tension and strong penetrating properties. An ideal lubricant for fine mechanical and electrical components.

Code	Sizes	Colour
TEC7/GT4-COBRA	400ml	Clear

X SEAL FLEXIBLE SEALANT



Extremely flexible sealant based on MS hybrid polymer that replaces all other sealants. It's easy to apply and perfectly repaintable. Superior adhesion combined with permanent elasticity makes for durable joints.

Code	Sizes	Finish
TEC7/XSEAL-FLEXIBLE	310ml	Satin

PROFESSIONAL CAULK



Tec7 Caulk is a professional acrylic mastic used to seal and fill all construction materials. The formulation ensures a perfect finish with types of paint, wood stains and varnishes without blistering or discolouration.

Code	Sizes	Base
TEC7/CAULK	310ml	Acrylic

ROOF WATERPROOF



Roof Waterproof is a ready for use and easy to apply bitumen and glass fibre-based roof repair product that can be applied to both wet and dry surfaces. Also suitable for vertical applications.

Code	Sizes	Colour
TEC7/WP7-ROOF-310	4.4lt	Black
TEC7/WP7-ROOF-4	870ml	Black
TEC7/WP7-ROOF-8	8.7lt	Black
TEC7/WP7-ROOF-870	870ml	Black

MULTI CLEAN



Multi Clean is free from abrasives and has a pleasant smell. This is ideal for cleaning and degreasing most substrates in preparation for the application of adhesive, paint or varnish.

Code	Sizes	Type
TEC7/MULTI-CLEAN	500ml	Spray

CLEANER



Tec7 Cleaner is a general cleaner and degreaser suitable for finishing sealing beads of uncured Tec7 along with the removal of uncured Tec7 from most surfaces including clothes and fabrics.

Code	Sizes	Colour
TEC7/CLEANER	500ml	Colourless

HAND CLEANER



Hand Cleaner soap quickly removes the most stubborn dirt without irritating the skin. The soft natural granules provide pore-deep action with respect for the skin.

Code	Sizes	Form
TEC7/HAND-CLEANER	3.8L	Gel

Roof rafter insulation

WARMLINE INSULATED PLASTERBOARDS

Plasterboard

Tank Jackets

Acoustic insulation

Metal Stud & Track

JOINT FILLER

Floor Insulation

Stop Beads

Screws

Loft Ladders

Airtight Membrane

Joint Filler

BREATHABLE ROOF MEMBRANES

Mushroom Fixings

WALL TIES

Access Panels

SURFACE PROTECTOR



Roll & Stroll Surface Protectors are the ultimate self adhesive protection that works on a multitude of surfaces, protects against spillage and won't tear or rip.

Code	Size	Surface Type
EVER/ROLL20	25mx600mm	Carpet
EVER/ROLLGLASS25	25mx600mm	Glass
EVER/ROLLHARD20	25mx600mm	Hard

PINKGRIP



Pinkgrip's amazing grabbing strength not only removes the need to pin under the workpiece to prevent slumping, but its revolutionary initial 'Direct Bond' eliminates the need for double stick methods.

Code	Size	Pack Quantity
EVER/PGDF	750ml	12
EVER/PINK	350ml	12

1 HOUR CAULK



Everflex Contract 125 One Hour Caulk is a fast-drying flexible decorators' filler and sealant that remains permanently flexible. Can be overpainted with most paint types or covered over with wallpaper.

Code	Size	Colour
EVER/125C3	300ml	White

THERMOFOAM



Thermofoam is a specially formulated, highly flexible PU, gun applied foam that absorbs component movement thereby giving an air tight seal to reduce heat loss and improve energy efficiency in buildings.

Code	Size	Pack Quantity
EVER/EVTHERM7	750ml	12

FIREFOAM



Firefoam B2 Gungrade is a quick setting fire rated, one-part polyurethane foam designed for application by any standard foam applicator gun.

Code	Size	Grade
EVER/B2FIREGUN	750ml	Gun
EVER/B2FIREHAND	750ml	Hand



SCRIM TAPE



EuroScrim® is a fibreglass re-reinforced plasterers tape on a roll which is backed with a pressure sensitive adhesive.

Code	Size
EVER/SCRIM050	50mmx90m
EVER/SCRIM100	100mmx90m

WONDER WIPES



Specially formulated to clean hands, tools and surfaces from wet and semi-cured paint, sealant, adhesive, bitumen, expanding foam, oil, grease and even silicone.

Code	Quantity
EVER/WIPE80	100

FEBOND BLUE GRIT



Febond Blue Grit is a high-performance plasterers grip coat bonding agent specifically designed to provide an improved key to smooth surfaces. Containing a finOne coat application, coloured blue to indicate coverage.

Code	Size	Coverage
EVER/BLUE-GRIT	10L	45m ²

CONTACT ADHESIVE



Stick 2 Contact Adhesives can be used with a variety of materials. Providing exceptional bond strength, our contact adhesives have been designed with long-lasting results in mind.

Code	Coverage
EVER/CONSPRAY5	500ml

Questions?

Reach out to our team for technical advice!



United Kingdom



Ireland

MISCELLANEOUS PRODUCTS

KNAUF JOINT FILLER



Knauf Joint Filler Premium is a fast-setting gypsum compound for bedding tapes and beads by hand application.

Code	Size	Pallet Quantity
KD/J/JOINTFILLER	20kg	42
KD/J/JOINTFILLER-PREM	10kg	100

KNAUF FILL & FINISH



Knauf Fill & Finish is a lightweight ready-mixed compound for bedding tapes and finishing joints in drywall partitions and ceilings.

Code	Size	Pallet Quantity
KD/J/SROCK-BLUE-05	5kg	72
KD/J/SROCK-BLUE-20	20kg	33

GYPROC SKIMCOAT



Gyproc Skimcoat is a versatile finish plaster for use on common backgrounds including gypsum undercoat plasters and plasterboard.

Code	Size	Pallet Quantity
GYP/PFSKIM-25KG	25kg	63

THISTLE BONDING PLASTER



Thistle BondingCoat is a backing plaster for plasterers working on smooth or low suction backgrounds.

Code	Size	Pallet Quantity
BG/BOND	25kg	56

THISTLE MULTI-FINISH



Thistle MultiFinish is a versatile finishing plaster providing a smooth finish on common plaster and plasterboard backgrounds.

Code	Size	Pallet Quantity
BG/MULTI	25kg	56

EASY COAT



EasyCoat Lightweight Joint Compound is more flexible and easier than other joint compounds for embedding joint tape and for filling and finishing gypsum panel joints, corner bead, trim and fasteners.

Code	Size	Pallet Quantity
EASY/BLUE-LW	17lt	42

MISCELLANEOUS PRODUCTS

CORNER TAPE



Gyproc Metal Corner Tape is a high quality paper joint tape strengthened with two corrosion-resistant galvanized steel strips for the finishing of internal and external angles in drywall construction.

Code	Size
GYP/A/TAPE-C	33 metres

POLYETHYLENE PIPE



Polyethylene pipes offer durable and flexible solutions for a wide range of applications. It is resistant to corrosion in all ground conditions and its flexibility allows it to withstand ground movements.

Code	Size	Pallet Quantity
AP/TUB15X19	15x19x2000mm	67
AP/TUB22X19	22x19x2000mm	54
AP/TUB28X19	28x19x2000mm	48

ATTIC COVER TENT



Attic Cover Tent helps your cooling and heating system run more efficiently—and in turn saves you money—because the attic tent is designed to insulate the attic access point.

Code	Size
REP/COVER	1500x600x600mm

TANK JACKET W/ LID



Tank Jackets with Lids prevent expansion tanks and cold water tanks from freezing, bacteria growth and dust entering tank.

Code	Size
AP/TANK1	18x12x12in
AP/TANK4	48x24x24in

GYPROC CORNICE



Gyproc decorative accessories are used to enhance walls and ceilings, and to relieve flat runs of lining, joints and angles.

Code	Size	Shape
GYP/A/COVE-127	127x3000mm	'C'
GYP/A/COVE-135	135x3000mm	'S'

GAUGE POLYTHENE



Gauge Polythene is used for damp-proof membranes, vapor barriers, temporary protective coverings, or insulation, among other uses.

Code	Gauge	Coverage
FI/POLY-BLACK	500	53m ²
FI/POLY2	1000	52.5m ²
FI/POLY1.2	1200	52.5m ²

MISCELLANEOUS PRODUCTS

DUCT TAPE



Duct tape is a strong, durable adhesive tape made of a fabric mesh backing coated with polyethylene and a rubber-based adhesive.

Code	Width	Length
SIGN/DUCT	50mm	50m

KLASSE FOIL TAPE

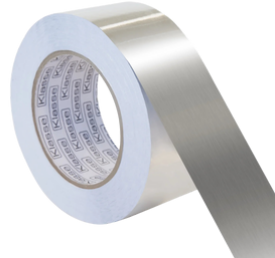

KlasseFOIL Tape has a high tensile strength aluminium foil backing, combined with a cold weather acrylic sensitive adhesive and is protected by an easy-release silicone release paper.

Code	Size
SIGN/FOIL050	50x45000mm
SIGN/FOIL075	75x45000mm
SIGN/FOIL100	100x45000mm

JOINT PAPER TAPE



Knauf Paper Joint Tape is white cellulose paper joint tape for reinforcing joints on walls and ceilings by hand or machine application, to create the strongest joints.

Code	Size
KD/J/TAPE-JP	150x51mm

FLEX METAL TAPE



Knauf Flexible Metal Tape allows you to create corners to any angle, even on irregular shaped structures such as cathedral or drop ceilings, or bay windows, and a variety of other applications.

Code	Size
KD/J/TAPE-CM	52x30.4mm

OUR BRANCHES

Republic of Ireland

Western

Unit 510 Beech Road,
Western Industrial
Estate, Dublin
D12 NT25

Ballycoolin

Unit 505B Mitchelstown
Road, Northwest Business
Park, Ballycoolin, Dublin
D15 X032

United Kingdom

Uxbridge

24 Uxbridge Tradepark,
Cowley Mill Road,
London UB8 2DB

Manchester

Gtr, Unit 3, Broadfield
Business Centre Off
Pilsworth Road,
Heywood, Manchester,
OL10 2TA

Birmingham

Unit 800 Catesby Park,
Kings Norton,
Birmingham B38 8SE



CONTACT US



+44 121 790 1023

sales@uvalueinsulations.co.uk

+353 1 861 2000

sales@uvalue.ie